

This drawing should not be relied on or used in circumstances other than those for which it was originally prepared and for which Mott MacDonald Sweco JV was commissioned. This drawing has been prepared for the titled project or named part thereof and should not be relied upon or used for any other project without an independent check being carried out as to its suitability and prior written authority of Mott MacDonald Sweco JV being obtained.

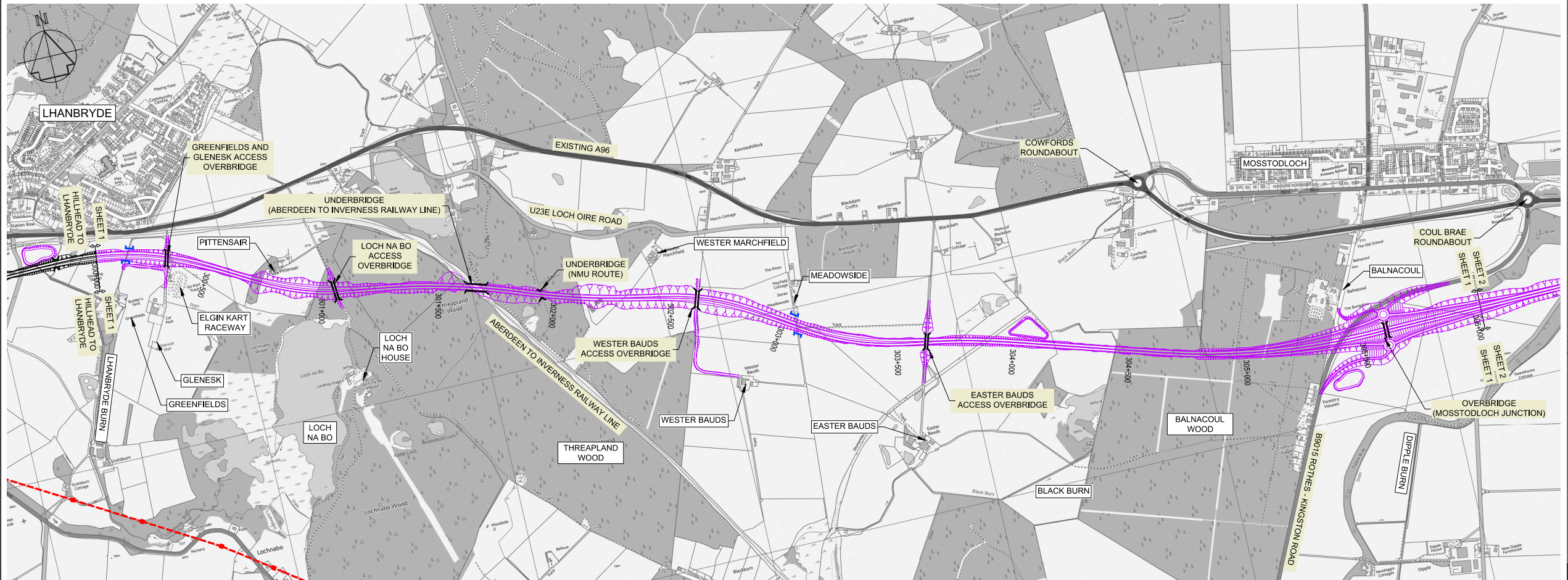

PLAN

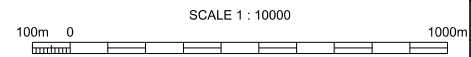

Notes

Key to symbols

- EXISTING ROAD TO BE STOPPED UP
- STRUCTURES
- 132kV OVERHEAD LINES
- INDICATIVE SUDS BASIN/POND
- LOCAL HIGH PRESSURE GAS MAIN

| Rev | Date | Amendment Details | Orig | Chk'd | App'd |
|-----|----------|----------------------------|------|-------|-------|
| P01 | 23/10/18 | For Review and Comment | CB | BP | RL |
| P02 | 27/11/18 | For Stage Approval | MW | CB | RL |
| C01 | 27/11/18 | Approved as Stage Complete | MW | CB | RL |

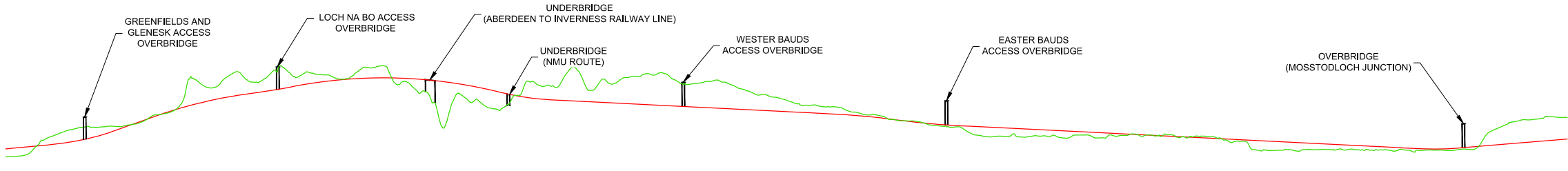

DATUM = 12.0m

| DESIGN LEVELS | EXISTING LEVELS | CHAINAGE |
|---------------|-----------------|----------|
| 36.7 | 33.7 | 300000 |
| 37.6 | 35.8 | 300100 |
| 38.6 | 42.3 | 300200 |
| 40.3 | 44.9 | 300300 |
| 43.0 | 45.4 | 300400 |
| 46.6 | 46.3 | 300500 |
| 50.1 | 50.0 | 300600 |
| 53.1 | 62.7 | 300700 |
| 55.5 | 60.2 | 300800 |
| 57.4 | 66.0 | 300900 |
| 58.8 | 63.8 | 301000 |
| 60.6 | 65.0 | 301100 |
| 62.2 | 65.2 | 301200 |
| 63.3 | 63.5 | 301300 |
| 63.9 | 67.8 | 301400 |
| 63.9 | 61.6 | 301500 |
| 63.4 | 58.8 | 301600 |
| 62.3 | 49.1 | 301700 |
| 60.6 | 55.1 | 301800 |
| 58.5 | 51.5 | 301900 |
| 56.5 | 62.5 | 302000 |
| 55.5 | 60.8 | 302100 |
| 55.0 | 66.6 | 302200 |
| 54.5 | 63.4 | 302300 |
| 54.0 | 64.4 | 302400 |
| 53.5 | 65.3 | 302500 |
| 53.0 | 61.6 | 302600 |
| 52.5 | 62.6 | 302700 |
| 52.0 | 60.8 | 302800 |
| 51.5 | 57.4 | 302900 |
| 51.0 | 55.4 | 303000 |
| 50.5 | 53.5 | 303100 |
| 50.0 | 52.7 | 303200 |
| 49.2 | 49.9 | 303300 |
| 48.2 | 48.0 | 303400 |
| 46.9 | 47.2 | 303500 |
| 46.0 | 45.4 | 303600 |
| 45.4 | 43.1 | 303700 |
| 44.9 | 41.5 | 303800 |
| 44.4 | 41.2 | 303900 |
| 43.9 | 41.5 | 304000 |
| 43.4 | 41.8 | 304100 |
| 42.9 | 40.9 | 304200 |
| 42.4 | 41.9 | 304300 |
| 41.9 | 42.0 | 304400 |
| 41.4 | 41.2 | 304500 |
| 40.9 | 41.6 | 304600 |
| 40.4 | 39.3 | 304700 |
| 39.9 | 36.4 | 304800 |
| 39.4 | 36.1 | 304900 |
| 38.9 | 36.4 | 305000 |
| 38.4 | 36.5 | 305100 |
| 37.9 | 36.3 | 305200 |
| 37.4 | 36.3 | 305300 |
| 36.9 | 35.8 | 305400 |
| 36.6 | 36.2 | 305500 |
| 37.2 | 36.6 | 305600 |
| 38.0 | 43.1 | 305700 |
| 38.8 | 47.3 | 305800 |
| 39.7 | 48.4 | 305900 |
| 40.5 | 48.7 | 306000 |

HORIZONTAL SCALE = 1 : 10,000, VERTICAL SCALE = 1:1,000

Mott MacDonald Sweco

Client: **TRANSPORT SCOTLAND** **A96 DUALLING**
HARDMUIR TO FOCHABERS

Drawing Status: **Approved as Stage Complete** Suitability: **A2**

Project Title: **A96 DUALLING HARDMUIR TO FOCHABERS**

Drawing Title: **FIGURE 7.1 LHANBRYDE TO EAST OF FOCHABERS NORTH OPTION SHEET 1 OF 2**

| Scale | Designed | Drawn | Checked | Approved |
|----------|-----------------|-----------------|-------------|----------------|
| As Shown | Wardlaw, Morgan | Wardlaw, Morgan | Lyng, Ronan | Wallace, Steve |

| Original Size | Date | Date | Date | Date |
|---------------|----------|----------|----------|----------|
| A1 | 26/01/18 | 26/01/18 | 26/01/18 | 26/01/18 |

Drawing Number: **A96PHF - MMS - HGN - 200LN - DR - D - 00006** Project Ref. No: **A96PHF**

Revision: **C01**

TS PHN | Originator | Volume | Location | Type | Role | Number

This drawing should not be relied on or used in circumstances other than those for which it was originally prepared and for which Mott MacDonald Sweco JV was commissioned. This drawing has been prepared for the titled project or named part thereof and should not be relied upon or used for any other project without an independent check being carried out as to its suitability and prior written authority of Mott MacDonald Sweco JV being obtained.

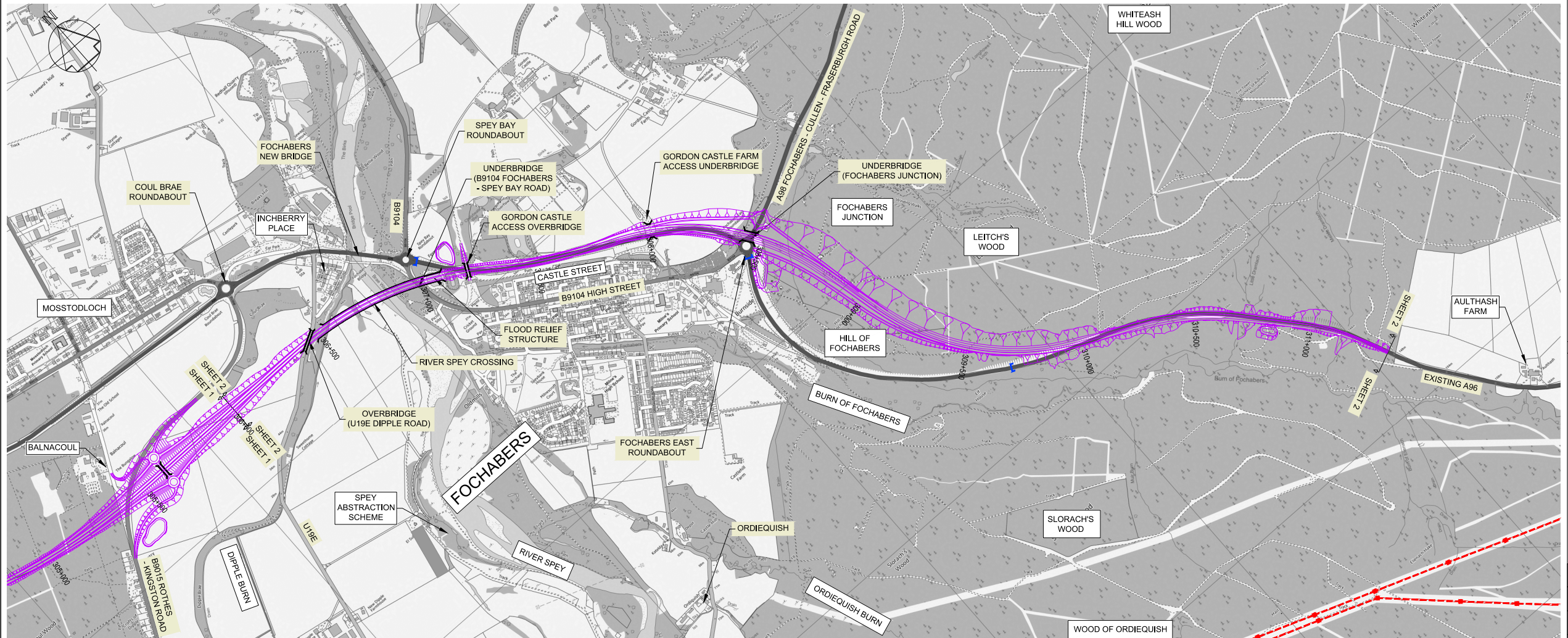

PLAN

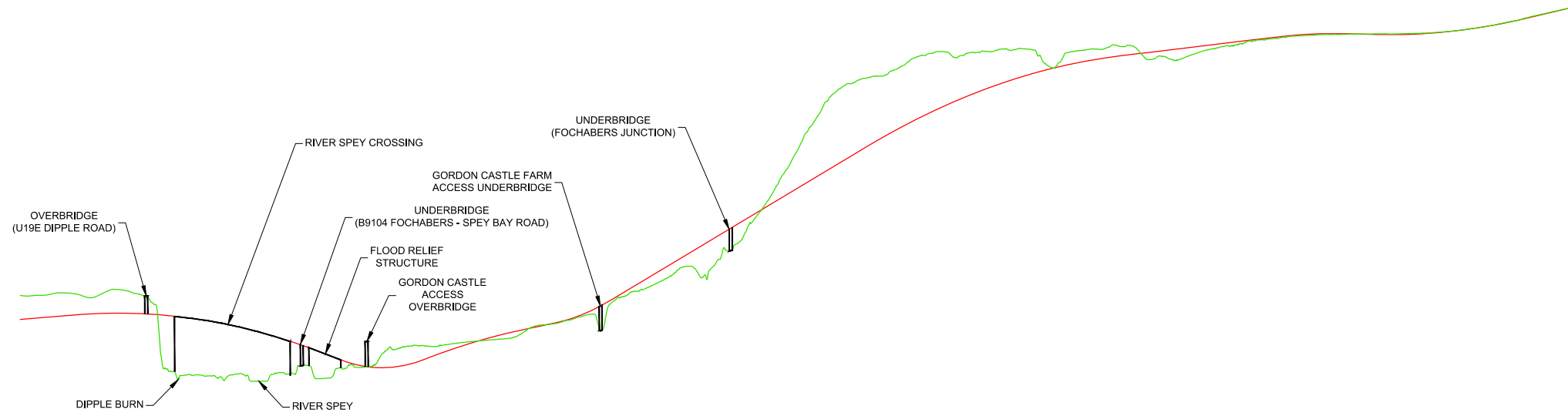
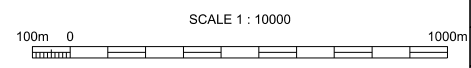

DATUM = -1.0m

| DESIGN LEVELS | 40.5 | 41.3 | 42.1 | 42.6 | 42.5 | 41.9 | 40.7 | 39.0 | 36.7 | 33.9 | 30.5 | 26.6 | 24.1 | 24.3 | 27.1 | 30.7 | 33.8 | 36.3 | 38.4 | 41.0 | 45.3 | 51.2 | 57.2 | 63.2 | 69.2 | 75.2 | 81.2 | 87.2 | 93.2 | 99.2 | 105.0 | 110.2 | 114.9 | 119.0 | 122.5 | 125.5 | 128.0 | 129.9 | 131.3 | 132.5 | 133.7 | 134.9 | 136.1 | 137.3 | 138.3 | 138.7 | 138.6 | 138.4 | 138.6 | 138.6 | 139.3 | 140.6 | 142.3 | 144.5 | 146.8 | 148.0 |
|-----------------|--------|--------|--------|--------|--------|--------|--------|--------|--------|--------|--------|--------|--------|--------|--------|--------|--------|--------|--------|--------|--------|--------|--------|--------|--------|--------|--------|--------|--------|--------|--------|--------|--------|--------|--------|--------|--------|--------|--------|--------|--------|--------|--------|--------|--------|--------|--------|--------|--------|--------|--------|--------|--------|--------|--------|-------|
| EXISTING LEVELS | 45.7 | 49.0 | 49.0 | 50.1 | 49.3 | 23.6 | 21.3 | 19.5 | 19.2 | 22.1 | 24.2 | 23.8 | 24.2 | 30.6 | 31.4 | 32.3 | 33.3 | 34.4 | 36.6 | 40.6 | 36.6 | 49.8 | 53.4 | 56.8 | 61.1 | 72.0 | 86.2 | 104.4 | 118.3 | 123.4 | 126.0 | 131.3 | 131.5 | 132.3 | 133.1 | 133.1 | 130.9 | 132.2 | 133.4 | 134.4 | 130.1 | 130.4 | 133.6 | 135.4 | 137.0 | 138.0 | 138.4 | 138.6 | 138.6 | 138.6 | 139.4 | 140.6 | 142.4 | 144.7 | 147.0 | 148.0 |
| CHAINAGE | 306000 | 306100 | 306200 | 306300 | 306400 | 306500 | 306600 | 306700 | 306800 | 306900 | 307000 | 307100 | 307200 | 307300 | 307400 | 307500 | 307600 | 307700 | 307800 | 307900 | 308000 | 308100 | 308200 | 308300 | 308400 | 308500 | 308600 | 308700 | 308800 | 308900 | 309000 | 309100 | 309200 | 309300 | 309400 | 309500 | 309600 | 309700 | 309800 | 309900 | 310000 | 310100 | 310200 | 310300 | 310400 | 310500 | 310600 | 310700 | 310800 | 310900 | 311000 | 311100 | 311200 | 311300 | 311344 | |

HORIZONTAL SCALE = 1 : 10000, VERTICAL SCALE = 1:1000

Notes

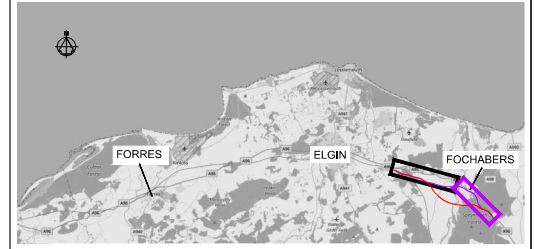

- Key to symbols
- EXISTING ROAD TO BE STOPPED UP
 - STRUCTURES
 - 132kV OVERHEAD LINES
 - INDICATIVE SUDS BASIN/POND
 - LOCAL HIGH PRESSURE GAS MAIN

| Rev | Date | Amendment Details | Orig | Chk'd | App'd |
|-----|----------|----------------------------|------|-------|-------|
| P01 | 23/10/18 | For Review and Comment | CB | BP | RL |
| P02 | 27/11/18 | For Stage Approval | MW | CB | RL |
| C01 | 27/11/18 | Approved as Stage Complete | MW | CB | RL |

Mott MacDonald Sweco



Drawing Status: Approved as Stage Complete | Suitability: A2

Project Title: A96 DUALLING HARDMUIR TO FOCHABERS

Drawing Title: FIGURE 7.2 LHANBYRDE TO EAST OF FOCHABERS NORTH OPTION SHEET 2 OF 2

| As Shown | Designed | Drawn | Checked | Approved |
|-----------------|-----------------|-------------|----------------|----------|
| Wardlaw, Morgan | Wardlaw, Morgan | Lyng, Ronan | Wallace, Steve | |

| Original Size | Date | Date | Date | Date |
|---------------|----------|----------|----------|----------|
| A1 | 26/01/18 | 26/01/18 | 26/01/18 | 26/01/18 |

Drawing Number: A96PHF - MMS - HGN - 200LN - DR - D - 00007 | Project Ref. No: A96PHF | Revision: C01

This drawing should not be relied on or used in circumstances other than those for which it was originally prepared and for which Mott MacDonald Sweco JV was commissioned. This drawing has been prepared for the titled project or named part thereof and should not be relied upon or used for any other project without an independent check being carried out as to its suitability and prior written authority of Mott MacDonald Sweco JV being obtained.

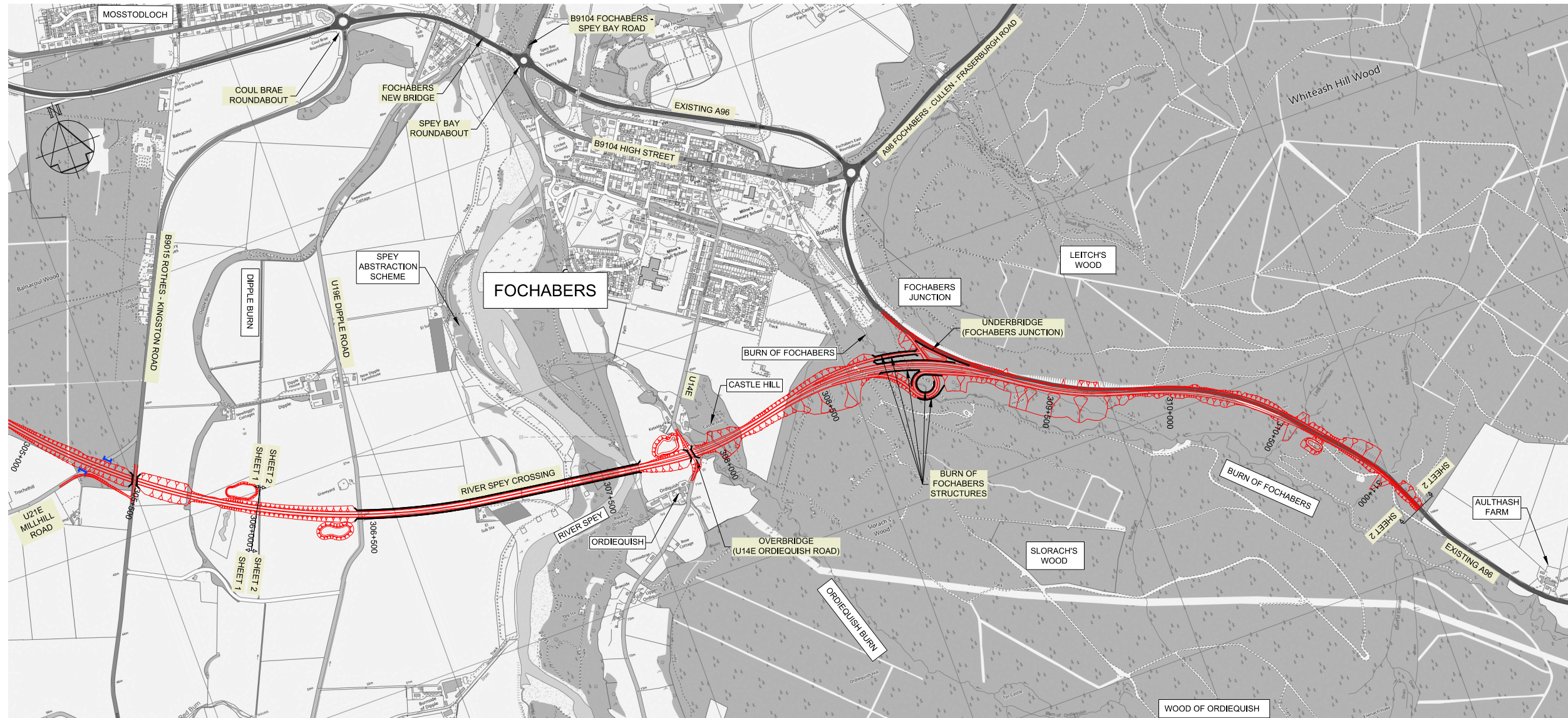

PLAN

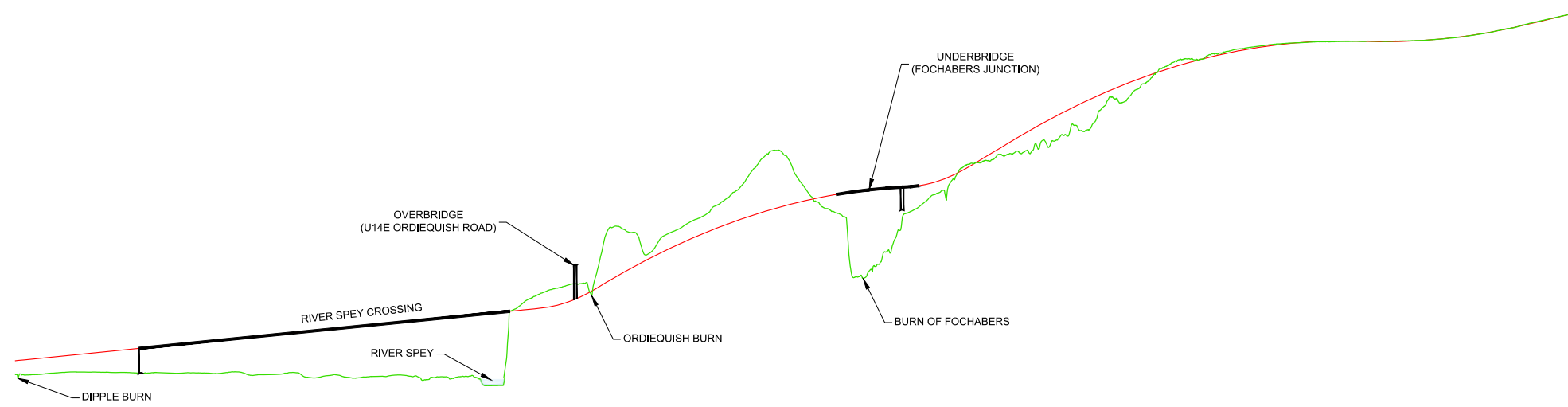
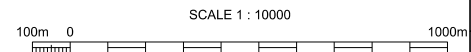

DATUM = 4.0m

| CHAINAGE | EXISTING LEVELS | DESIGN LEVELS |
|----------|-----------------|---------------|
| 306000 | 27.8 | 32.4 |
| 306100 | 28.0 | 33.4 |
| 306200 | 28.7 | 34.4 |
| 306300 | 28.5 | 35.4 |
| 306400 | 28.3 | 36.4 |
| 306500 | 28.3 | 37.4 |
| 306600 | 28.4 | 38.4 |
| 306700 | 28.4 | 39.4 |
| 306800 | 27.6 | 40.4 |
| 306900 | 28.3 | 41.4 |
| 307000 | 26.7 | 42.4 |
| 307100 | 27.0 | 43.4 |
| 307200 | 27.2 | 44.4 |
| 307300 | 27.5 | 45.4 |
| 307400 | 26.9 | 46.4 |
| 307500 | 27.2 | 47.4 |
| 307600 | 24.4 | 48.4 |
| 307700 | 52.4 | 49.4 |
| 307800 | 56.5 | 50.7 |
| 307900 | 58.3 | 54.5 |
| 308000 | 77.2 | 60.3 |
| 308100 | 67.5 | 65.8 |
| 308200 | 75.6 | 70.7 |
| 308300 | 81.0 | 75.1 |
| 308400 | 88.8 | 78.9 |
| 308500 | 100.9 | 82.2 |
| 308600 | 94.0 | 84.9 |
| 308700 | 83.0 | 87.1 |
| 308800 | 60.4 | 88.7 |
| 308900 | 68.5 | 89.8 |
| 309000 | 83.0 | 90.5 |
| 309100 | 85.8 | 93.1 |
| 309200 | 98.4 | 98.4 |
| 309300 | 100.8 | 104.4 |
| 309400 | 104.3 | 110.2 |
| 309500 | 107.4 | 115.5 |
| 309600 | 112.8 | 120.3 |
| 309700 | 118.8 | 124.5 |
| 309800 | 128.1 | 128.2 |
| 309900 | 132.8 | 131.3 |
| 310000 | 134.6 | 133.9 |
| 310100 | 136.5 | 135.9 |
| 310200 | 137.7 | 137.4 |
| 310300 | 138.3 | 138.4 |
| 310400 | 138.5 | 138.7 |
| 310500 | 138.7 | 138.6 |
| 310600 | 138.7 | 138.6 |
| 310700 | 139.0 | 139.0 |
| 310800 | 139.9 | 140.0 |
| 310900 | 141.4 | 141.5 |
| 311000 | 143.4 | 143.4 |
| 311100 | 145.9 | 145.8 |
| 311190 | 148.0 | 148.0 |

HORIZONTAL SCALE = 1 : 10000, VERTICAL SCALE = 1:1000

Notes

Key to symbols

- EXISTING ROAD TO BE STOPPED UP
- STRUCTURES
- 132kV OVERHEAD LINES
- INDICATIVE SUDS BASIN/POND
- LOCAL HIGH PRESSURE GAS MAIN

| Rev | Date | Amendment Details | Orig | Chk'd | App'd |
|-----|----------|----------------------------|------|-------|-------|
| P01 | 23/10/18 | For Review and Comment | CB | BP | RL |
| P02 | 27/11/18 | For Stage Approval | MW | CB | RL |
| C01 | 27/11/18 | Approved as Stage Complete | MW | CB | RL |

| Rev | Date | Amendment Details | Orig | Chk'd | App'd |
|-----|----------|----------------------------|------|-------|-------|
| P01 | 23/10/18 | For Review and Comment | CB | BP | RL |
| P02 | 27/11/18 | For Stage Approval | MW | CB | RL |
| C01 | 27/11/18 | Approved as Stage Complete | MW | CB | RL |

Mott MacDonald Sweco

Client: **TRANSPORT SCOTLAND** **A96 DUALLING HARDMUIR TO FOCHABERS**

Drawing Status: **Approved as Stage Complete** Subtitle: **A2**

Project Title: **A96 DUALLING HARDMUIR TO FOCHABERS**

Drawing Title: **FIGURE 7.4 LHANBRYDE TO EAST OF FOCHABERS SOUTH OPTION SHEET 2 OF 2**

| Scale | As Shown | Designed | Drawn | Checked | Approved |
|-------|----------|----------------|----------------|-------------|----------------|
| | | Berkery, Chris | Berkery, Chris | Lyng, Ronan | Wallace, Steve |

| Original Size | Date | Date | Date | Date |
|---------------|----------|----------|----------|----------|
| A1 | 26/01/18 | 26/01/18 | 26/01/18 | 26/01/18 |

Drawing Number: **A96PHF - MMS - HGN - 200LS - DR - D - 00005** Project Ref. No.: **A96PHF**

Revision: **C01**