

2010 No. 107

ROADS AND BRIDGES

**The A956 (Aberdeen Western Peripheral Route) Trunk Road
(Side Roads) Order 2010**

Made - - - - - 11th March 2010

Coming into force - - - - - 31st March 2010

The Scottish Ministers make the following Order in exercise of the powers conferred by section 12(1) and (5) of the Roads (Scotland) Act 1984(a) and all other powers enabling them to do so.

In accordance with section 12(3) of that Act, they are satisfied, as the case requires, that another reasonably convenient route is available or will be provided before any road is stopped up pursuant to this Order.

In accordance with sections 20A(b) and 55A(c) of that Act, they have determined that the project falls within Annex I to Council Directive 85/337/EEC(d), as relevantly amended by Council Directive 97/11/EC(e) and Council Directive 2003/35/EC(f), on the assessment of the effects of certain public and private projects on the environment.

In accordance with sections 20A(2) and 55A(2) of that Act, they have prepared an environmental statement and published notice of it on 11th September 2007 and have complied with all other provisions of sections 20A and 55A of that Act.

This Order is made in accordance with the provisions of Parts I and III of Schedule 1(g) to that Act.

Citation, commencement and interpretation

1.—(1) This Order may be cited as the A956 (Aberdeen Western Peripheral Route) Trunk Road (Side Roads) Order 2010 and comes into force on the 28th day after the day on which the A90

(a) 1984 c.54. The functions of the Secretary of State were transferred to the Scottish Ministers by virtue of section 53 of the Scotland Act 1998 (c.46).

(b) Section 20A was substituted by S.S.I. 1999/1 and was amended by S.S.I. 2006/614.

(c) Section 55A was substituted by S.S.I. 1999/1 and was amended by S.S.I. 2006/614.

(d) O.J. L 175, 5.7.1985, p.40.

(e) O.J. L 73, 14.3.1997, p.5.

(f) O.J. L 156, 25.6.2003, p.17.

(g) Part I of Schedule 1 was relevantly amended by the Local Government etc. (Scotland) Act 1994 (c.39), Schedule 13, Paragraph 135; the Water Industry (Scotland) Act 2002 (asp 3), schedule 7, paragraph 14; the Transport and Works (Scotland) Act 2007 (asp 8), section 24, schedule 2, paragraph 3 and schedule 3, and also by S.S.I. 1999/1 and 2006/614.

(Aberdeen Western Peripheral Route) Special Road Scheme 2010(a) is approved by resolution of the Scottish Parliament.

(2) In this Order "the plan folio" means the plan folio numbered RYC/G109/13/0734 and entitled "The A956 (Aberdeen Western Peripheral Route) Trunk Road (Side Roads) Order 2010", signed with reference to this Order and deposited at the offices of Transport Scotland, Buchanan House, 58 Port Dundas Road, Glasgow, G4 0HF.

Side roads

2. The Scottish Ministers as roads authority are authorised—

- (a) to construct those lengths of road (hereinafter referred to as "the new side roads") along the routes described in Schedule 1;
- (b) to improve those lengths of road described in Schedule 2; and
- (c) to stop up those lengths of road described in Schedule 3 when the new side roads are open for the purposes of through traffic.

Statutory Undertakers

3. Where immediately before the date this Order comes into force there is under, in, on, over, along or across any of the lengths of road described in Schedules 2 and 3 any apparatus of a statutory undertaker, any rights of the statutory undertaker in respect of such apparatus shall be preserved.

Transfer of Roads

4. On 1st April next after the date on which the new side roads are all open for the purposes of through traffic, the new side roads shall be transferred to Aberdeen City Council(b) as roads authority for those roads.



A member of the staff of the Scottish Ministers

Transport Scotland
Buchanan House
58 Port Dundas Road
Glasgow
G4 0HF
11th March 2010

(a) S.S.I. 2010/79.

(b) A council constituted under section 2 of the Local Government etc. (Scotland) Act 1994 (c.39). Aberdeen Council changed the name for their area from "Aberdeen" to "Aberdeen City" by resolution under section 23(1) of the Local Government (Scotland) Act 1973 (c.65) on 9th May 1995.

SCHEDULE 1

Article 2(a)

THE ROUTES OF THE NEW SIDE ROADS

1. From a point 325 metres or thereby south-west of the northern-most corner of the building known as Boyne Villa, Nigg, Aberdeen, AB12 3LL in a generally northerly direction for a distance of 115 metres or thereby to a point 235 metres or thereby west, south-west of the northern-most corner of the building known as Boyne Villa, Nigg, Aberdeen, AB12 3LL as shown by stipple and numbered "1" on plan SR1 in the plan folio.

2. From a point 230 metres or thereby west, south-west of the northern-most corner of the building known as Boyne Villa, Nigg, Aberdeen, AB12 3LL in a generally northerly direction for a distance of 445 metres or thereby to a point 130 metres or thereby south, south-west of the northern-most corner of the building known as The Clachan, Nigg, Aberdeen, AB12 3LL as shown by stipple and numbered "2" on plan SR1 in the plan folio.

3. From a point 160 metres or thereby south, south-west of the northern-most corner of the building known as Boyne Villa, Nigg, Aberdeen, AB12 3LL in a generally southerly direction for a distance of 35 metres or thereby to a point 185 metres or thereby south, south-west of the northern-most corner of the building known as Boyne Villa, Nigg, Aberdeen, AB12 3LL as shown by stipple and numbered "3" on plan SR1 in the plan folio.

4. From a point 200 metres or thereby south, south-west of the northern-most corner of the building known as Boyne Villa, Nigg, Aberdeen, AB12 3LL in a generally east, north-easterly direction for a distance of 155 metres or thereby to a point 140 metres or thereby south, south-east of the northern-most corner of the building known as Boyne Villa, Nigg, Aberdeen, AB12 3LL as shown by stipple and numbered "4" on plan SR1 in the plan folio.

5. From a point 140 metres or thereby south-west of the northern-most corner of the building known as Boyne Villa, Nigg, Aberdeen, AB12 3LL in a generally southerly direction for a distance of 15 metres or thereby to a point 150 metres or thereby south, south-west of the northern-most corner of the building known as Boyne Villa, Nigg, Aberdeen, AB12 3LL as shown by stipple and numbered "5" on plan SR1 in the plan folio.

6. From a point 100 metres or thereby west, south-west of the northern-most corner of the building known as Boyne Villa, Nigg, Aberdeen, AB12 3LL in a generally southerly direction for a distance of 55 metres or thereby to a point 135 metres or thereby south-west of the northern-most corner of the building known as Boyne Villa, Nigg, Aberdeen, AB12 3LL as shown by stipple and numbered "6" on plan SR1 in the plan folio.

7. From a point 85 metres or thereby south, south-west of the northern-most corner of the building known as The Clachan, Nigg, Aberdeen, AB12 3LL in a generally southerly direction for a distance of 400 metres or thereby to a point 95 metres or thereby west, south-west of the northern-most corner of the building known as Boyne Villa, Nigg, Aberdeen, AB12 3LL as shown by stipple and numbered "7" on plan SR1 in the plan folio.

8. From a point 90 metres or thereby west, north-west of the northern-most corner of the building known as The Clachan, Nigg, Aberdeen, AB12 3LL in a generally northerly direction for a distance of 45 metres or thereby to a point 115 metres or thereby west, north-west of the northern-most corner of the building known as The Clachan, Nigg, Aberdeen, AB12 3LL as shown by stipple and numbered "8" on plan SR1 in the plan folio.

9. From a point 135 metres or thereby west, south-west of the northern-most corner of the building known as The Clachan, Nigg, Aberdeen, AB12 3LL in a generally north, north-westerly direction for a distance of 10 metres or thereby to a point 135 metres or thereby west, south-west of the northern-most corner of the building known as The Clachan, Nigg, Aberdeen, AB12 3LL as shown by stipple and numbered "36" on plan SR1 in the plan folio.

10. From a point 150 metres or thereby south, south-east of the northern-most corner of the building known as Boyne Villa, Nigg, Aberdeen, AB12 3LL in a generally southerly direction for a distance of 225 metres or thereby to a point 360 metres or thereby south of the northern-most corner of the building known as Boyne Villa, Nigg, Aberdeen, AB12 3LL as shown by stipple and numbered “9” on plan SR2 in the plan folio.

11. From a point 135 metres or thereby south, south-east of the northern-most corner of the building known as Boyne Villa, Nigg, Aberdeen, AB12 3LL in a generally east, north-easterly direction for a distance of 185 metres or thereby to a point 245 metres or thereby east of the northern-most corner of the building known as Boyne Villa, Nigg, Aberdeen, AB12 3LL as shown by stipple and numbered “10” on plan SR2 in the plan folio.

12. From a point 120 metres or thereby south, south-east of the northern-most corner of the building known as Boyne Villa, Nigg, Aberdeen, AB12 3LL in a generally east, north-easterly direction for a distance of 10 metres or thereby to a point 120 metres or thereby south, south-east of the northern-most corner of the building known as Boyne Villa, Nigg, Aberdeen, AB12 3LL as shown by stipple and numbered “11” on plan SR2 in the plan folio.

13. From a point 80 metres or thereby east, south-east of the northern-most corner of the building known as Boyne Villa, Nigg, Aberdeen, AB12 3LL in a generally northerly direction for a distance of 15 metres or thereby to a point 70 metres or thereby east, south-east of the northern-most corner of the building known as Boyne Villa, Nigg, Aberdeen, AB12 3LL as shown by stipple and numbered “12” on plan SR2 in the plan folio.

14. From a point 70 metres or thereby east, south-east of the northern-most corner of the building known as Boyne Villa, Nigg, Aberdeen, AB12 3LL in a generally southerly direction for a distance of 40 metres or thereby to a point 95 metres or thereby south-east of the northern-most corner of the building known as Boyne Villa, Nigg, Aberdeen, AB12 3LL as shown by stipple and numbered “13” on plan SR2 in the plan folio.

SCHEDULE 2

Article 2(b)

LENGTHS OF ROAD TO BE IMPROVED

1. That length of the existing A956 Wellington Road northbound slip, Aberdeen from a point 235 metres or thereby west, south-west of the northern-most corner of the building known as Boyne Villa, Nigg, Aberdeen, AB12 3LL in a generally westerly direction for a distance of 5 metres or thereby to a point 225 metres or thereby west, south-west of the northern-most corner of the building known as Boyne Villa, Nigg, Aberdeen, AB12 3LL as shown by cross hatching and numbered “14” on Plan SR1 in the plan folio.

2. That length of the existing A90/M90 Inverkeithing – Fraserburgh Trunk Road southbound merge, Aberdeen from a point 150 metres or thereby south, south-west of the northern-most corner of the building known as Boyne Villa, Nigg, Aberdeen, AB12 3LL in a generally south westerly direction for a distance of 10 metres or thereby to a point 160 metres or thereby south, south-west of the northern-most corner of the building known as Boyne Villa, Nigg, Aberdeen, AB12 3LL as shown by cross hatching and numbered “15” on Plan SR1 in the plan folio.

3. That length of the existing A956 Wellington Road northbound slip, Aberdeen from a point 135 metres or thereby south-west of the northern-most corner of the building known as Boyne Villa, Nigg, Aberdeen, AB12 3LL in a generally westerly direction for a distance of 5 metres or thereby to a point 140 metres or thereby south-west of the northern-most corner of the building known as Boyne Villa, Nigg, Aberdeen, AB12 3LL as shown by cross hatching and numbered “16” on Plan SR1 in the plan folio.

4. That length of the existing A90/M90 Inverkeithing – Fraserburgh Trunk Road southbound diverge, Aberdeen from a point 95 metres or thereby west, south-west of the northern-most corner of the building known as Boyne Villa, Nigg, Aberdeen, AB12 3LL in a generally south easterly direction for a distance of 10 metres or thereby to a point 100 metres or thereby west, south-west of the northern-most corner of the building known as Boyne Villa, Nigg, Aberdeen, AB12 3LL as shown by cross hatching and numbered “17” on Plan SR1 in the plan folio.

5. That length of the existing Old Stonehaven Road (U168K), Aberdeen from a point 125 metres or thereby south-east of the northern-most corner of the building known as Boyne Villa, Nigg, Aberdeen, AB12 3LL in a generally northerly direction for a distance of 95 metres or thereby to a point 60 metres or thereby east of the northern-most corner of the building known as Boyne Villa, Nigg, Aberdeen, AB12 3LL as shown by cross hatching and numbered “20” on Plan SR2 in the plan folio.

6. That length of the existing A956 Wellington Road, Aberdeen from a point 130 metres or thereby south-east of the northern-most corner of the building known as Boyne Villa, Nigg, Aberdeen, AB12 3LL in a generally east, north-easterly direction for a distance of 285 metres or thereby to a point 345 metres or thereby east of the northern-most corner of the building known as Boyne Villa, Nigg, Aberdeen, AB12 3LL as shown by cross hatching and numbered “21” on Plan SR2 in the plan folio.

SCHEDULE 3

Article 2(c)

LENGTHS OF ROAD TO BE STOPPED UP

1. That length of the existing A90/M90 Inverkeithing – Fraserburgh Trunk Road northbound diverge, Aberdeen from a point 205 metres or thereby east of the eastern-most corner of the building known as Bothy Brig Cottage, Nigg, Aberdeenshire, AB12 5YJ in a generally north, north-easterly then north, north-westerly then north-westerly direction for a distance of 340 metres or thereby to a point 400 metres or thereby north, north-east of the eastern-most corner of the building known as Bothy Brig Cottage, Nigg, Aberdeenshire, AB12 5YJ as shown by zebra hatching and numbered “22” on plan SR1 in the plan folio.

2. That length of the existing A90/M90 Inverkeithing – Fraserburgh Trunk Road southbound merge, Aberdeen from a point 160 metres or thereby south, south-west of the northern-most corner of the building known as Boyne Villa, Nigg, Aberdeen, AB12 3LL in a generally south-westerly then south, south-westerly direction for a distance of 490 metres or thereby to a point 225 metres or thereby east of the eastern-most corner of the building known as Bothy Brig Cottage, Nigg, Aberdeenshire, AB12 5YJ as shown by zebra hatching and numbered “23” on plan SR1 in the plan folio.

3. That length of the existing A956 Wellington Road northbound slip, Aberdeen from a point 405 metres or thereby north, north-east of the eastern-most corner of the building known as Bothy Brig Cottage, Nigg, Aberdeenshire, AB12 5YJ in a generally north-westerly then northerly then north-easterly then easterly direction for a distance of 255 metres or thereby to a point 235 metres or thereby west, south-west of the northern-most corner of the building known as Boyne Villa, Nigg, Aberdeen, AB12 3LL as shown by zebra hatching and numbered “24” on plan SR1 in the plan folio.

4. That length of the existing A90/M90 Inverkeithing – Fraserburgh Trunk Road northbound merge, Aberdeen from a point 380 metres or thereby south-west of the northern-most corner of the building known as Boyne Villa, Nigg, Aberdeen, AB12 3LL in a generally easterly then north-easterly then northerly direction for a distance of 475 metres or thereby to a point 190 metres or thereby north-west of the northern-most corner of the building known as Boyne Villa, Nigg, Aberdeen, AB12 3LL as shown by zebra hatching and numbered “25” on plan SR1 in the plan folio.

5. That length of the existing A956 Wellington Road northbound slip, Aberdeen from a point 230 metres or thereby west, south-west of the northern-most corner of the building known as Boyne Villa, Nigg, Aberdeen, AB12 3LL in a generally easterly direction for a distance of 110 metres or thereby to a point 140 metres or thereby south-west of the northern-most corner of the building known as Boyne Villa, Nigg, Aberdeen, AB12 3LL as shown by zebra hatching and numbered “26” on plan SR1 in the plan folio.

6. That length of the existing A90/M90 Inverkeithing – Fraserburgh Trunk Road southbound merge, Aberdeen from a point 120 metres or thereby south, south-east of the northern-most corner of the building known as Boyne Villa, Nigg, Aberdeen, AB12 3LL in a generally westerly then west, south-westerly direction for a distance of 145 metres or thereby to a point 155 metres or thereby south, south-west of the northern-most corner of the building known as Boyne Villa, Nigg, Aberdeen, AB12 3LL as shown by zebra hatching and numbered “27” on plan SR1 in the plan folio.

7. That length of the existing A956 Wellington Road, Aberdeen from a point 135 metres or thereby south-west of the northern-most corner of the building known as Boyne Villa, Nigg, Aberdeen, AB12 3LL in a generally easterly direction for a distance of 145 metres or thereby to a point 110 metres or thereby south-east of the northern-most corner of the building known as Boyne Villa, Nigg, Aberdeen, AB12 3LL as shown by zebra hatching and numbered “28” on plan SR1 in the plan folio.

8. That length of the existing Old Stonehaven Road (U168K), Aberdeen from a point 95 metres or thereby south, south-east of the northern-most corner of the building known as Boyne Villa, Nigg, Aberdeen, AB12 3LL in a generally north-easterly direction for a distance of 20 metres or thereby to a point 90 metres or thereby south-east of the northern-most corner of the building known as Boyne Villa, Nigg, Aberdeen, AB12 3LL as shown by zebra hatching and numbered “29” on plan SR1 in the plan folio.

9. That length of the existing A90/M90 Inverkeithing – Fraserburgh Trunk Road southbound diverge, Aberdeen from a point 100 metres or thereby west, south-west of the northern-most corner of the building known as Boyne Villa, Nigg, Aberdeen, AB12 3LL in a generally east, south-easterly then easterly direction for a distance of 105 metres or thereby to a point 90 metres or thereby south of the northern-most corner of the building known as Boyne Villa, Nigg, Aberdeen, AB12 3LL as shown by zebra hatching and numbered “30” on plan SR1 in the plan folio.

10. That length of the existing A90/M90 Inverkeithing – Fraserburgh Trunk Road southbound diverge, Aberdeen from a point 140 metres or thereby south, south-west of the northern-most corner of the building known as The Clachan, Nigg, Aberdeen, AB12 3LL in a generally southerly then south, south-easterly direction for a distance of 350 metres or thereby to a point 100 metres or thereby west, south-west of the northern-most corner of the building known as Boyne Villa, Nigg, Aberdeen, AB12 3LL as shown by zebra hatching and numbered “31” on plan SR1 in the plan folio.

11. That length of the existing Lochton – Auchlunies – Nigg Road (C5K), Aberdeen from a point 90 metres or thereby west, south-west of the northern-most corner of the building known as The Clachan, Nigg, Aberdeen, AB12 3LL in a generally west, south-westerly direction for a distance of 25 metres or thereby to a point 115 metres or thereby west, south-west of the northern-most corner of the building known as The Clachan, Nigg, Aberdeen, AB12 3LL as shown by zebra hatching and numbered “32” on plan SR1 in the plan folio.

12. That length of the existing A90/M90 Inverkeithing – Fraserburgh Trunk Road from a point 110 metres or thereby south-west of the northern-most corner of the building known as The Clachan, Nigg, Aberdeen, AB12 3LL in a generally northerly direction for a distance of 90 metres or thereby to a point 85 metres or thereby west of the northern-most corner of the building known as The Clachan, Nigg, Aberdeen, AB12 3LL as shown by zebra hatching and numbered “33” on plan SR1 in the plan folio.

13. That length of the existing A90/M90 Inverkeithing – Fraserburgh Trunk Road from a point 65 metres or thereby west of the northern-most corner of the building known as The Clachan, Nigg, Aberdeen, AB12 3LL in a generally southerly direction for a distance of 65 metres or thereby to a point 80 metres or thereby south-west of the northern-most corner of the building known as The Clachan, Nigg, Aberdeen, AB12 3LL as shown by zebra hatching and numbered “35” on plan SR1 in the plan folio.





14. That length of the existing A956 Wellington Road, Aberdeen from a point 115 metres or thereby south-east of the northern-most corner of the building known as Boyne Villa, Nigg, Aberdeen, AB12 3LL in a generally east, north-easterly direction for a distance of 150 metres or thereby to a point 215 metres or thereby east of the northern-most corner of the building known as Boyne Villa, Nigg, Aberdeen, AB12 3LL as shown by zebra hatching and numbered “34” on plan SR2 in the plan folio.

The A956 (Aberdeen Western Peripheral Route) Trunk Road (Side Roads) Order 2010

SCALE

KEY PLAN _____ 1:20,000
ORDER PLAN : SR1, SR2 _____ 1:2,500

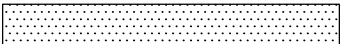
LEGEND

SIDE ROAD TO BE IMPROVED _____	
SIDE ROAD TO BE STOPPED UP _____	
NEW SIDE ROAD _____	
ASSOCIATED ABERDEEN WESTERN PERIPHERAL ROUTE ROAD PROPOSALS _____	



An agency of SCOTTISH EXECUTIVE

LEGEND

== == == == ASSOCIATED ABERDEEN WESTERN PERIPHERAL ROUTE ROAD PROPOSALS

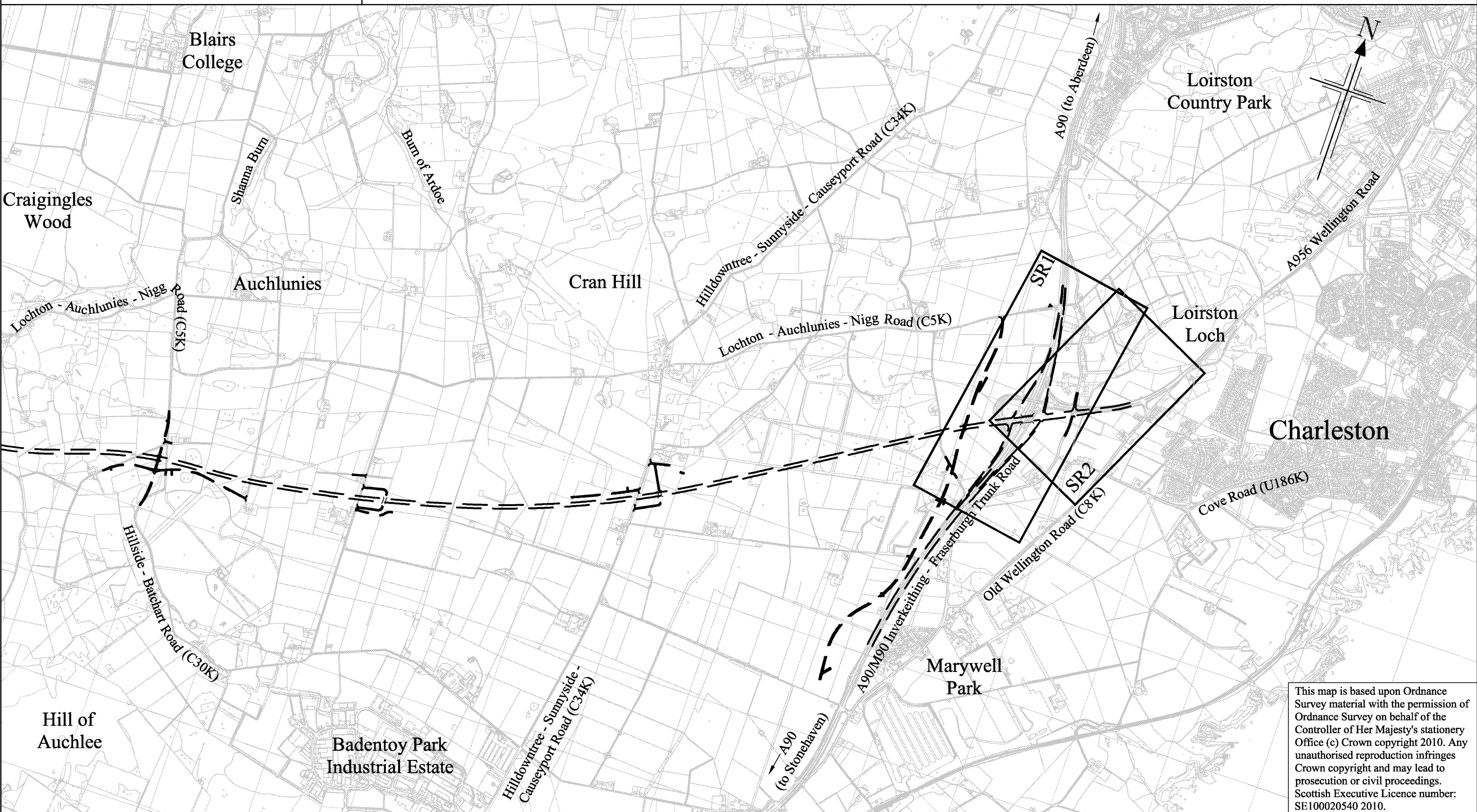

This map is based upon Ordnance Survey material with the permission of Ordnance Survey on behalf of the Controller of Her Majesty's Stationery Office (c) Crown copyright 2010. Any unauthorised reproduction infringes Crown copyright and may lead to prosecution or civil proceedings. Scottish Executive Licence number: SE100020540 2010.

The A956 (Aberdeen Western Peripheral Route) Trunk Road
(Side Roads) Order 2010

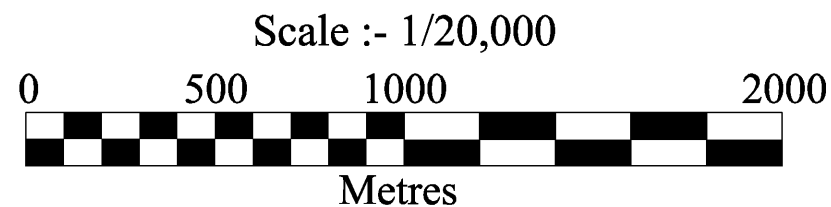

Key Plan
Sheet 1 of 1

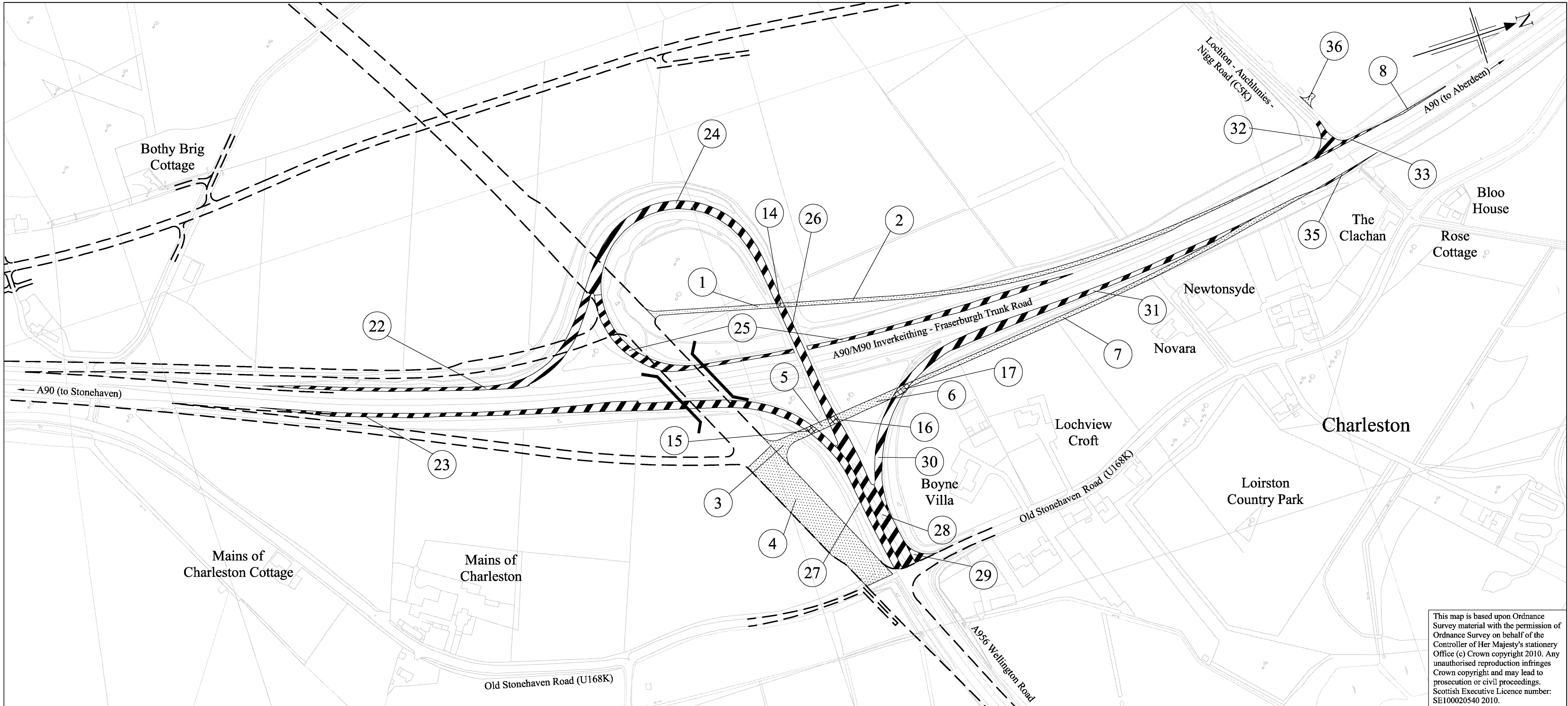

This map is based upon Ordnance Survey material with the permission of Ordnance Survey on behalf of the Controller of Her Majesty's stationery Office (c) Crown copyright 2010. Any unauthorised reproduction infringes Crown copyright and may lead to prosecution or civil proceedings. Scottish Executive Licence number: SE100020540 2010.

The A956 (Aberdeen Western Peripheral Route) Trunk Road
(Side Roads) Order 2010

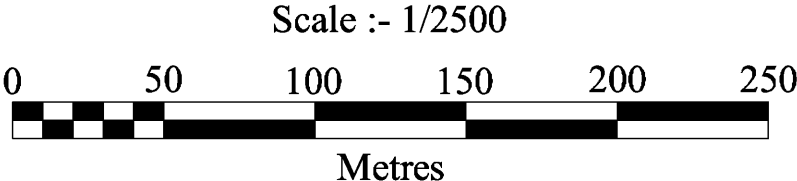

plan
SR1



An agency of SCOTTISH EXECUTIVE

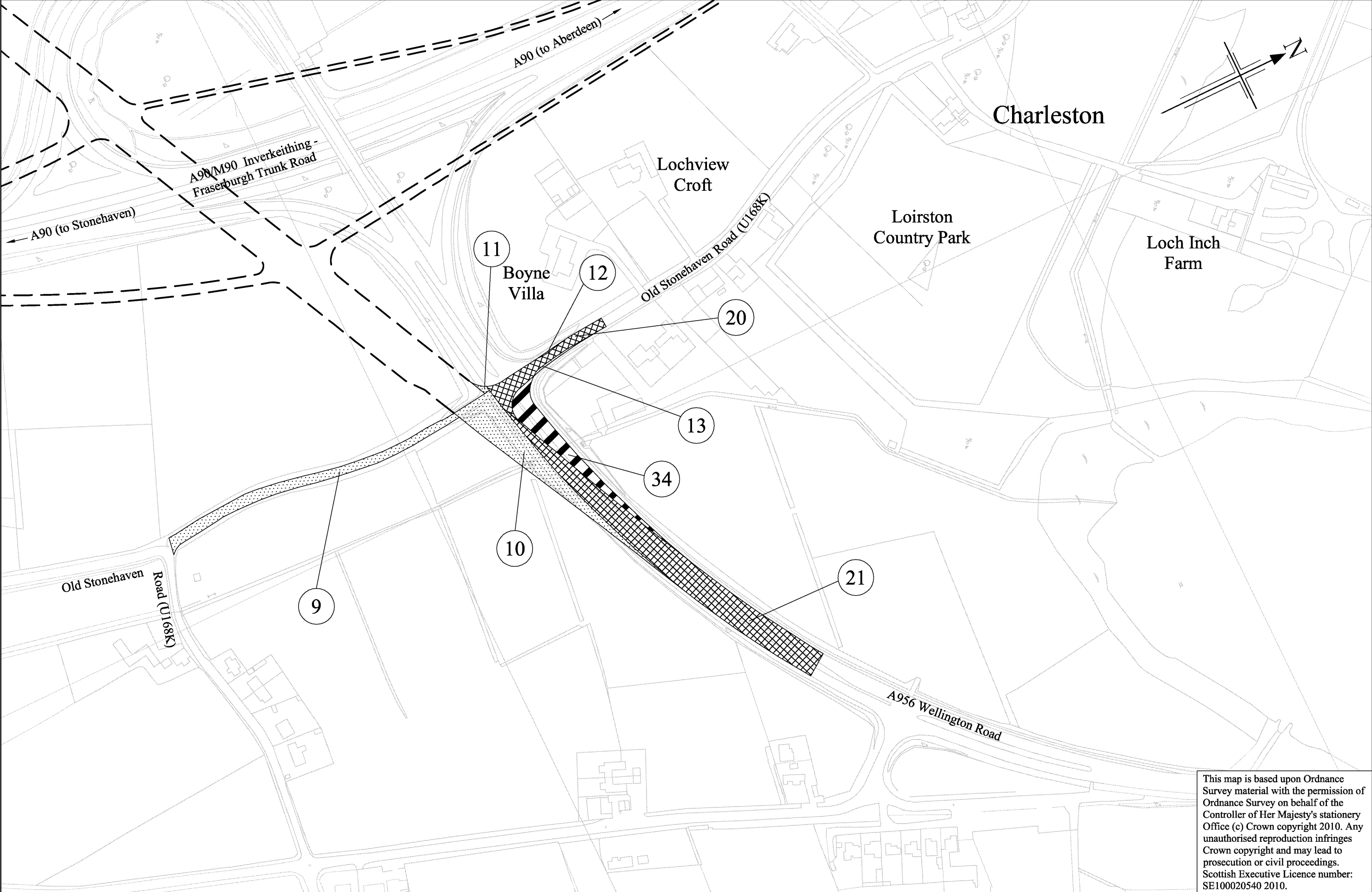

This map is based upon Ordnance Survey material with the permission of Ordnance Survey on behalf of the Controller of Her Majesty's stationery Office (c) Crown copyright 2010. Any unauthorised reproduction infringes Crown copyright and may lead to prosecution or civil proceedings. Scottish Executive Licence number: SE100020540 2010.

The A956 (Aberdeen Western Peripheral Route) Trunk Road (Side Roads) Order 2010

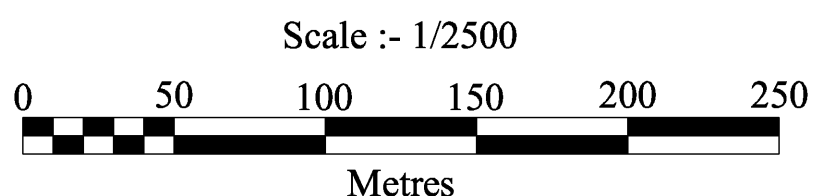

plan
SR2



An agency of SCOTTISH EXECUTIVE