

This map is based on Ordnance Survey material with the permission of Ordnance Survey on behalf of the Controller of Her Majesty's Stationery Office © Crown Copyright. All rights reserved. No part of this publication may be reproduced, stored in a retrieval system or transmitted in any form or by any means, electronic, mechanical, photocopying, recording or otherwise without the prior written permission of Ordnance Survey. Executive 100020540 2008.

Plan
[Scale 1:2500 @A3]

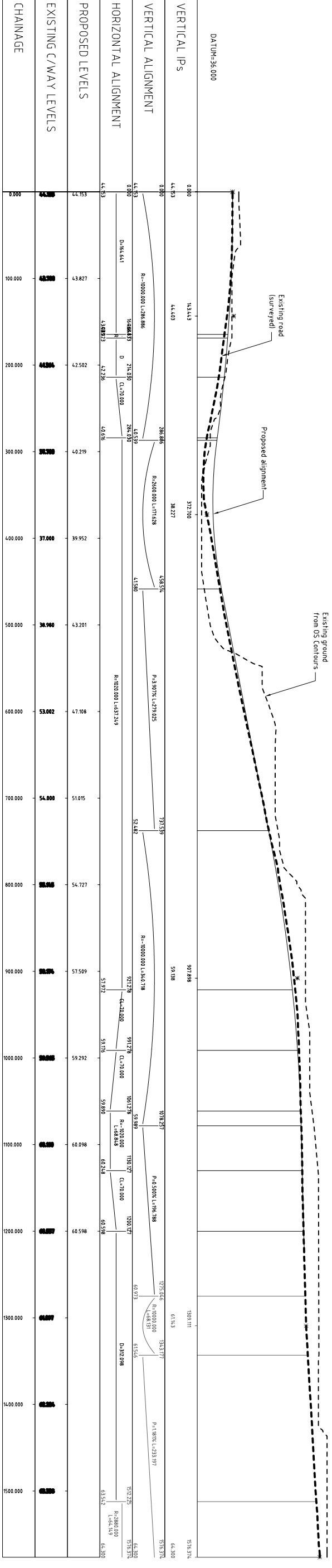

Profile
[Scale 1:2500 H:1500V @A3]

- NOTES**
1. Works entail offline realignment of the A96. Horizontal and vertical geometry improved to provide visibility.
 2. Right-Left stagger junction layout proposed.
 3. Design speed 100kph
 4. Single S2 cross section provided. (DMRB TDZ/05)
 5. Existing ground level information extrapolated from a combination of OS contours and a survey of the existing road channels (accuracy therefore uncertain at this stage).