

This map is based on Ordnance Survey material with the permission of Ordnance Survey on behalf of the Controller of Her Majesty's Stationary Office. © Crown copyright. Unauthorised reproduction infringes Crown copyright and may lead to prosecution or civil proceedings. Scottish Government 100020540 2008.

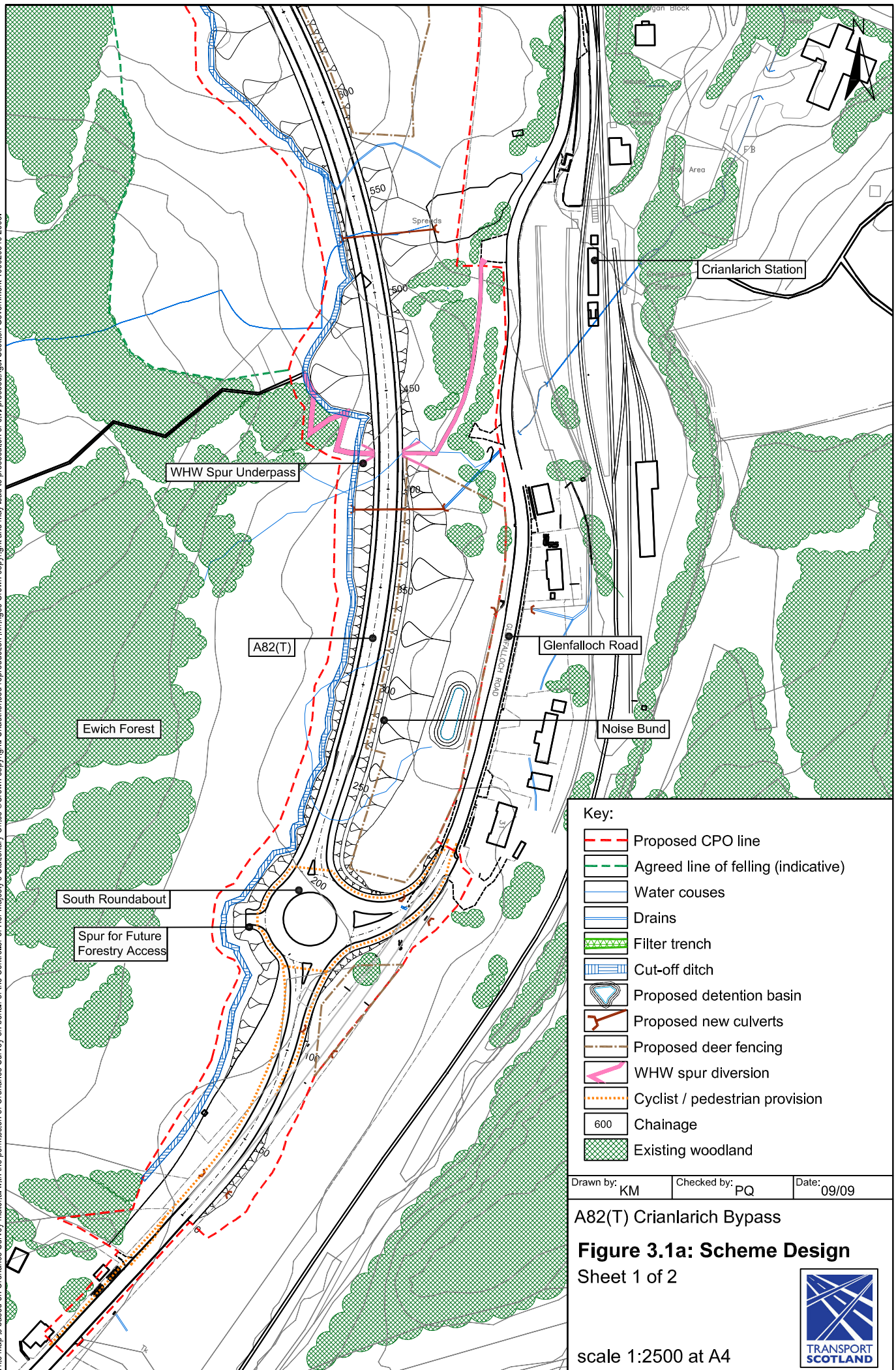

- Key:**
- Proposed CPO line
  - Agreed line of felling (indicative)
  - Water courses
  - Drains
  - Filter trench
  - Cut-off ditch
  - Proposed detention basin
  - Proposed new culverts
  - Proposed deer fencing
  - WHW spur diversion
  - Cyclist / pedestrian provision
  - 600 Chainage
  - Existing woodland

Drawn by: KM	Checked by: PQ	Date: 09/09
--------------	----------------	-------------

**A82(T) Crianlarich Bypass**  
**Figure 3.1a: Scheme Design**  
 Sheet 1 of 2

scale 1:2500 at A4

