

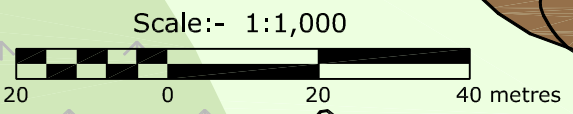

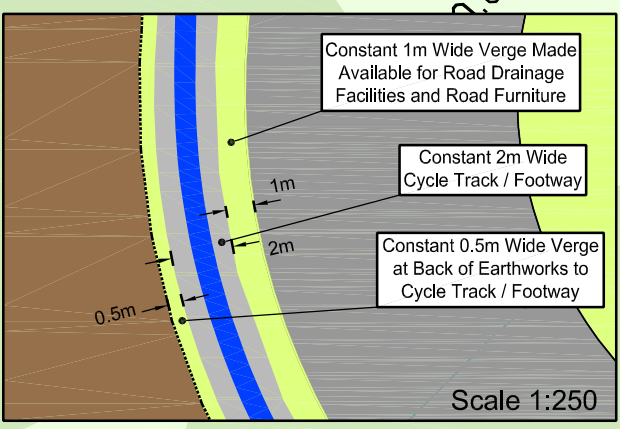
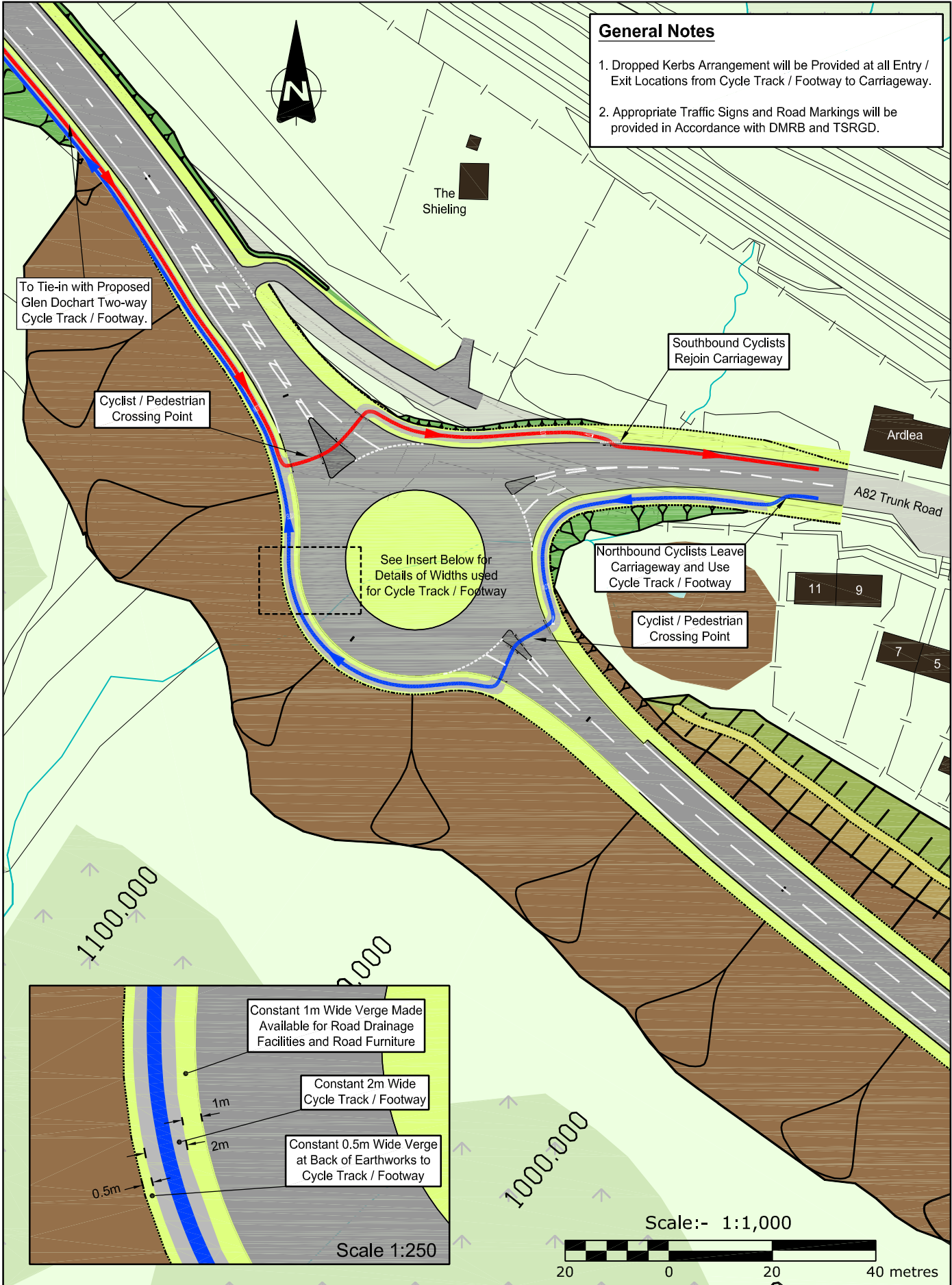

This map is based on Ordnance Survey material with the permission of Ordnance Survey on behalf of the Controller of Her Majesty's Stationary Office ©Crown copyright. Unauthorised reproduction infringes Crown copyright and may lead to prosecution or civil proceedings. Scottish Government 100020540 2008.

General Notes

1. Dropped Kerbs Arrangement will be Provided at all Entry / Exit Locations from Cycle Track / Footway to Carriageway.
2. Appropriate Traffic Signs and Road Markings will be provided in Accordance with DMRB and TSRGD.



Key:

	FOOTPATH PROVISION
	SOUTHBOUND CYCLE TRACK PROVISION
	NORTHBOUND CYCLE TRACK PROVISION

Drawn by: AAB Checked by: RJT Date: 07/09

A82 (T) Crianlarich Bypass
Figure 3.3b:
Cyclist and Pedestrian Provision at the North Roundabout
 Scales 1:1000, 1:250 at A4

