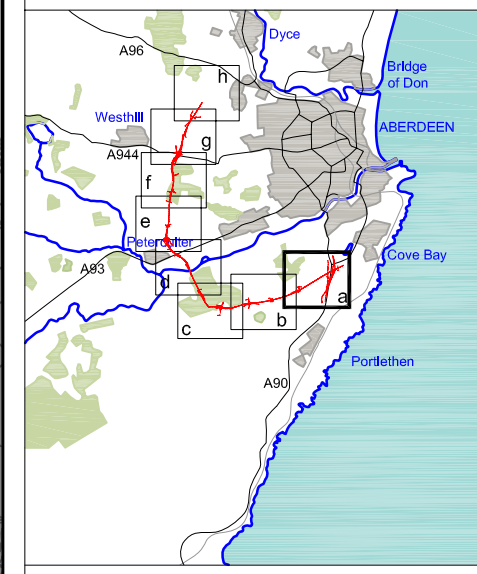
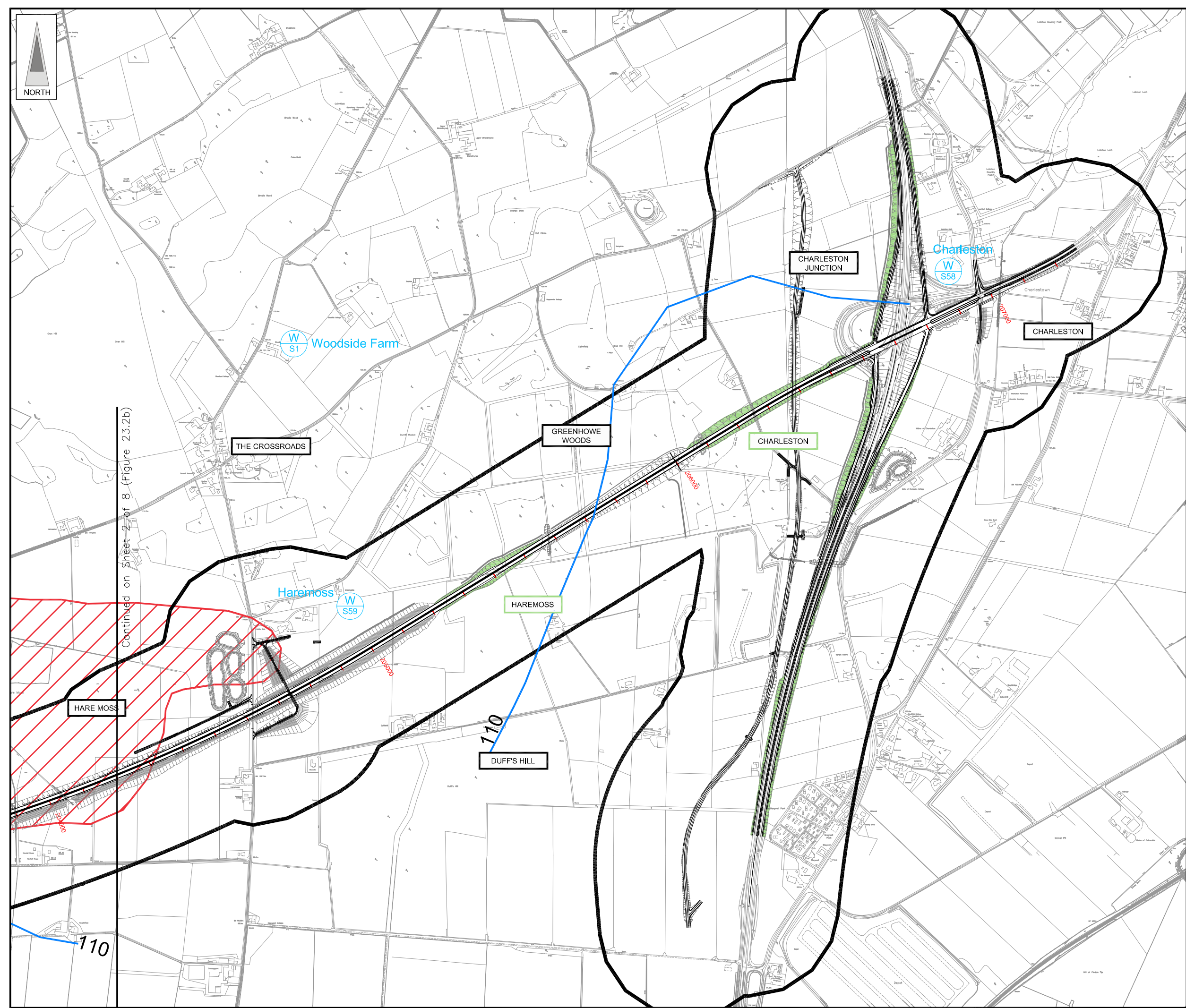

FIGURE 23.2a



- LEGEND**
- Proposed Route (Engineering Profile 04/05/07)
 - Indicative Study Area (250m from centre of Proposed Route)
 - Groundwater Contours (mAOD)
 - Excavated Areas
 - Private Groundwater Well Supply
 - Private Groundwater Well Supply (Location to be confirmed)*
 - Spring
 - Spring (Location to be confirmed)*
 - Areas noted as Peat on BGS Maps
 - Areas Historically noted as Wet
 - River Alluvium Deposits
 - Potential High Well Density Area
 - CLEANHILL Cutting Label

* Confirmation will be obtained following field work scheduled for July/June 2007.

Rev	Date	Purpose of Revision	Drwn	Chkd	Appd

JE JACOBS
 95 Bothwell Street, Glasgow, G2 7HX, UK
 Tel: 0141 204 2511 Fax: 0141 226 3109
 www.jacobstabtie.com

Client: **Aberdeen Western Peripheral Route**

Project: **Aberdeen Western Peripheral Route
 Environmental Statement, Part C - Southern Leg**

Title: **Hydrogeologically Related Features
 Sheet 1 of 8**

Drawing Status	FINAL	Revisions	
JB No.	0010332	Date	July 2007
Figure No.	FIGURE 23.2a	Checked	VSM
Scale	1:10,000	Approved	SH
Drawn	RB		

This drawing is not to be used in whole or part other than for the intended purpose and project as defined on this drawing. Refer to the contract for full terms and conditions. Maps produced by Jacobs UK Ltd. This map should NOT be rescaled. Copyright reserved.

This map is based on Ordnance Survey material with the permission of Ordnance Survey on behalf of the controller of Her Majesty's Stationary Office. Unauthorised reproduction infringes Crown copyright and may lead to prosecution or civil proceedings. Scottish Executive Licence Number, 100020540 (2007).

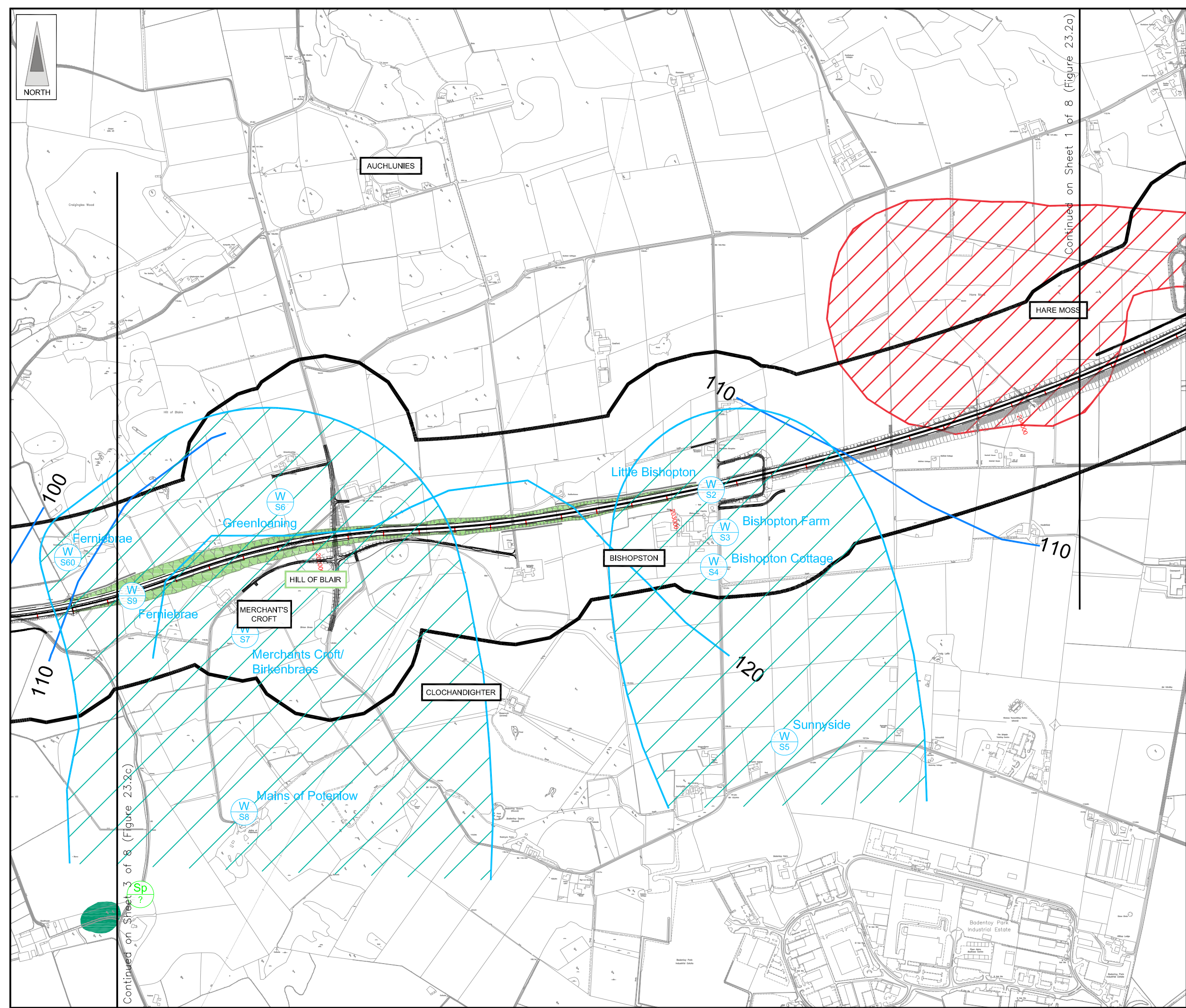
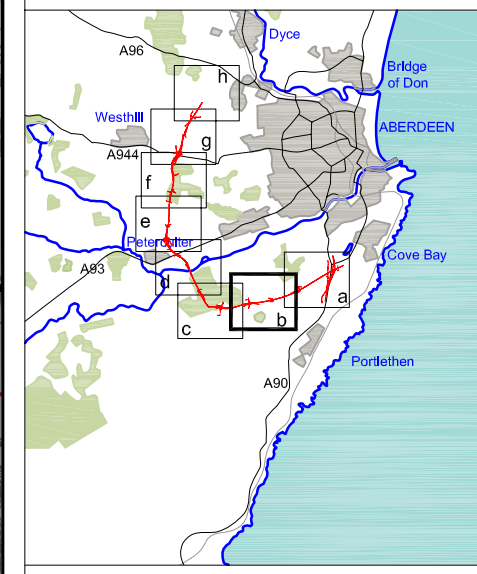

FIGURE 23.2b



- LEGEND**
- Proposed Route
(Engineering Profile 04/05/07)
 - Indicative Study Area
(250m from centre of Proposed Route)
 - Groundwater Contours
(mAOD)
 - Excavated Areas
 - Private Groundwater Well Supply
 - Private Groundwater Well Supply
(Location to be confirmed)*
 - Spring
 - Spring
(Location to be confirmed)*
 - Areas noted as Peat on BGS Maps
 - Areas Historically noted as Wet
 - River Alluvium Deposits
 - Potential High Well Density Area
 - CLEANHILL Cutting Label

* Confirmation will be obtained following field work scheduled for July/June 2007.

Rev	Date	Purpose of Revision	Drwn	Chkd	Appd

JE JACOBS
 95 Bothwell Street, Glasgow, G2 7HX, UK
 Tel: 0141 204 2511 Fax: 0141 226 3109
 www.jacobstabtie.com

Client: **Aberdeen Western Peripheral Route**

Project: **Aberdeen Western Peripheral Route
 Environmental Statement, Part C - Southern Leg**

Title: **Hydrogeologically Related Features
 Sheet 2 of 8**

Drawing Status	FINAL	Revisions	
JB No.	0010332	Date	July 2007
Figure No.	FIGURE 23.2b	Checked	VSM
Scale	1:10,000	Approved	SH
Drawn	RB		

This drawing is not to be used in whole or part other than for the intended purpose and project as defined on this drawing. Refer to the contract for full terms and conditions. Maps produced by Jacobs UK Ltd. This map should NOT be rescaled. Copyright reserved.

NORTH

Continued on Sheet 3 of 8 (Figure 23.2c)

Continued on Sheet 1 of 8 (Figure 23.2a)



This map is based on Ordnance Survey material with the permission of Ordnance Survey on behalf of the controller of Her Majesty's Stationery Office. Unauthorised reproduction infringes Crown copyright and may lead to prosecution or civil proceedings. Scottish Executive Licence Number, 100020540 (2007).

FIGURE 23.2c

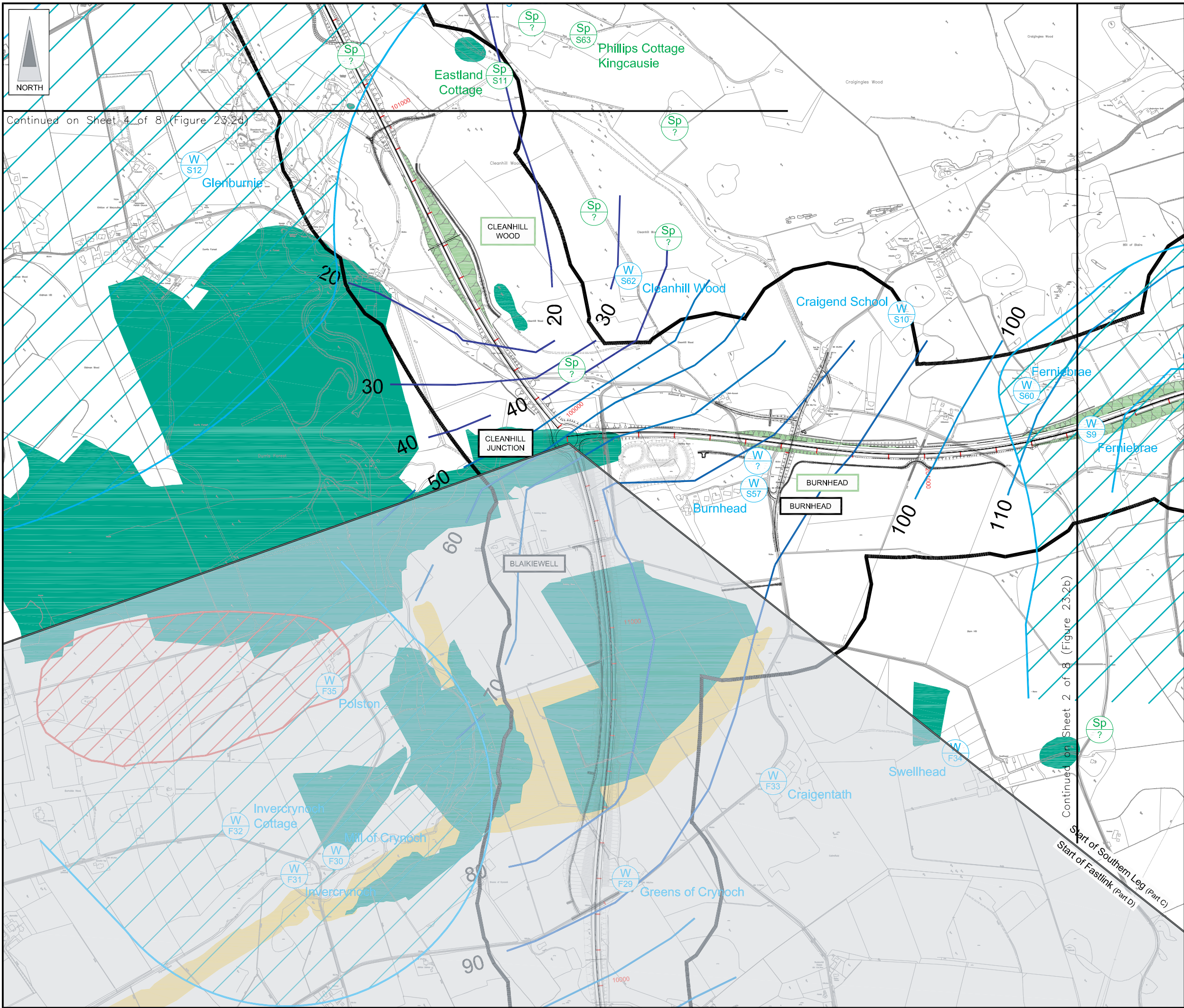
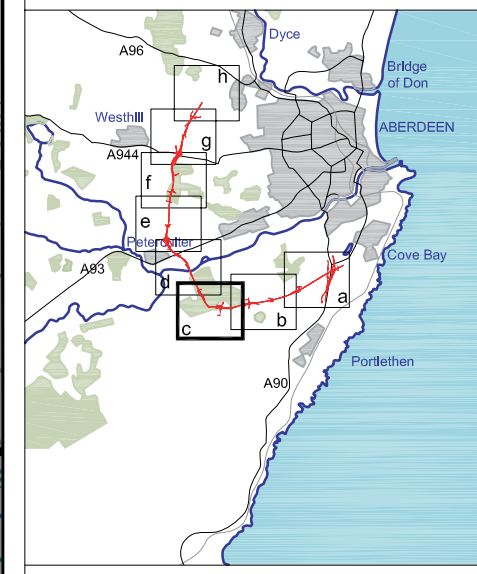

- LEGEND**
- Proposed Route (Engineering Profile 04/05/07)
 - Indicative Study Area (250m from centre of Proposed Route)
 - Groundwater Contours (mAOD)
 - Excavated Areas
 - Private Groundwater Well Supply
 - Private Groundwater Well Supply (Location to be confirmed)*
 - Spring
 - Spring (Location to be confirmed)*
 - Areas noted as Peat on BGS Maps
 - Areas Historically noted as Wet
 - River Alluvium Deposits
 - Potential High Well Density Area
 - Cutting Label

* Confirmation will be obtained following field work scheduled for July/June 2007.

Rev	Date	Purpose of Revision	Drwn	Chkd	Appd

JE JACOBS
 95 Bothwell Street, Glasgow, G2 7HX, UK
 Tel: 0141 204 2511 Fax: 0141 226 3109
 www.jacobsabtie.com

Client: **Aberdeen Western Peripheral Route**

Project: **Aberdeen Western Peripheral Route Environmental Statement, Part C - Southern Leg**

Title: **Hydrogeologically Related Features Sheet 3 of 8**

Drawing Status	FINAL	Revisions	
JB No.	0010332	Date	July 2007
Figure No.	FIGURE 23.2c	Checked	VSM
Scale	1:10,000	Approved	SH
Drawn	RB		

FIGURE 23.2d

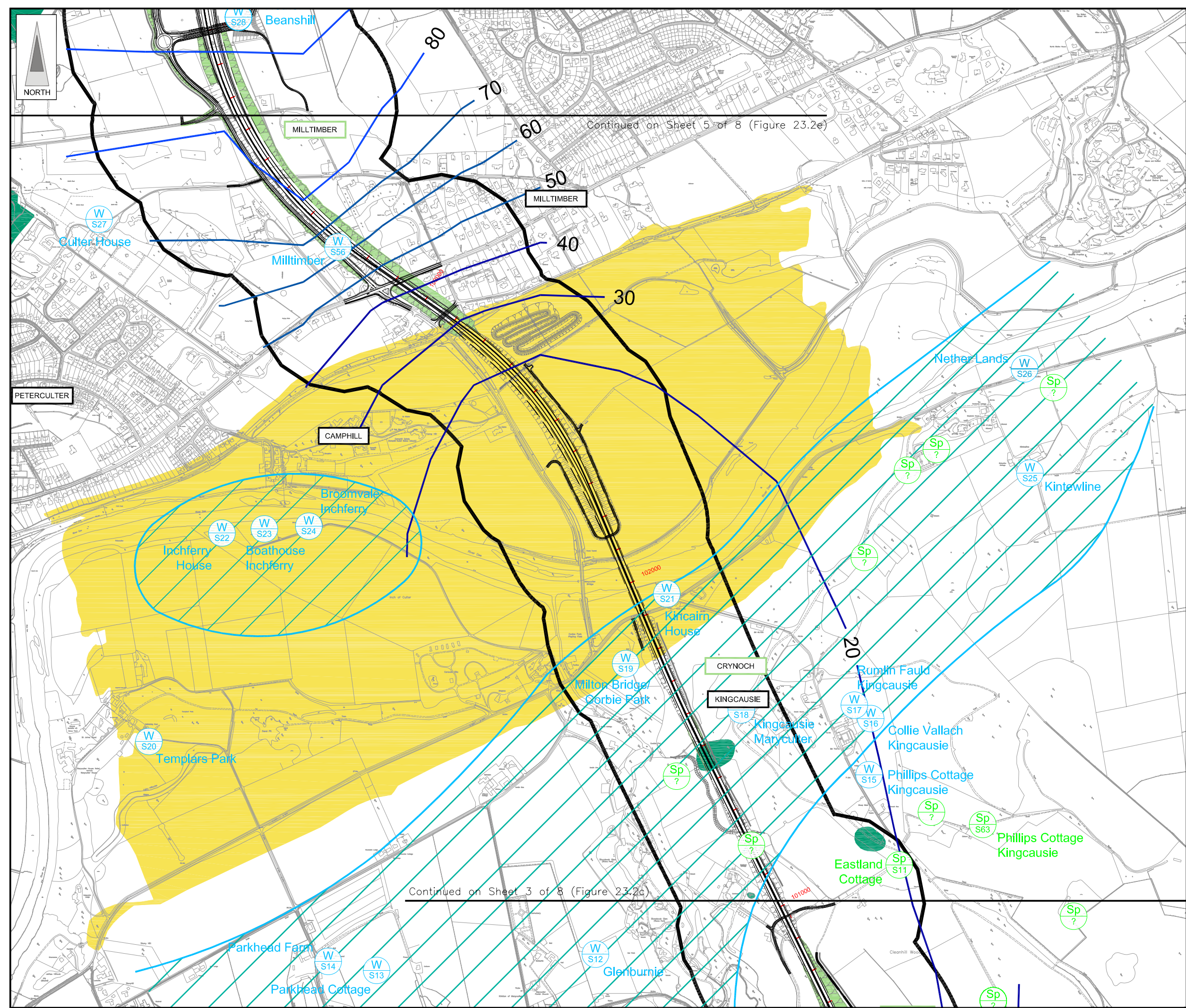
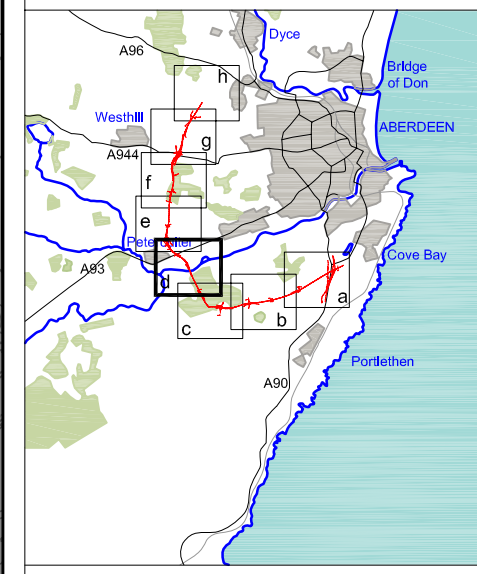

- LEGEND**
- Proposed Route (Engineering Profile 04/05/07)
 - Indicative Study Area (250m from centre of Proposed Route)
 - Groundwater Contours (mAOD)
 - Excavated Areas
 - Private Groundwater Well Supply
 - Private Groundwater Well Supply (Location to be confirmed)*
 - Spring
 - Spring (Location to be confirmed)*
 - Areas noted as Peat on BGS Maps
 - Areas Historically noted as Wet
 - River Alluvium Deposits
 - Potential High Well Density Area
 - CLEANHILL Cutting Label

* Confirmation will be obtained following field work scheduled for July/June 2007.

Rev	Date	Purpose of Revision	Drwn	Chkd	Appd

JE JACOBS
 95 Bothwell Street, Glasgow, G2 7HX, UK
 Tel: 0141 204 2511 Fax: 0141 226 3109
 www.jacobstablie.com

Client: **Aberdeen Western Peripheral Route**

Project: **Aberdeen Western Peripheral Route Environmental Statement, Part C - Southern Leg**

Title: **Hydrogeologically Related Features Sheet 4 of 8**

Drawing Status	FINAL	Revisions	
JB No.	0010332	Date	July 2007
Figure No.	FIGURE 23.2d	Checked	VSM
Scale	1:10,000	Approved	SH
Drawn	RB		

This drawing is not to be used in whole or part other than for the intended purpose and project as defined on this drawing. Refer to the contract for full terms and conditions. Maps produced by Jacobs UK Ltd. This map should NOT be rescaled. Copyright reserved.

This map is based on Ordnance Survey material with the permission of Ordnance Survey on behalf of the controller of Her Majesty's Stationary Office © Crown copyright. Unauthorised reproduction infringes Crown copyright and may lead to prosecution or civil proceedings. Scottish Executive Licence Number, 100020540 (2007).

FIGURE 23.2e

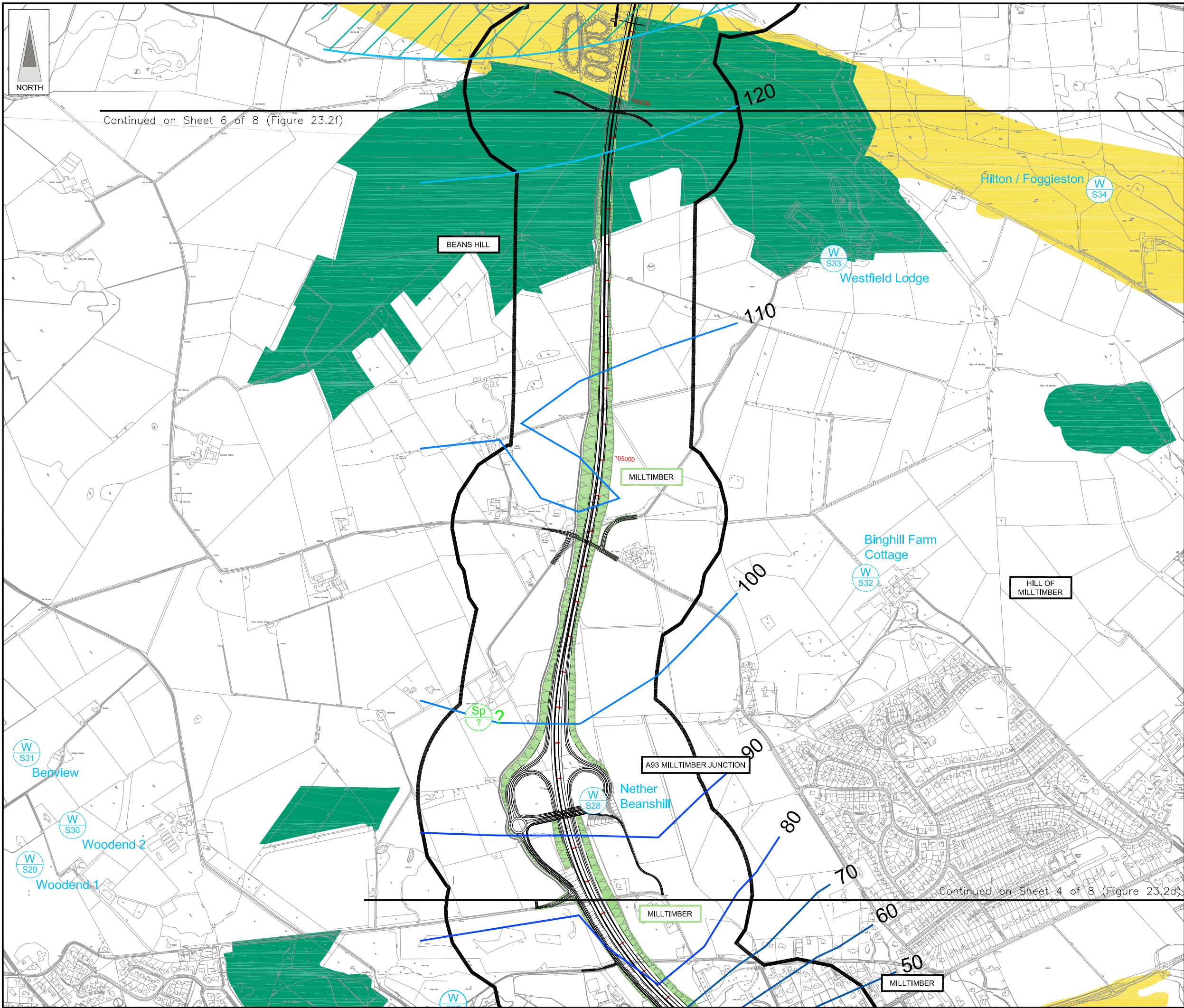
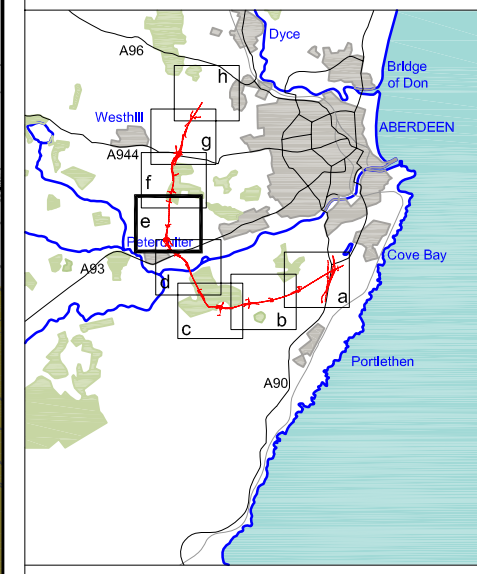

Continued on Sheet 6 of 8 (Figure 23.2f)

Continued on Sheet 4 of 8 (Figure 23.2d)

- LEGEND**
- Proposed Route (Engineering Profile 04/05/07)
 - Indicative Study Area (250m from centre of Proposed Route)
 - Groundwater Contours (mAOD)
 - Excavated Areas
 - Private Groundwater Well Supply
 - Private Groundwater Well Supply (Location to be confirmed)*
 - Spring
 - Spring (Location to be confirmed)*
 - Areas noted as Peat on BGS Maps
 - Areas Historically noted as Wet
 - River Alluvium Deposits
 - Potential High Well Density Area
 - Cutting Label

* Confirmation will be obtained following field work scheduled for July/June 2007.

Rev	Date	Purpose of Revision	Drwn	Chkd	Appd

JE JACOBS
 95 Bothwell Street, Glasgow, G2 7HX, UK
 Tel: 0141 204 2511 Fax: 0141 226 3109
 www.jacobstablie.com

Client: **Aberdeen Western Peripheral Route**

Project: **Aberdeen Western Peripheral Route Environmental Statement, Part C - Southern Leg**

Title: **Hydrogeologically Related Features Sheet 5 of 8**

Drawing Status	FINAL	Revisions	
JB No.	0010332	Date	July 2007
Figure No.	FIGURE 23.2e	Checked	VSM
Scale	1:10,000	Approved	SH
Drawn	RB		

FIGURE 23.2f

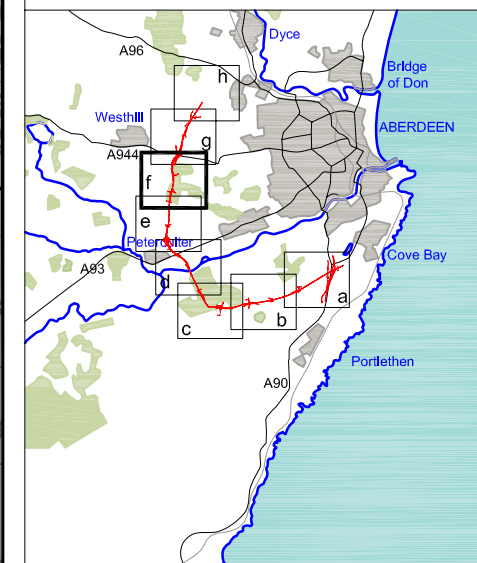
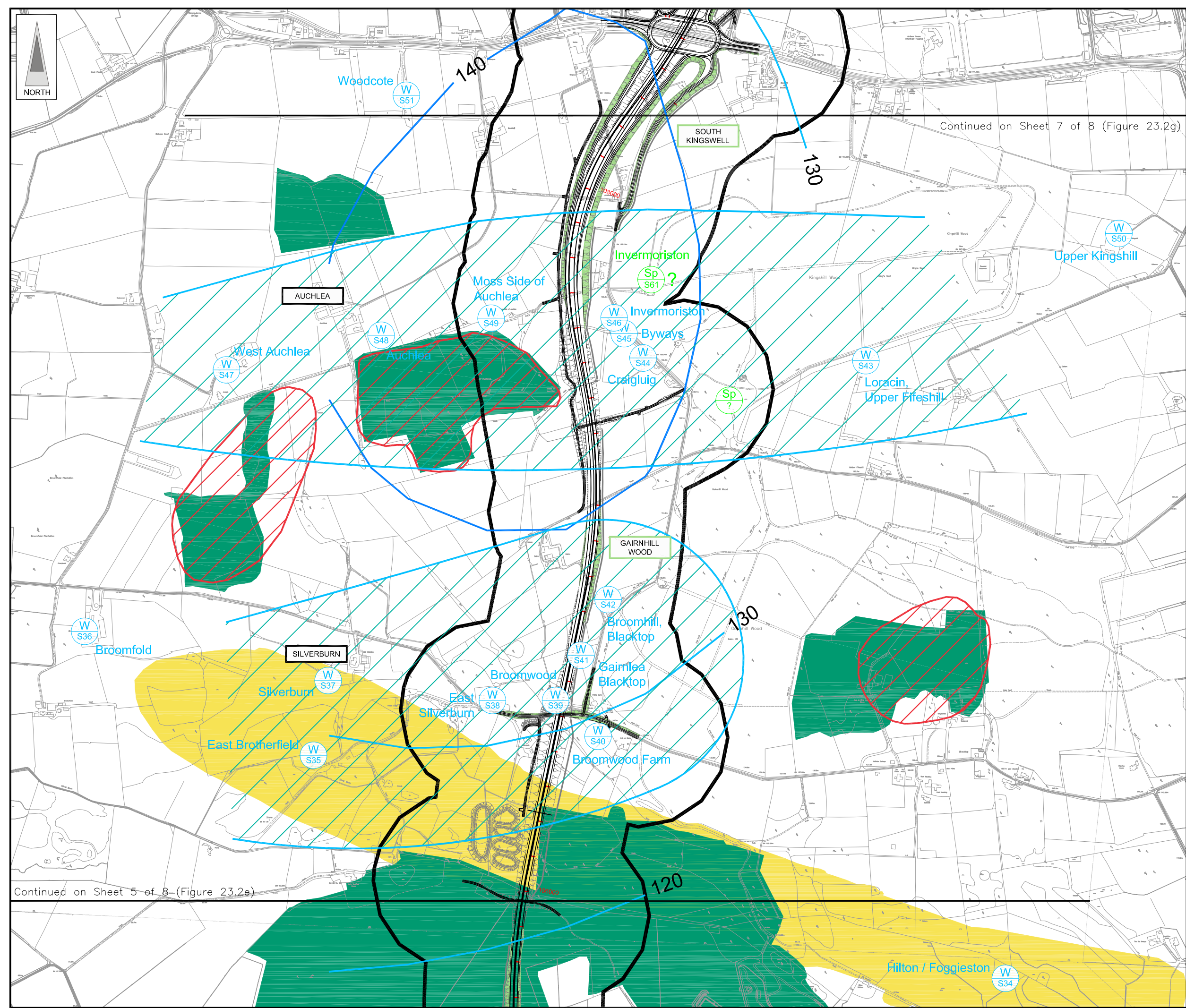

- LEGEND**
- Proposed Route (Engineering Profile 04/05/07)
 - Indicative Study Area (250m from centre of Proposed Route)
 - Groundwater Contours (mAOD)
 - Excavated Areas
 - Private Groundwater Well Supply
 - Private Groundwater Well Supply (Location to be confirmed)*
 - Spring
 - Spring (Location to be confirmed)*
 - Areas noted as Peat on BGS Maps
 - Areas Historically noted as Wet
 - River Alluvium Deposits
 - Potential High Well Density Area
 - CLEANHILL Cutting Label

* Confirmation will be obtained following field work scheduled for July/June 2007.

Rev	Date	Purpose of Revision	Drwn	Chkd	Appd

JE JACOBS
 95 Bothwell Street, Glasgow, G2 7HX, UK
 Tel: 0141 204 2511 Fax: 0141 226 3109
 www.jacobsbattle.com

Client: **Aberdeen Western Peripheral Route**

Project: **Aberdeen Western Peripheral Route Environmental Statement, Part C - Southern Leg**

Title: **Hydrogeologically Related Features Sheet 6 of 8**

Drawing Status	FINAL	Revisions	
JB No.	0010332	Date	July 2007
Figure No.	FIGURE 23.2f	Checked	VSM
Scale	1:10,000	Approved	SH
Drawn	RB	Checked	VSM
		Approved	SH

This drawing is not to be used in whole or part other than for the intended purpose and project as defined on this drawing. Refer to the contract for full terms and conditions. Maps produced by Jacobs UK Ltd. This map should NOT be rescaled. Copyright reserved.

Continued on Sheet 5 of 8 (Figure 23.2e)

Continued on Sheet 7 of 8 (Figure 23.2g)

FIGURE 23.2g

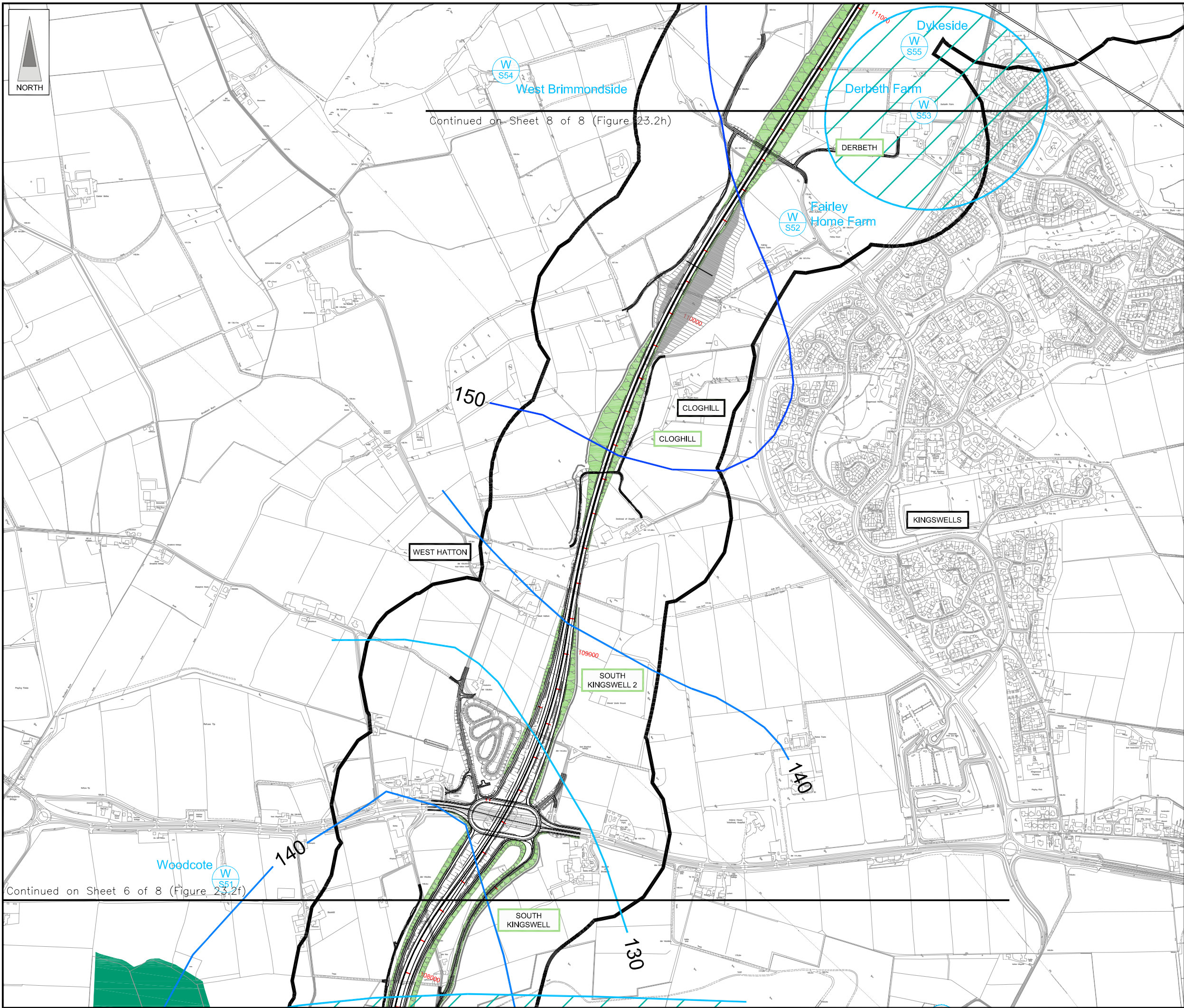
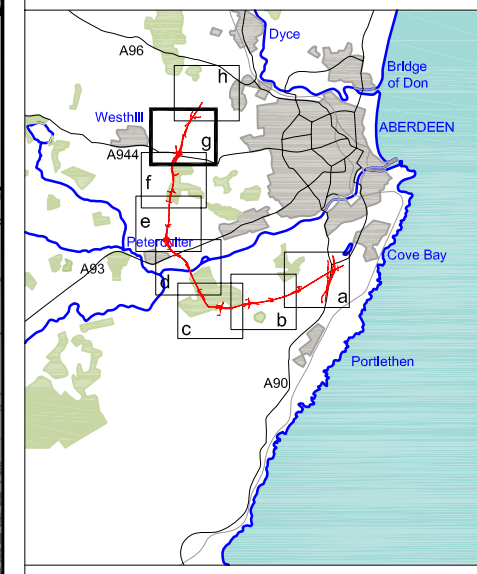

- LEGEND**
- Proposed Route (Engineering Profile 04/05/07)
 - Indicative Study Area (250m from centre of Proposed Route)
 - Groundwater Contours (mAOD)
 - Excavated Areas
 - Private Groundwater Well Supply
 - Private Groundwater Well Supply (Location to be confirmed)*
 - Spring
 - Spring (Location to be confirmed)*
 - Areas noted as Peat on BGS Maps
 - Areas Historically noted as Wet
 - River Alluvium Deposits
 - Potential High Well Density Area
 - CLEANHILL Cutting Label

* Confirmation will be obtained following field work scheduled for July/June 2007.

Rev	Date	Purpose of Revision	Drwn	Chkd	Appd

JE JACOBS
 95 Bothwell Street, Glasgow, G2 7HX, UK
 Tel: 0141 204 2511 Fax: 0141 226 3109
 www.jacobstabtie.com

Client: **Aberdeen Western Peripheral Route**









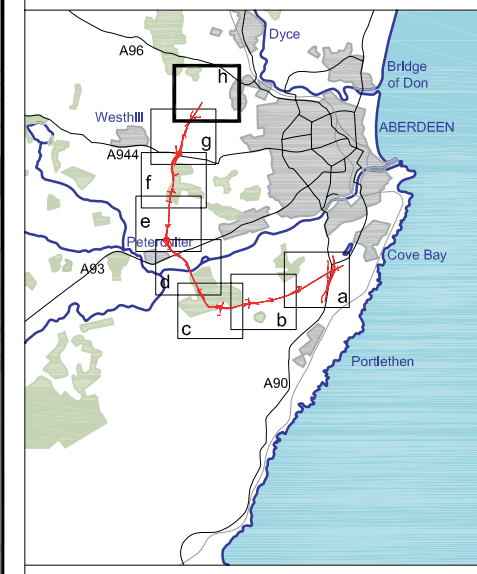



Project: **Aberdeen Western Peripheral Route Environmental Statement, Part C - Southern Leg**

Title: **Hydrogeologically Related Features Sheet 7 of 8**

Drawing Status	FINAL	Revisions	
JB No.	0010332	Date	July 2007
Figure No.	FIGURE 23.2g	Approved	SH
Scale	1:10,000	Checked	VSM
Drawn	RB	Approved	SH

FIGURE 23.2h



- LEGEND**
-  **Proposed Route**
(Engineering Profile 04/05/07)
 -  **Indicative Study Area**
(250m from centre of Proposed Route)
 -  **Groundwater Contours**
(mAOD)
 -  **Excavated Areas**
 -  **Private Groundwater Well Supply**
 -  **Private Groundwater Well Supply**
(Location to be confirmed)*
 -  **Spring**
 -  **Spring**
(Location to be confirmed)*
 -  **Areas noted as Peat on BGS Maps**
 -  **Areas Historically noted as Wet**
 -  **River Alluvium Deposits**
 -  **Potential High Well Density Area**
 -  **CLEANHILL** Cutting Label

* Confirmation will be obtained following field work scheduled for July/June 2007.

Rev	Date	Purpose of Revision	Drwn	Chkd	Appd

JE JACOBS
 95 Bothwell Street, Glasgow, G2 7HX, UK
 Tel: 0141 204 2511 Fax: 0141 226 3109
 www.jacobstabtle.com

Client: **Aberdeen Western Peripheral Route**

Project: **Aberdeen Western Peripheral Route Environmental Statement, Part C - Southern Leg**

Title: **Hydrogeologically Related Features Sheet 8 of 8**

Drawing Status	FINAL	Revisions	
JB No.	0010332	Date	July 2007
Figure No.	FIGURE 23.2h	Approved	SH
Scale	1:10,000	Checked	VSM
Drawn	RB	Signature	

Continued on Sheet 7 of 8 (Figure 23.2g)

This map is based on Ordnance Survey material with the permission of Ordnance Survey on behalf of the controller of Her Majesty's Stationery Office. Unauthorised reproduction infringes Crown copyright and may lead to prosecution or civil proceedings. Scottish Executive Licence Number, 100020540 (2007).