

Drawing number / Rev
B1033200/AW/590/01 Rev 1

Land Ref.	Owner	Lessees and Occupiers
590	Forestry Commission Silvan House 231 Corstorphine Road Edinburgh EH12 7AT	Please see relevant Accommodation Works Schedule

- Key**
- New Roads
 - 1/01 Accommodation Works Reference number as detailed in the Accommodation Works Schedule
 - Extent of Landowner Title
 - Land being acquired as part of Compulsory Purchase Order
 - Gate
 - Water trough
- Fencing:**
- Badger proof fence
 - Otter and badger proof fence
 - Post and rail fence
 - Post and wire fence
 - Drystone wall
 - Drystone wall with otter proof fence
 - Noise barrier/acoustic fence
 - Golf course fence

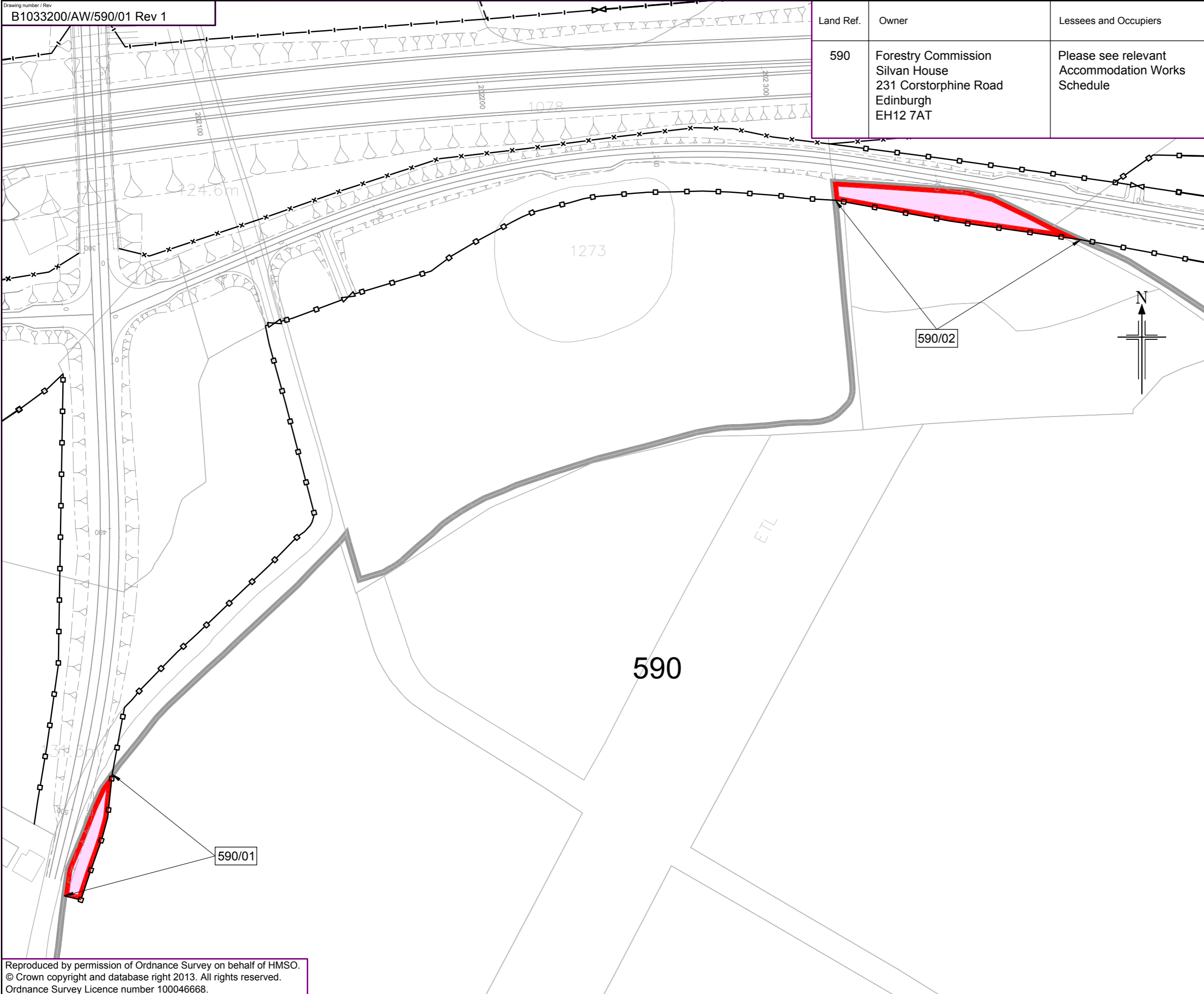

1	20/02/13	Boundary treatment fencing added	TF	DM	GJM	JML
0	15/04/09	Issued for Consultation	DT	AA		CWH
Rev	Rev. Date	Purpose of revision	Drawn	Checked	Rev'd	Appr'd

JACOBS
 85 Bothwell St, Glasgow, G2 7HX
 Tel: +44(0)141 243 8000 Fax: +44(0)141 228 3109
 www.jacobs.com

Aberdeen Western Peripheral Route
 Balmedie-Tipperty

Drawing title
**ACCOMMODATION WORKS
 FORESTRY COMMISSION
 SILVAN HOUSE
 LAND AREA REF. 590**

Drawing status
FOR DIALOGUE

Scale 1:1250 @ A3 DO NOT SCALE
 Jacobs No. B1033200

Drawing number **B1033200/AW/590/01** Rev **1**

Reproduced by permission of Ordnance Survey on behalf of HMSO.
 © Crown copyright and database right 2013. All rights reserved.
 Ordnance Survey Licence number 100046668.

This drawing is not to be used in whole or part other than for the intended purpose and project as defined on this drawing. Refer to the contract for full terms and conditions.

P:\Data\3001010332 - Aberdeen Western Peripheral Route\Project Data\Accommodation Works\2012 Issue\SL10332-AW-590-01 Rev 1.dwg - 03/12/2013 15:27 - A3 - Findlat