

Seven Acres

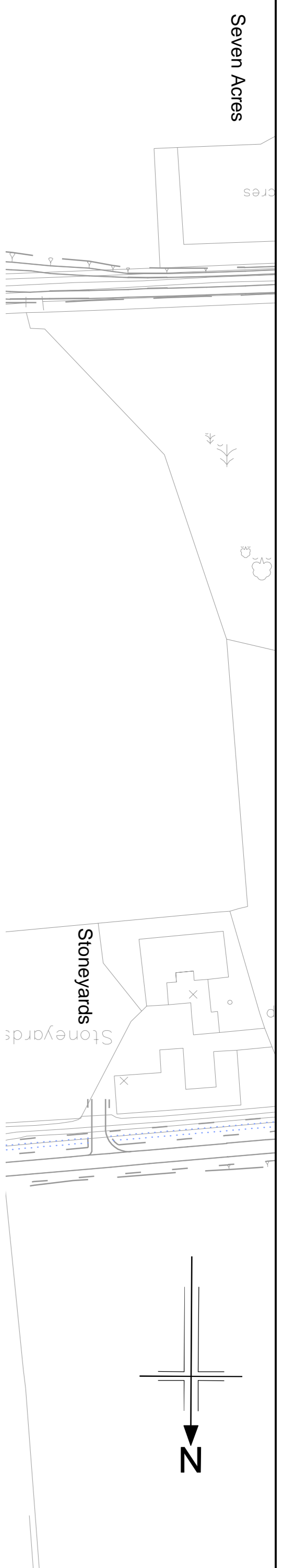

[Redacted]

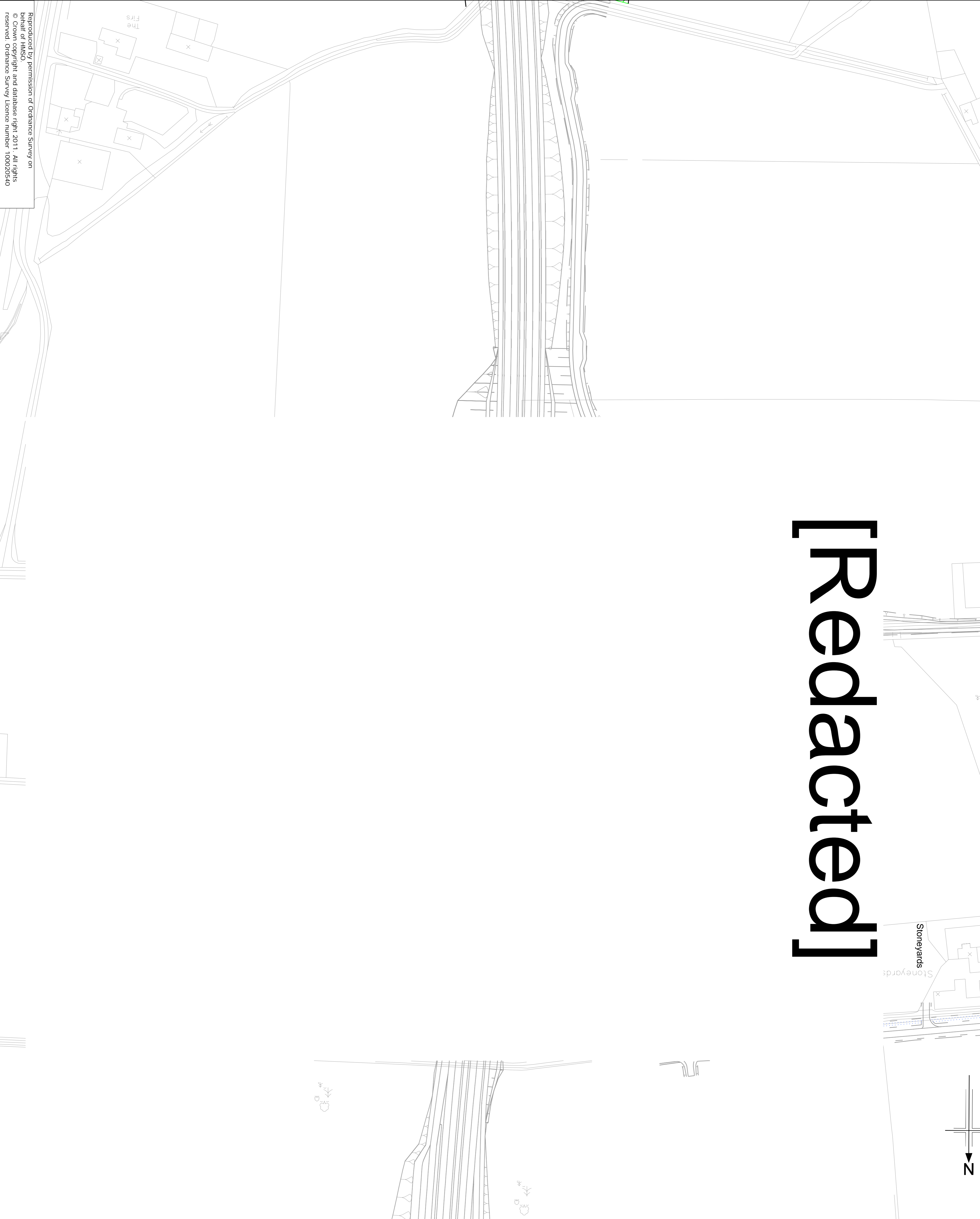

NOTES

- KEY:**
- Proposed Access Gate
 - Rylock & 3 Barb Fencing
 - Proposed Field Access
 - Proposed Ducts(Empy)
 - Proposed Troughs
 - CPO Boundary
 - Temporary Fencing
 - Close Barbed Fencing
 - Proposed Watercourse Crossing Point
- NOTES:**
- All proposed fencing to tie-in with existing boundaries or proposed adjoining fencing.
 - For fencing detail refer to drawing P246600/DET/2/10020 & P246600/DET/2/10027.
 - For access gate details refer to drawings P246600/DET/2/10018 & P246600/DET/2/10015.
 - Reconfiguration of pond system to be considered separately. Fencing to be reconsidered once pond design agreed.

Rev	Rev. Date	Drawn	Checked	Rev'd	Appr'd
0	07/02/13	SPW	RL	SPW	SAW

Grontmij 2nd Floor
 25 Popplefield Road
 ERF 43B
 781 444 01131 550 6300
 www.grontmij.co.uk

berdeen Western Peripheral Route
 Balmedie-Tipperary

**PROPOSED
 ACCOMMODATION WORKS
 [Redacted]**

FOR INFORMATION

Drawing title
 Scale @ A1 1:1000 DO NOT SCALE
 Drawing number **P246600/ACCO/2/14032**
 Rev **0**