

- NOTES**
- For ladder detail refer to Donyal structural drawings.
 - Bottom ladder rung to be spaced such as to limit the variation of the bottom rung to ground level to be no greater than +/- 15mm.
 - The gate lock to use the standardised key and be accessible from ground level.

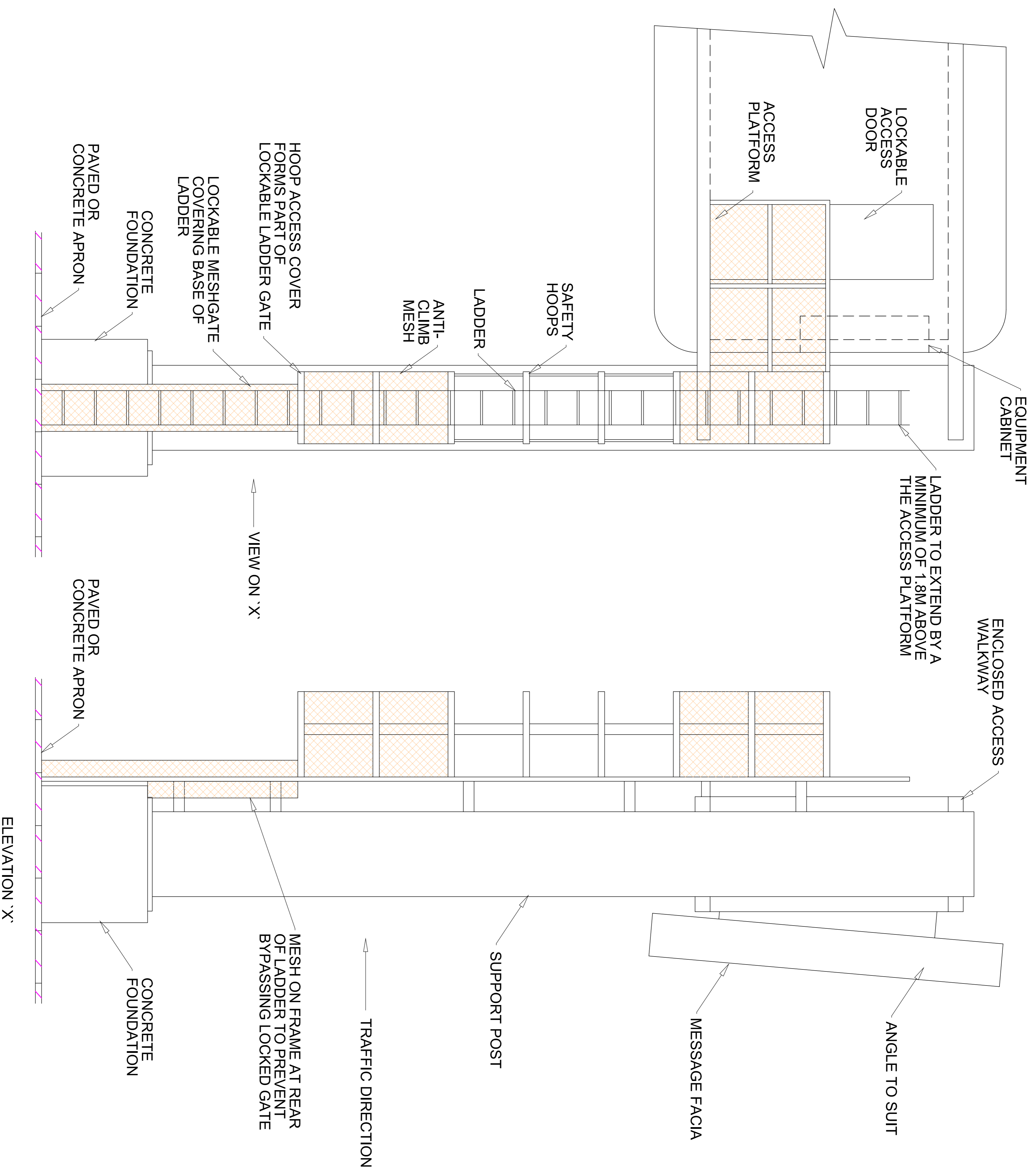

This drawing was generated on computer and must not be manually updated

Note:
The NDX series of drawings represents non site specific installations of standard equipment and site layouts.

TYPICAL CANTILEVER VARIABLE MESSAGE SIGNS LADDER ACCESS

ORIGINAL DRAWING SIZE: 297 X 420
ALL DIMENSIONS ARE IN MM
TOLERANCE +/- 1 UNLESS OTHERWISE STATED
THIRD ANGLE PROJECTION DO NOT SCALE

ISSUE	AMENDMENTS	APPD/DATE
DRN C.S.G. DATE 06/10/09	CHKD B.D. DATE 12/10/09	SCALE N.T.S.
B UPDATED SEE REV. SHT.		BD 30/11/09
A FIRST ISSUE		BD 12/10/09
DRG. NO. NDX1001-02ga		SHT. NO. 3 of 3