

THE SCOTTISH PARLIAMENT  
FORTH CROSSING BILL

Legend

- Permanent acquisition
- Acquisition of permanent rights
- Acquisition of temporary rights or temporary possession
- Land or rights in land held by the Scottish Ministers
- Extinguishment of rights other than ownership

Notes

1. The area enclosed by any plot or parcel of land is the area extending to the outer edge of the line marking the boundary of that plot or parcel of land.
2. These plans are to be read in conjunction with the Book of Reference and Schedules 9 and 10 of the Forth Crossing Bill.

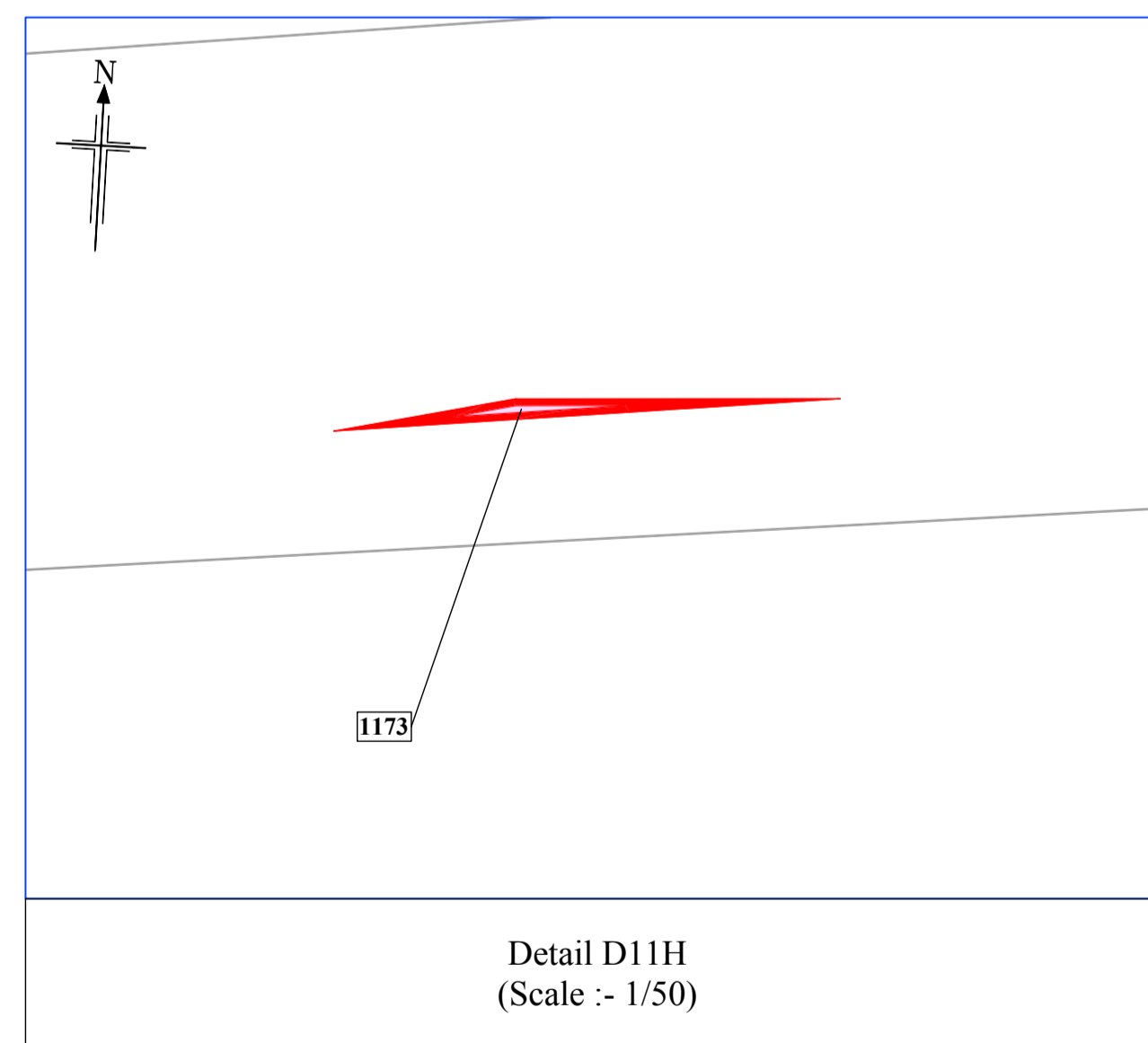
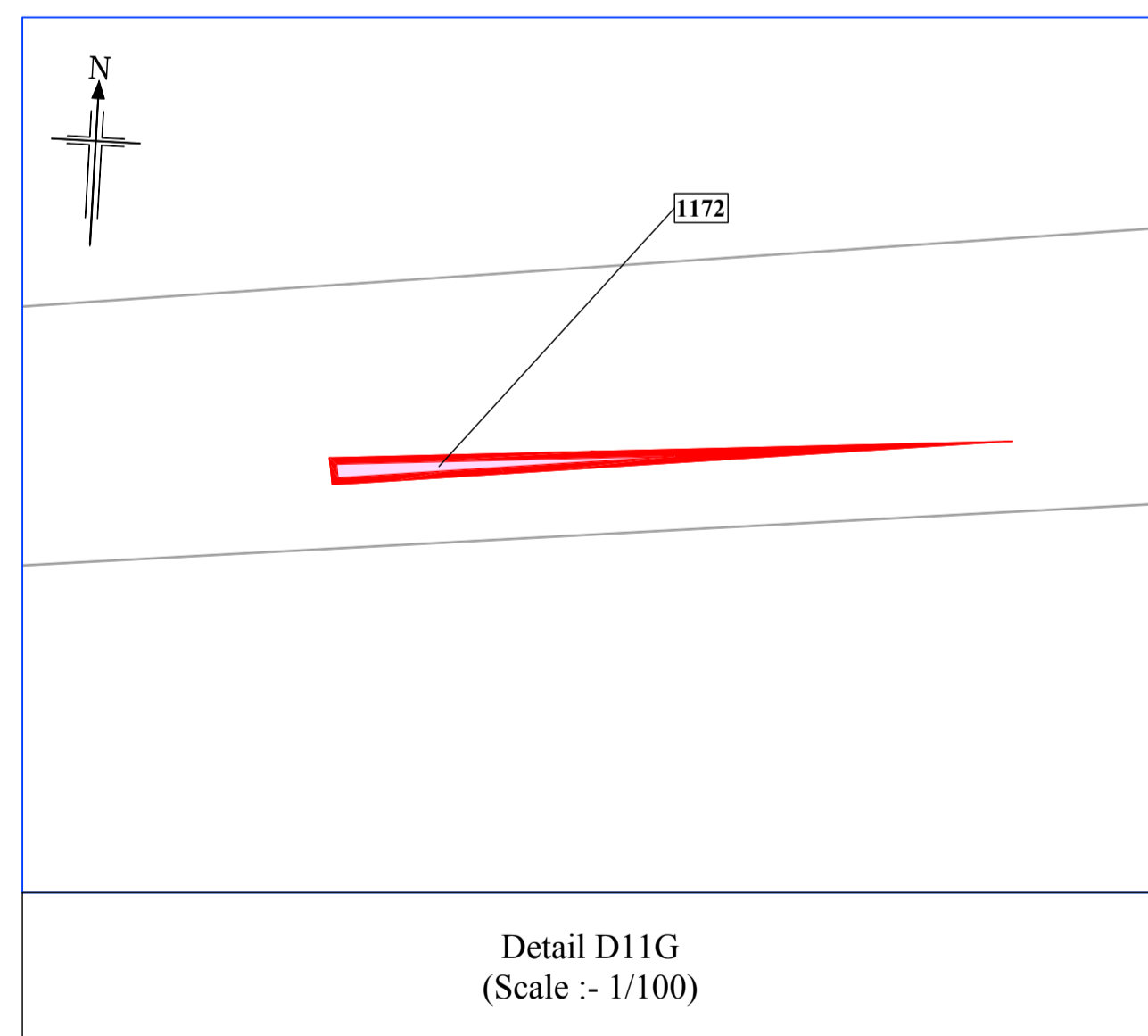
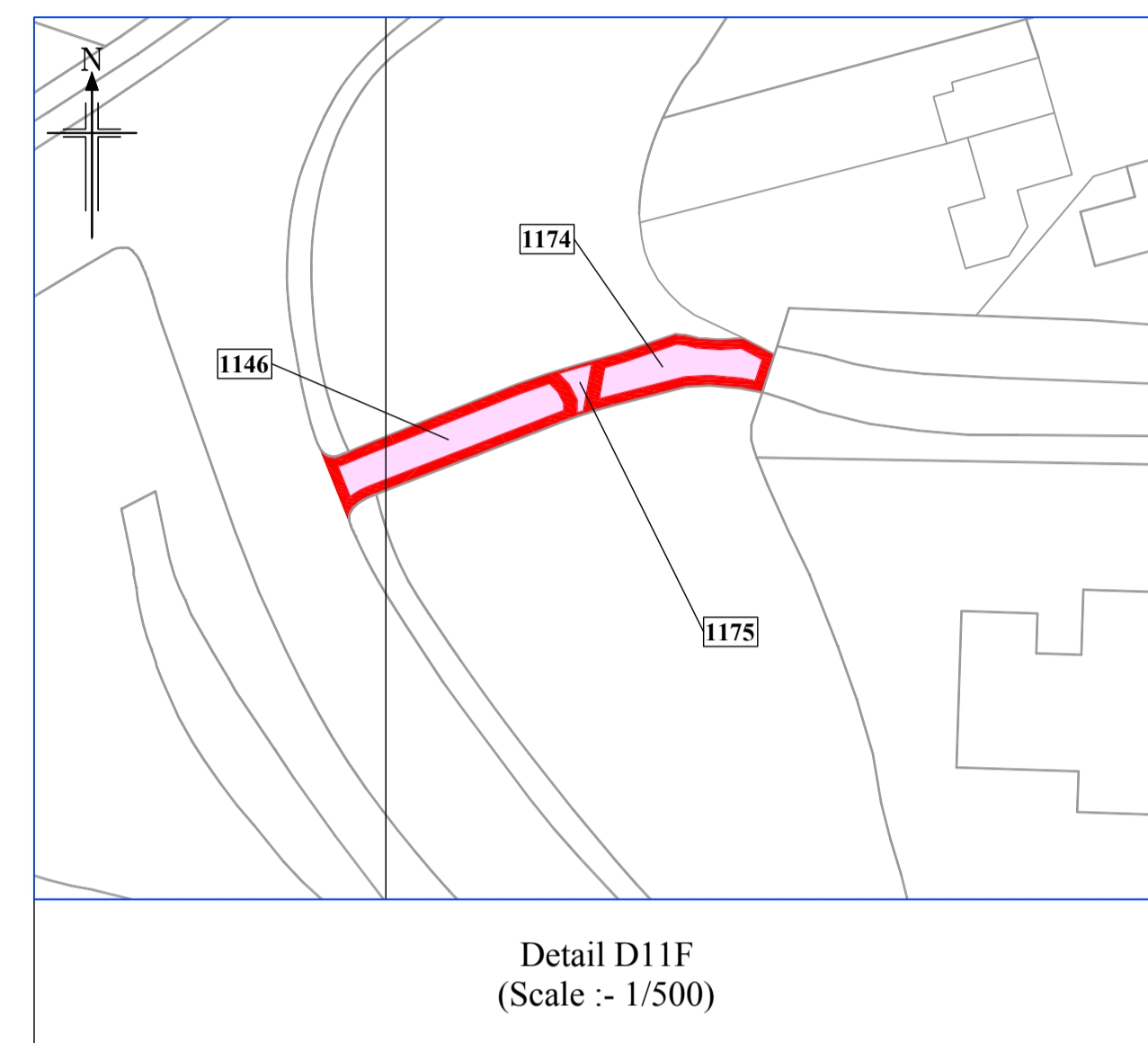
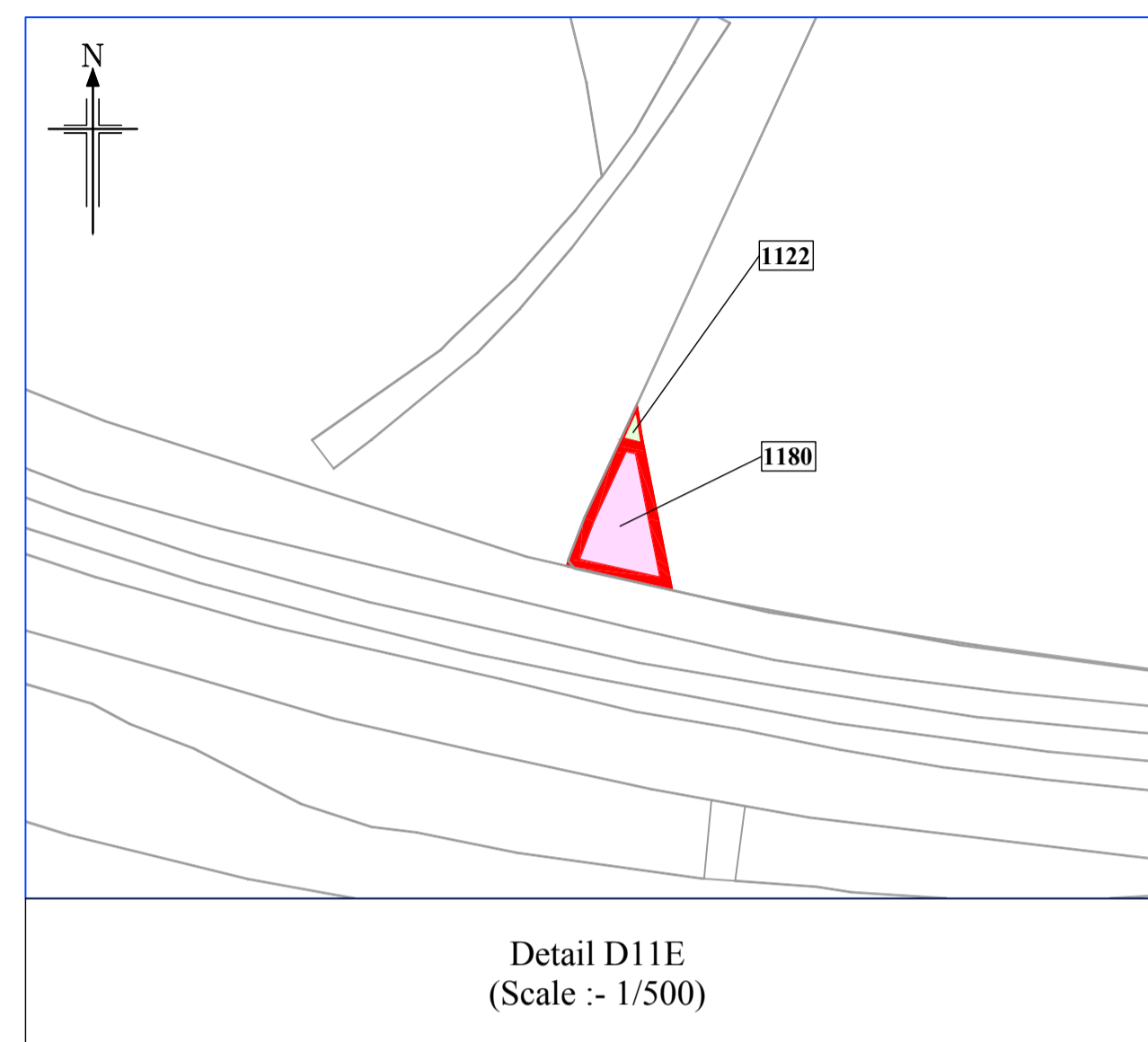
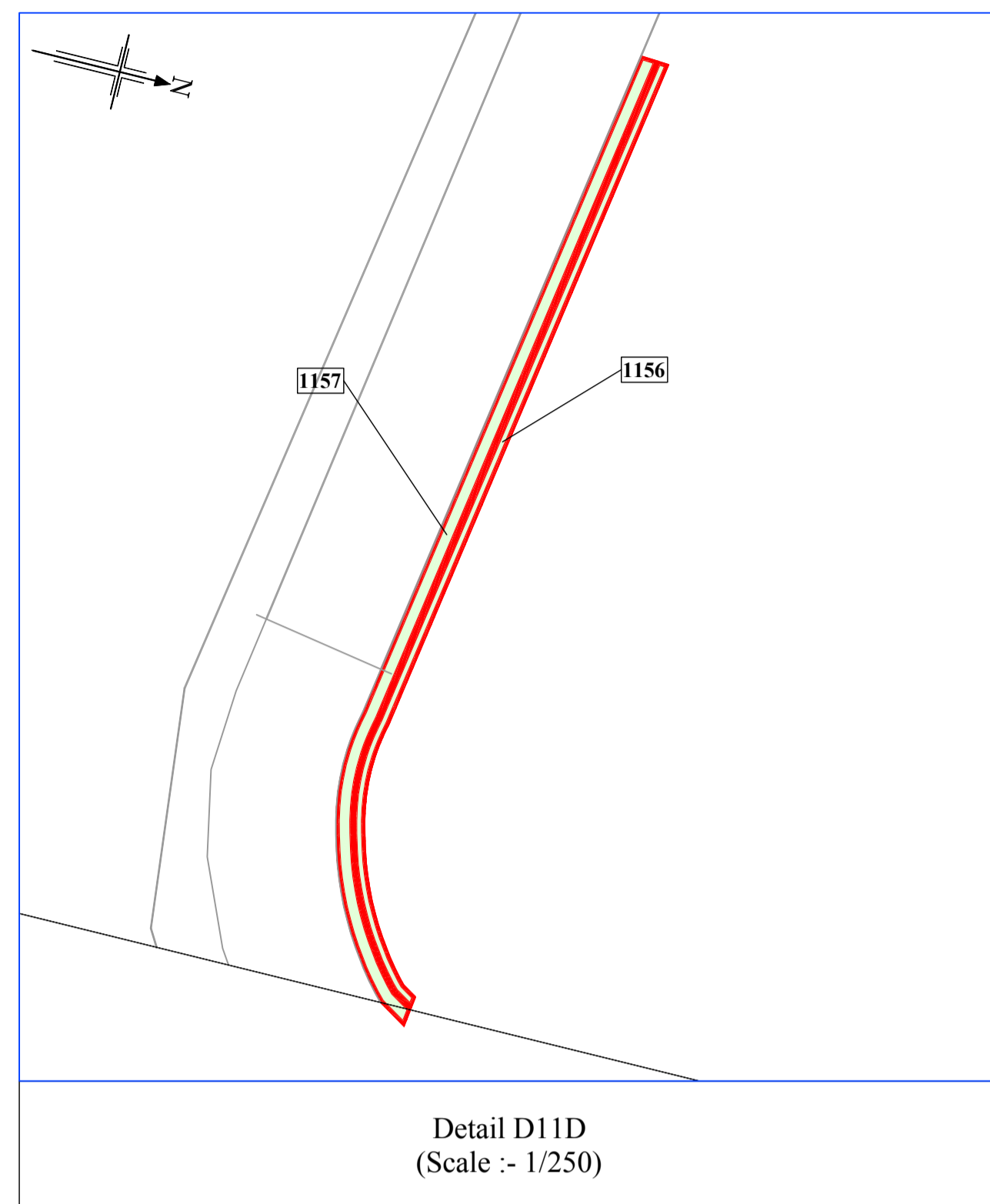

Key Plan

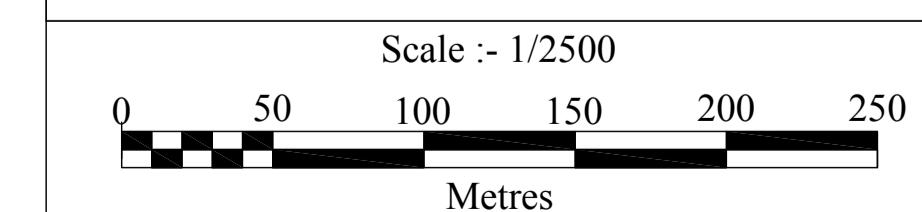
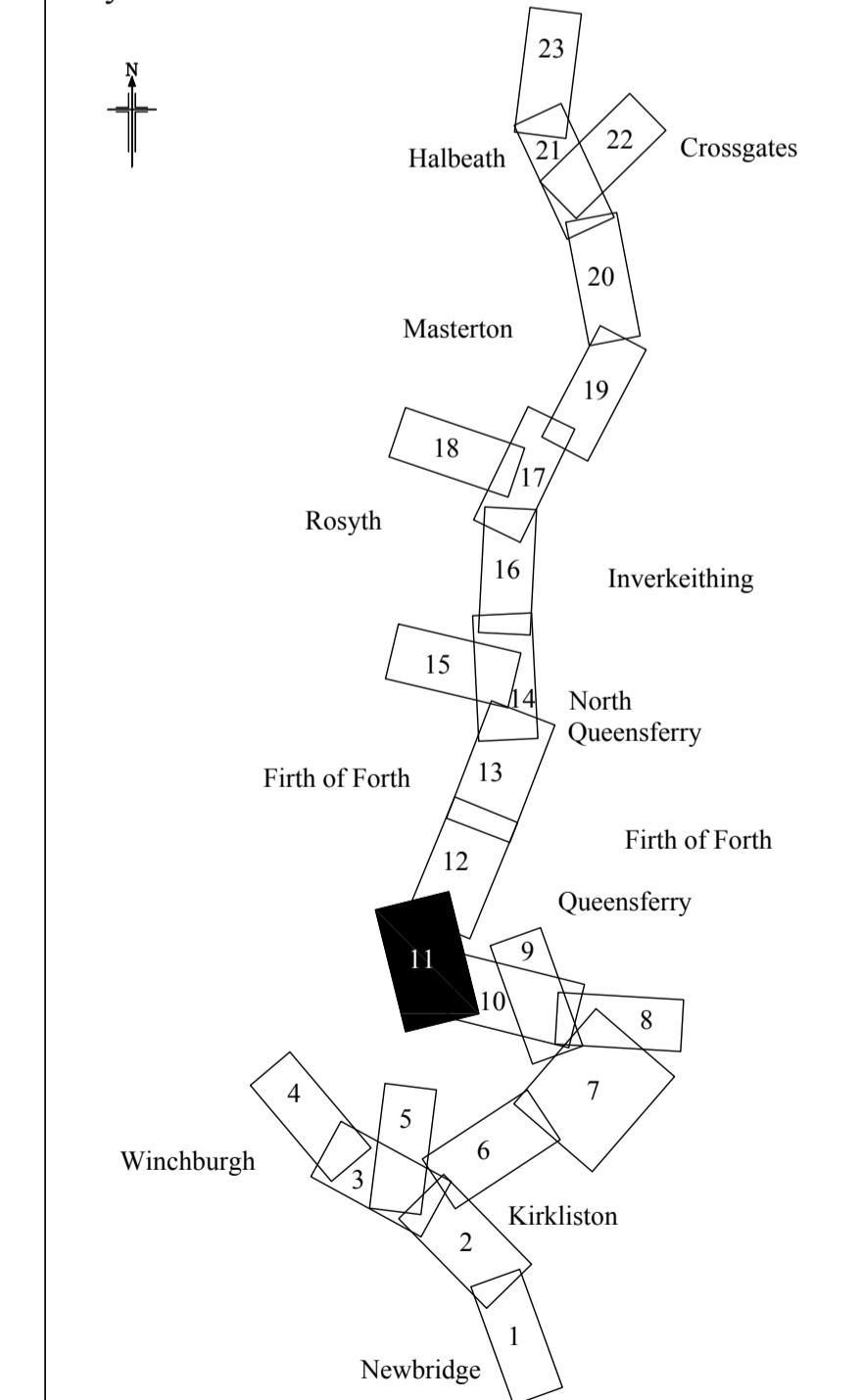

This map is based on Ordnance Survey material with the permission of Ordnance Survey on behalf of the Controller of Her Majesty's Stationery Office. © Crown copyright. Unauthorised reproduction infringes Crown copyright and may lead to prosecution or civil proceedings. Scottish Government 100020540 2009.