

This is the Plan referred to in the foregoing Notice of Extinction of Real Burdens and Servitudes by The Scottish Ministers

KEY



LAND TO BE CONVEYED FROM COLIN AND SHIRLEY TUCKER TO SCOTTISH MINISTERS



100
Millimetres
0 10
DO NOT SCALE

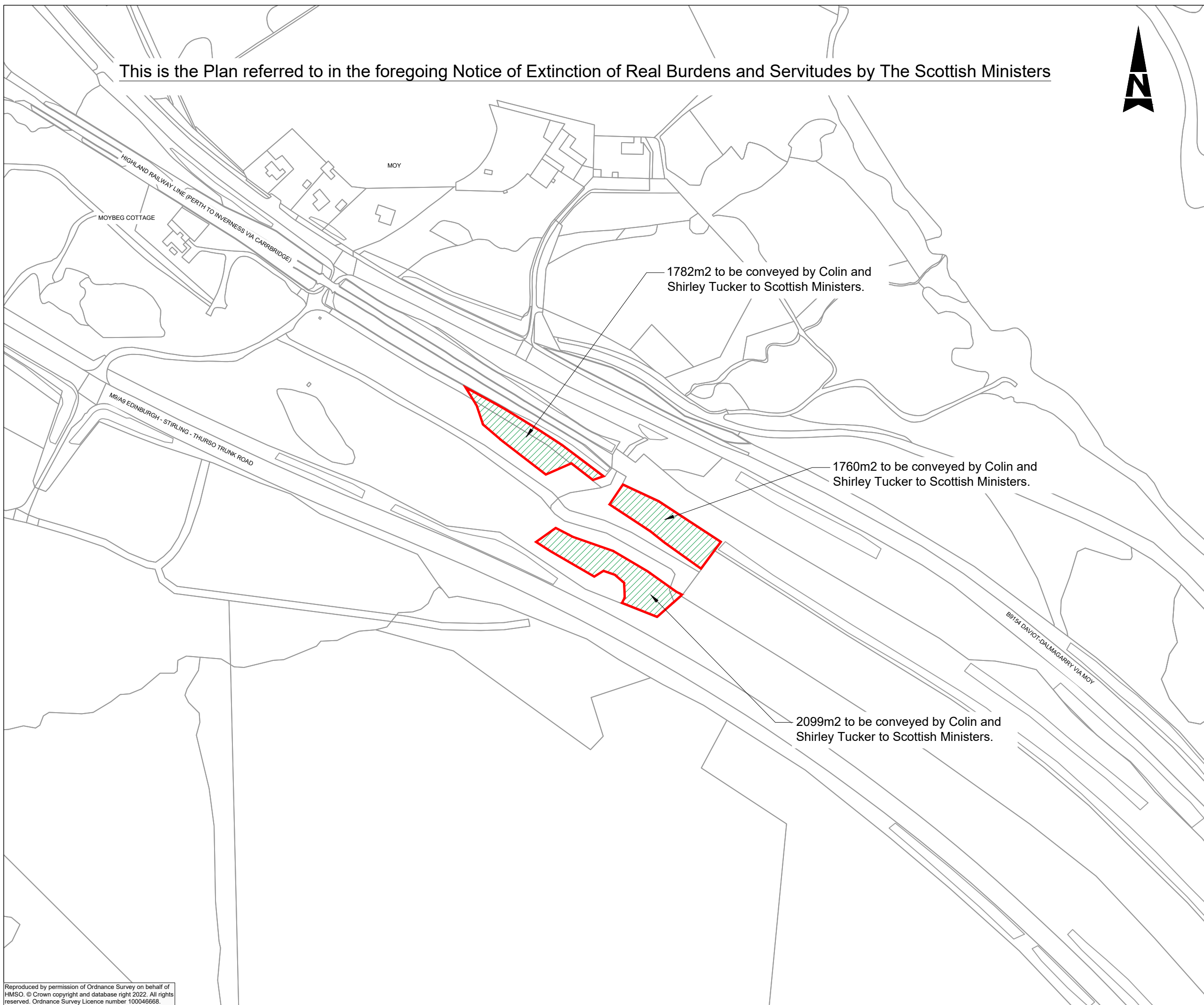

1782m2 to be conveyed by Colin and Shirley Tucker to Scottish Ministers.

1760m2 to be conveyed by Colin and Shirley Tucker to Scottish Ministers.

2099m2 to be conveyed by Colin and Shirley Tucker to Scottish Ministers.

P01	AK	RH	GA	17/09/21
-----	----	----	----	----------

TRANSPORT SCOTLAND ISSUE

P02	CR	AW	RH	19/07/22
-----	----	----	----	----------

SECTION 107 UPDATES

Rev	Drawn / Des	Checked	Approved	Date
-----	-------------	---------	----------	------

Description

Drawing Status	FOR INFORMATION	Suitability	S2
----------------	-----------------	-------------	----



ATKINS mouchel

Drawing Title
LAND TO BE CONVEYED FROM COLIN AND SHIRLEY TUCKER TO SCOTTISH MINISTERS

Scale	1:2500	Designed / Drawn	CR	Checked	AW	Approved	RH	Authorised	BF
Original Size	A3	Date	19/07/22	Date	19/07/22	Date	19/07/22	Date	19/07/22

Drawing Number	Project	Originator	Volume	Revision
	A9P12 - AMJ - HAC - A_ZZZZ_AC - DR - RD - 0005			P02
Location	Type	Role	Number	

Plotted: Jul 19, 2022 - 12:31pm by: UKRXH602

Reproduced by permission of Ordnance Survey on behalf of HMSO. © Crown copyright and database right 2022. All rights reserved. Ordnance Survey Licence number 100046668.