

DALRADDY TO SLOCHD (SHEET 3 of 5)
INDICATIVE ROUTE OPTIONS

WIDENING TO NORTHBOUND SIDE

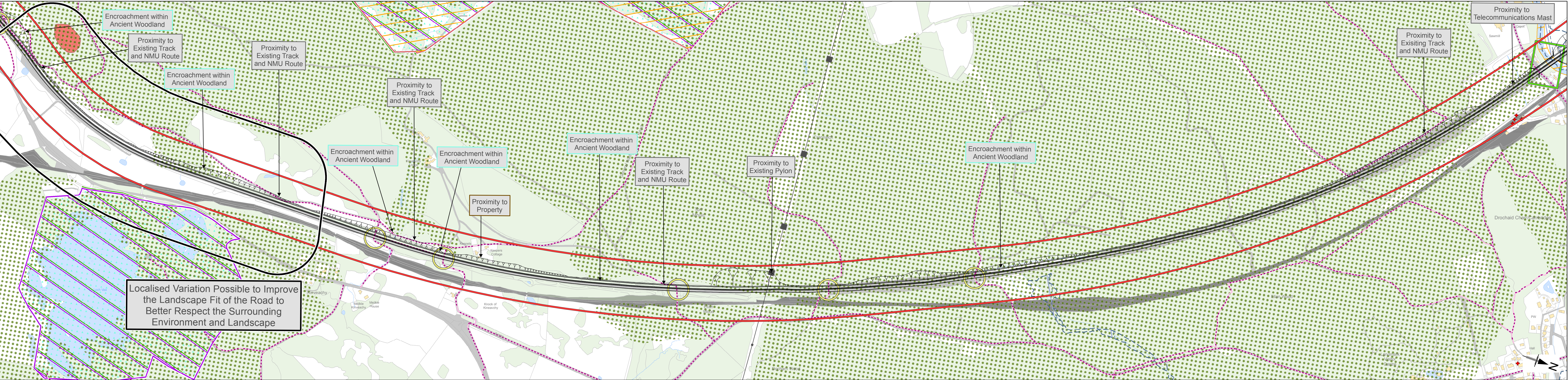

WIDENING TO BOTH SIDES

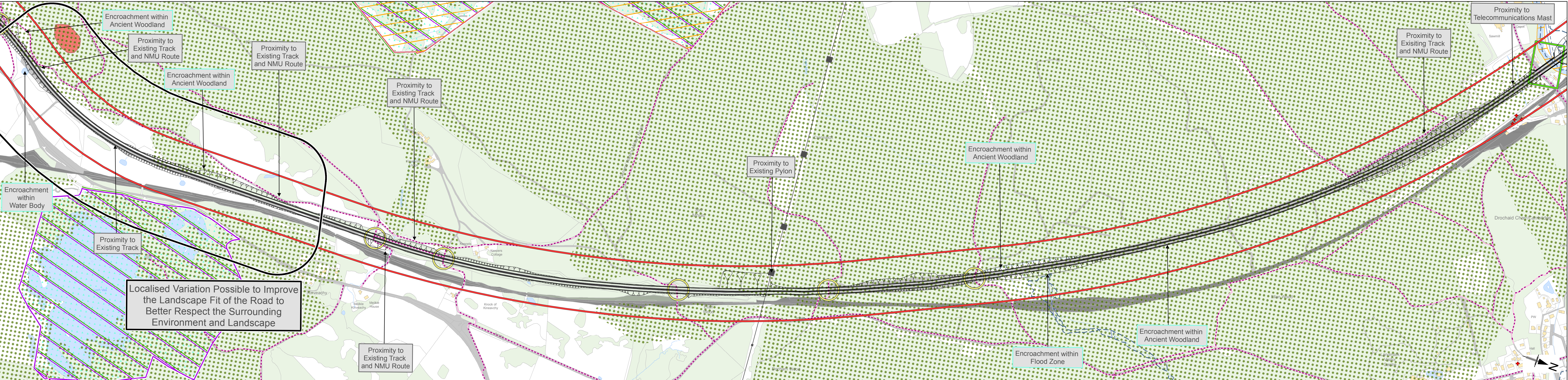

WIDENING TO SOUTHBOUND SIDE

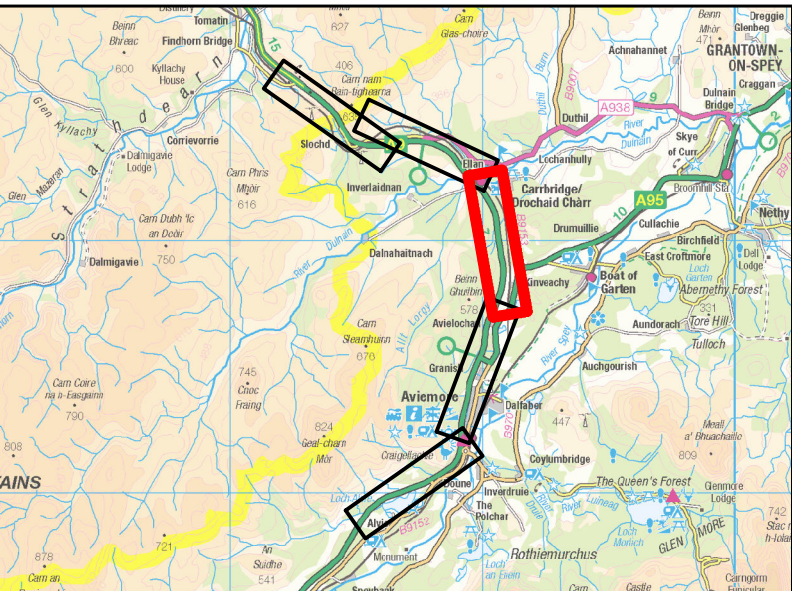

Legend - Constraints

- Proposed Scheme
- Cutting
- Embankment
- 200m Wide Corridor
- Proposed Structure
- Existing Structure
- Existing Junction/Access
- Existing Pylons
- Proposed Pylons
- Snow Gate
- Building
- Roads and Tracks
- Non - Motorised User Route (Pedestrian, Cyclist and Equestrian Routes)
- Railway
- Listed Building
- Scheduled Monument
- Conservation Area
- Gardens and Designed Landscapes
- Battlefield Sites
- Site of Special Scientific Interest (SSSI)
- Special Protection Area (SPA)
- Special Area of Conservation (SAC)
- Wetlands of International Importance (Ramsar)
- National Nature Reserve
- Geological Conservation Review Site
- Ancient Woodland Inventory
- Woodland
- RSPB Reserve
- Important Bird Area
- River/Stream/Loch
- SEPA 1 in 100 year Fluvial Flood Zone
- Cairngorms National Park Boundary
- National Scenic Areas

Legend - Annotation

- Information
- Infrastructure
- Environment
- Property

Notes

- While still indicative at this stage, the main A9 Dual Carriageway is likely to be within the illustrated 200m wide corridor. However, side roads, junctions and other associated works will be required beyond this zone.