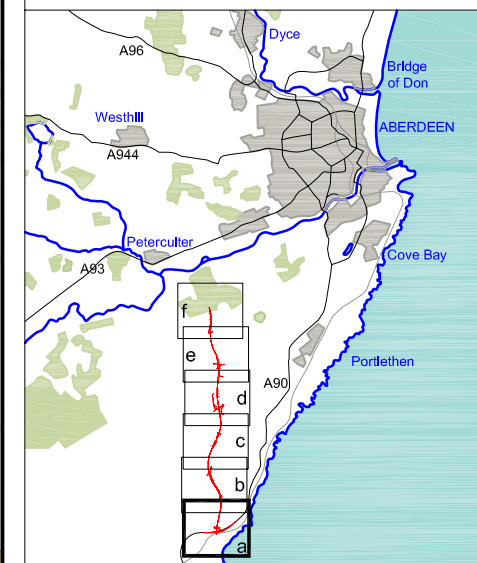
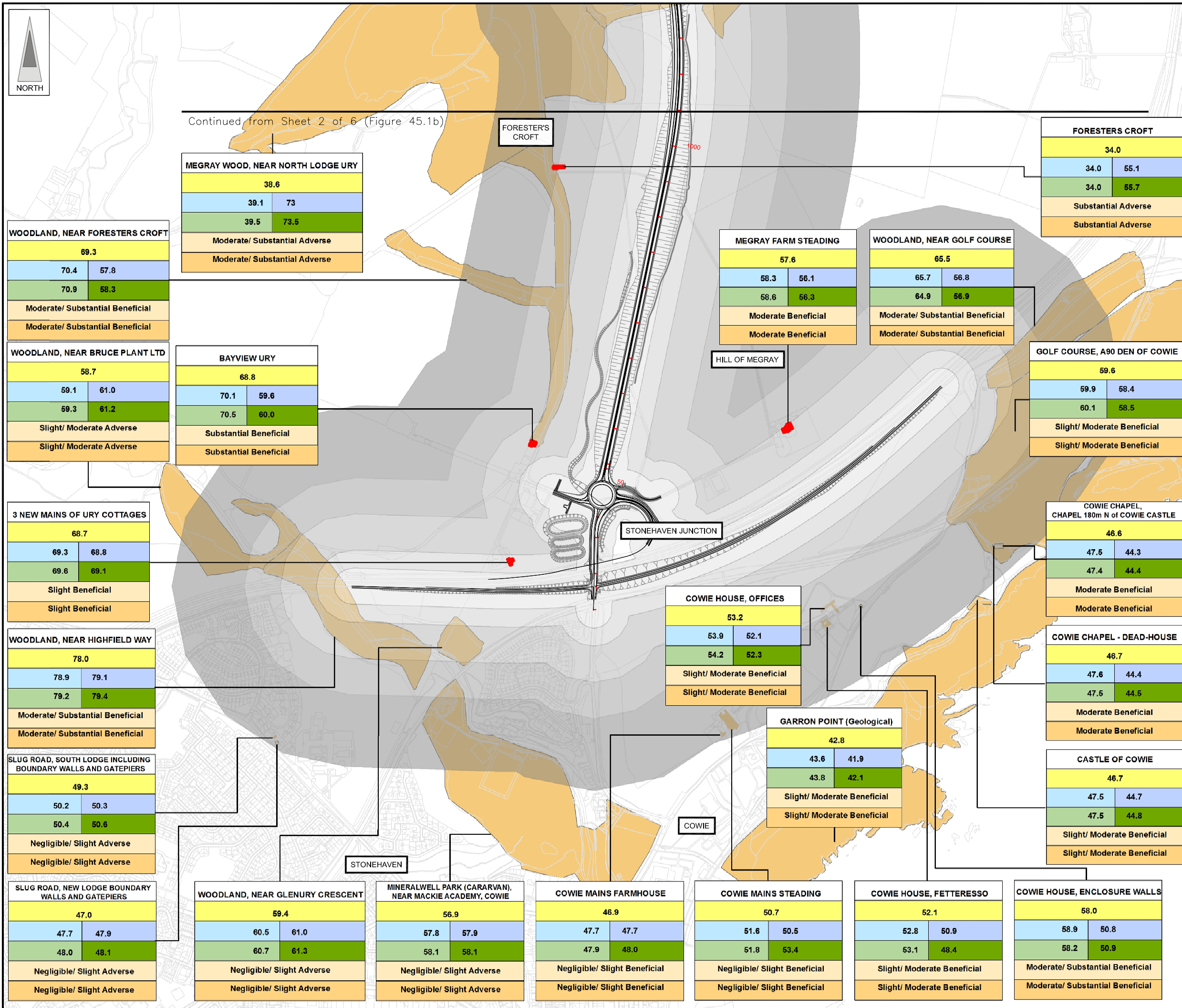

FIGURE 45.1a



LEGEND

- Proposed Route (Engineering Profile 04/05/07)
- 0-50m
- >50-100m
- >100-200m
- >200-300m
- >300-500m
- Sample Properties
- Non Residential Receptors

Location Name	
BASE 2005	
Do Minimum Year of Opening	Do Something Year of Opening
Do Minimum Design Year	Do Something Design Year
SIGNIFICANCE OF IMPACT Year of Opening	
SIGNIFICANCE OF IMPACT Design Year	

JE JACOBS
 95 Bothwell Street, Glasgow, G2 7HX, UK
 Tel: 0141 204 2511 Fax: 0141 226 3109
 www.jacobsbabtie.com

Hamilton & McGregor
 ACUSTICS DIVISION

Client	Aberdeen Western Peripheral Route	
Project	Aberdeen Western Peripheral Route Environmental Statement, Part D - Fastlink	
Title	Predicted LA10(18hours) dB without Mitigation (Receiver Height = 1.5m) Sheet 1 of 6	
Drawing Status	FINAL	
JB No.	0010332	Revisions
Figure No.	FIGURE 45.1a	Approved
Scale	1:10,000	Date July 2007
Drawn	RB	Checked
		BMcK
		SH

FIGURE 45.1b

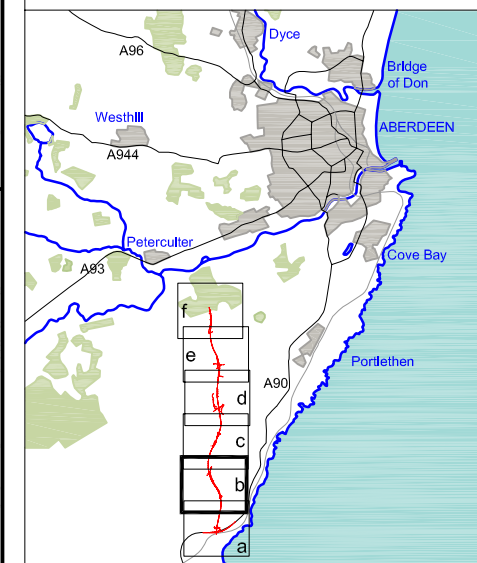

LEGEND

- Proposed Route (Engineering Profile 04/05/07)
- 0-50m
- >50-100m contour symbol"/> >50-100m
- >100-200m contour symbol"/> >100-200m
- >200-300m contour symbol"/> >200-300m
- >300-500m contour symbol"/> >300-500m
- Sample Properties
- Non Residential Receptors

Location Name	
BASE 2005	
Do Minimum Year of Opening	Do Something Year of Opening
Do Minimum Design Year	Do Something Design Year
SIGNIFICANCE OF IMPACT Year of Opening	
SIGNIFICANCE OF IMPACT Design Year	

JE JACOBS
 95 Bothwell Street, Glasgow, G2 7HX, UK
 Tel: 0141 204 2511 Fax: 0141 226 3109
 www.jacobsbabtie.com

Hamilton & McGregor
 ACOUSTICS DIVISION

Client: Aberdeen Western Peripheral Route

Project: Aberdeen Western Peripheral Route
 Environmental Statement, Part D - Fastlink

Title: Predicted LA10(18hours) dB without Mitigation (Receiver Height = 1.5m)
 Sheet 2 of 6

Drawing Status	FINAL	Revisions	
JB No.	0010332	Date	July 2007
Figure No.	FIGURE 45.1b	Checked	BMCK
Scale	1:10,000	Approved	SH
Drawn	RB	Signature	

This drawing is not to be used in whole or part other than for the intended purpose and project as defined on this drawing. Refer to the contract for full terms and conditions. Maps produced by Jacobs UK Ltd. This map should NOT be rescaled. Copyright reserved.

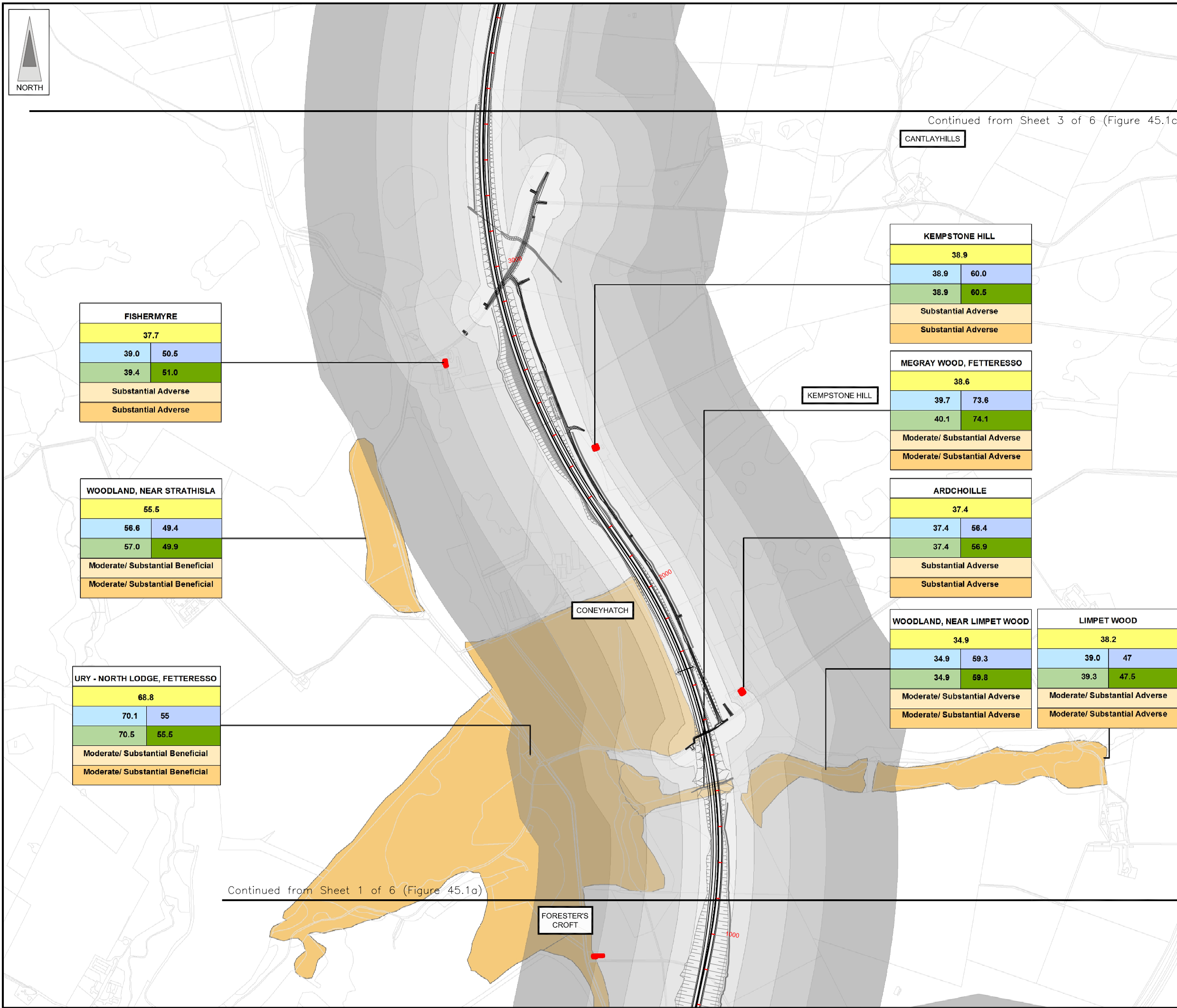
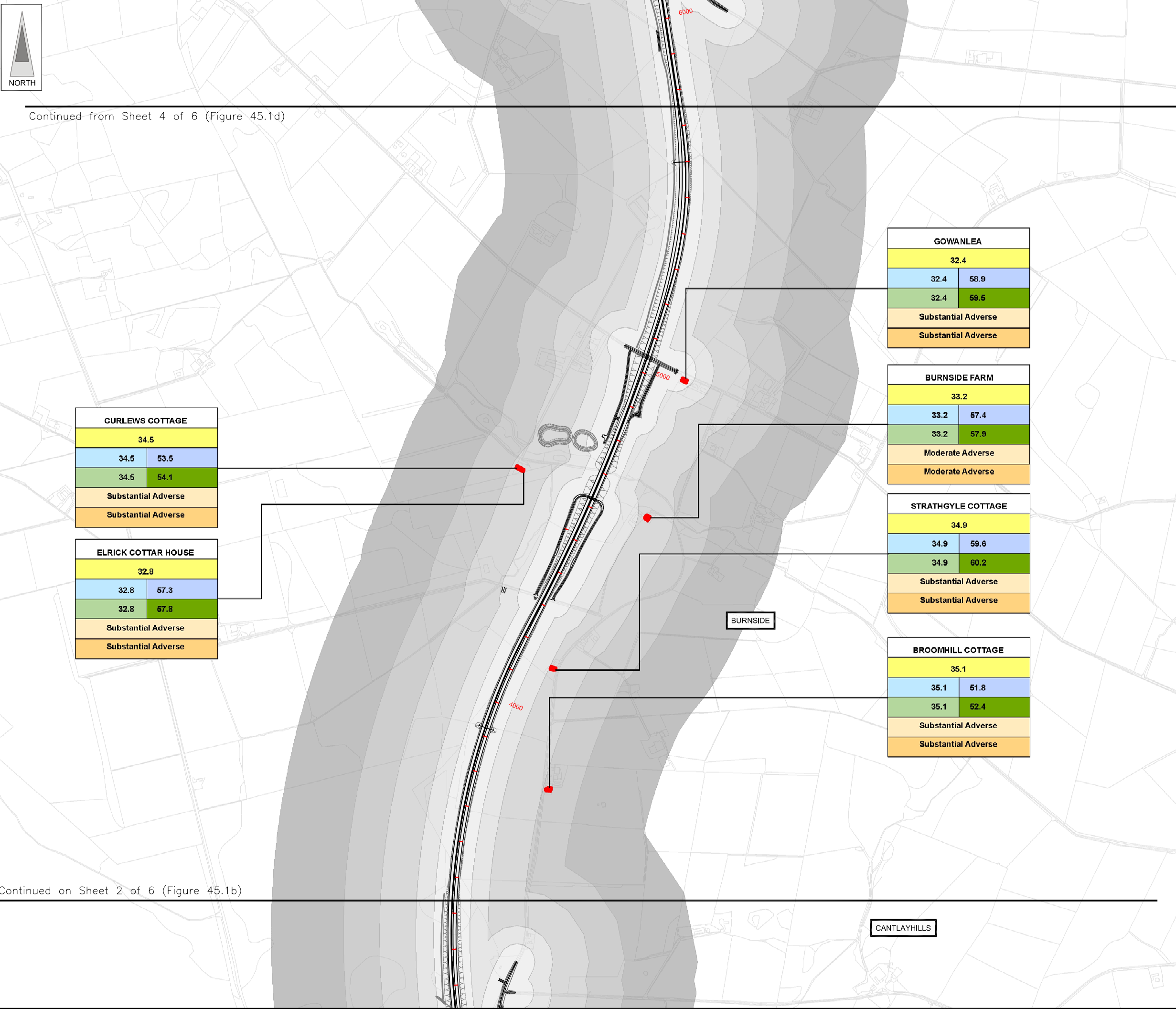
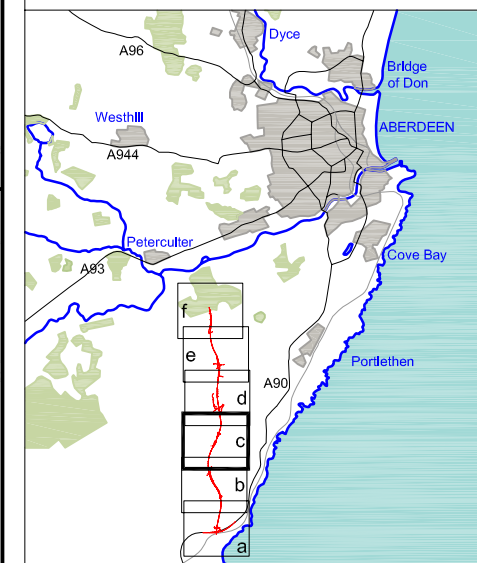

FIGURE 45.1c



GOWANLEA	
32.4	
32.4	58.9
32.4	59.5
Substantial Adverse	
Substantial Adverse	

BURNSIDE FARM	
33.2	
33.2	57.4
33.2	57.9
Moderate Adverse	
Moderate Adverse	

STRATHGYLE COTTAGE	
34.9	
34.9	59.6
34.9	60.2
Substantial Adverse	
Substantial Adverse	

BROOMHILL COTTAGE	
35.1	
35.1	51.8
35.1	52.4
Substantial Adverse	
Substantial Adverse	

CURLLEWS COTTAGE	
34.5	
34.5	53.5
34.5	54.1
Substantial Adverse	
Substantial Adverse	

ELRICK COTTAR HOUSE	
32.8	
32.8	57.3
32.8	57.8
Substantial Adverse	
Substantial Adverse	

LEGEND

Proposed Route (Engineering Profile 04/05/07)

0-50m
>50-100m
>100-200m
>200-300m
>300-500m

Sample Properties

Non Residential Receptors

Location Name	
BASE 2005	
Do Minimum Year of Opening	Do Something Year of Opening
Do Minimum Design Year	Do Something Design Year
SIGNIFICANCE OF IMPACT Year of Opening	
SIGNIFICANCE OF IMPACT Design Year	

JE JACOBS
 95 Bothwell Street, Glasgow, G2 7HX, UK
 Tel: 0141 204 2511 Fax: 0141 226 3109
 www.jacobsbabtie.com

Hamilton & McGregor
 ACOUSTICS DIVISION

Client		
Project	Aberdeen Western Peripheral Route Environmental Statement, Part D - Fastlink	
Title	Predicted LA10(18hours) dB without Mitigation (Receiver Height = 1.5m) Sheet 3 of 6	

Drawing Status	FINAL	Revisions	
JB No.	0010332	Date	July 2007
Figure No.	FIGURE 45.1c	Approved	SH
Scale	1:10,000	Checked	BMCK
Drawn	RB	Signature	

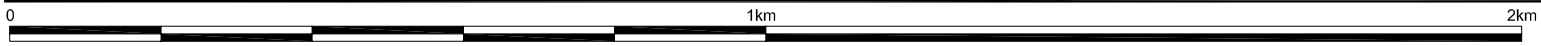

This map is based on Ordnance Survey material with the permission of Ordnance Survey on behalf of the controller of Her Majesty's Stationery Office. Crown copyright. Unauthorized reproduction infringes Crown copyright and may lead to prosecution or civil proceedings. Scottish Executive Licence Number, 100020540 (2007).
 Maps produced by Jacobs UK Ltd. This map should NOT be rescaled. Copyright reserved.

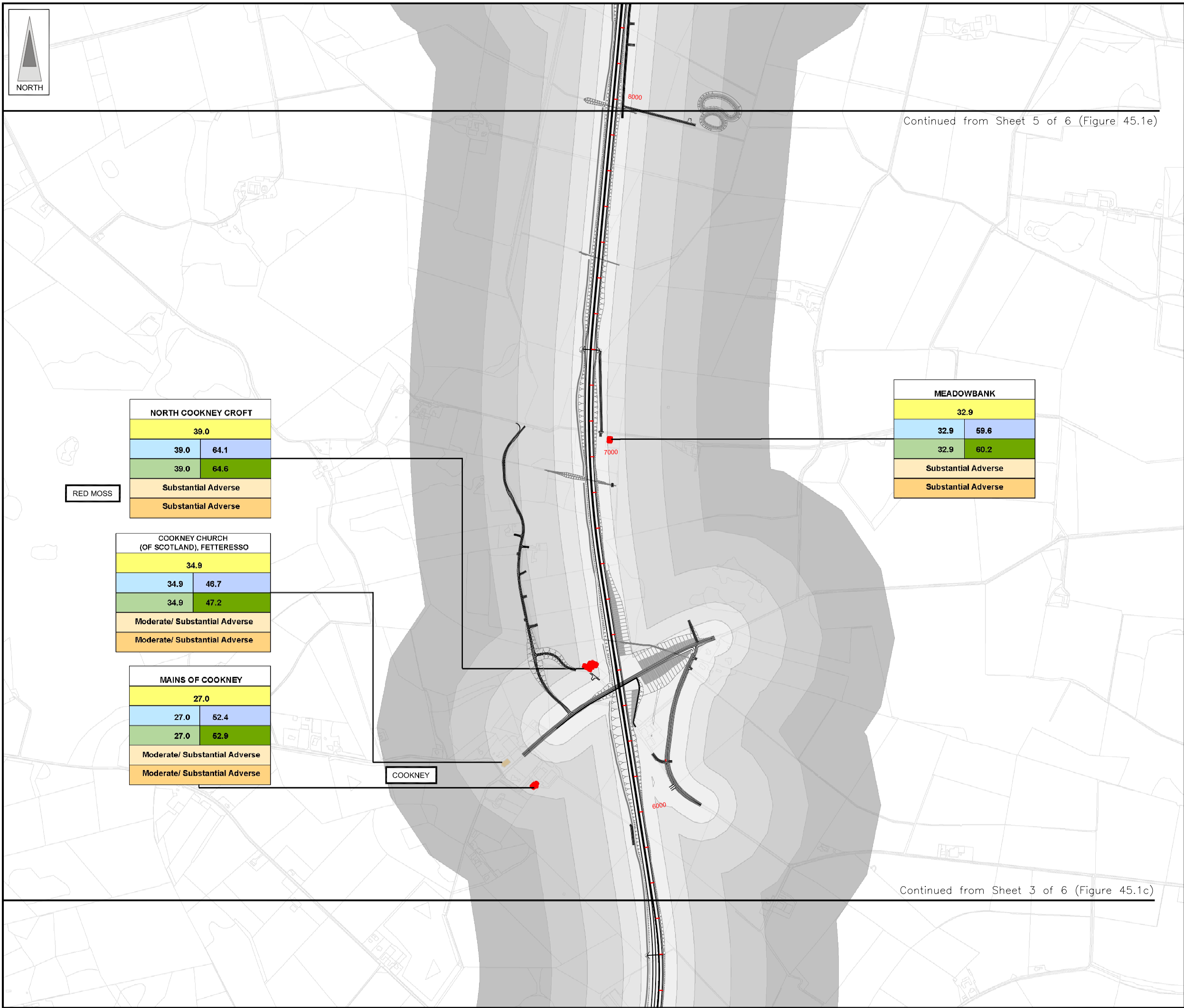
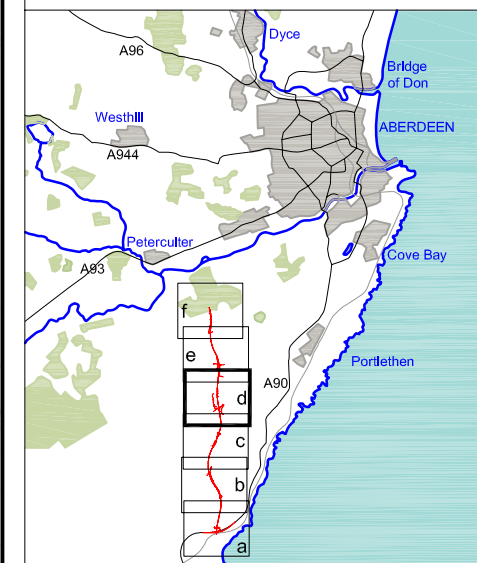

FIGURE 45.1d



LEGEND

Proposed Route (Engineering Profile 04/05/07)

- 0-50m
- >50-100m
- >100-200m
- >200-300m
- >300-500m
- Sample Properties
- Non Residential Receptors

Location Name	
BASE 2005	
Do Minimum Year of Opening	Do Something Year of Opening
Do Minimum Design Year	Do Something Design Year
SIGNIFICANCE OF IMPACT Year of Opening	
SIGNIFICANCE OF IMPACT Design Year	

JE JACOBS
 95 Bothwell Street, Glasgow, G2 7HX, UK
 Tel: 0141 204 2511 Fax: 0141 226 3109
 www.jacobsbabtie.com

Hamilton & McGregor
 ACOUSTICS DIVISION

Client	Aberdeen Western Peripheral Route	
Project	Aberdeen Western Peripheral Route Environmental Statement, Part D - Fastlink	
Title	Predicted LA10(18hours) dB without Mitigation (Receiver Height = 1.5m) Sheet 4 of 6	
Drawing Status	FINAL	
JB No.	0010332	
Figure No.	FIGURE 45.1d	Revisions
Scale	1:10,000	Date July 2007
Drawn	RB	Checked BMcK
		Approved SH

FIGURE 45.1e

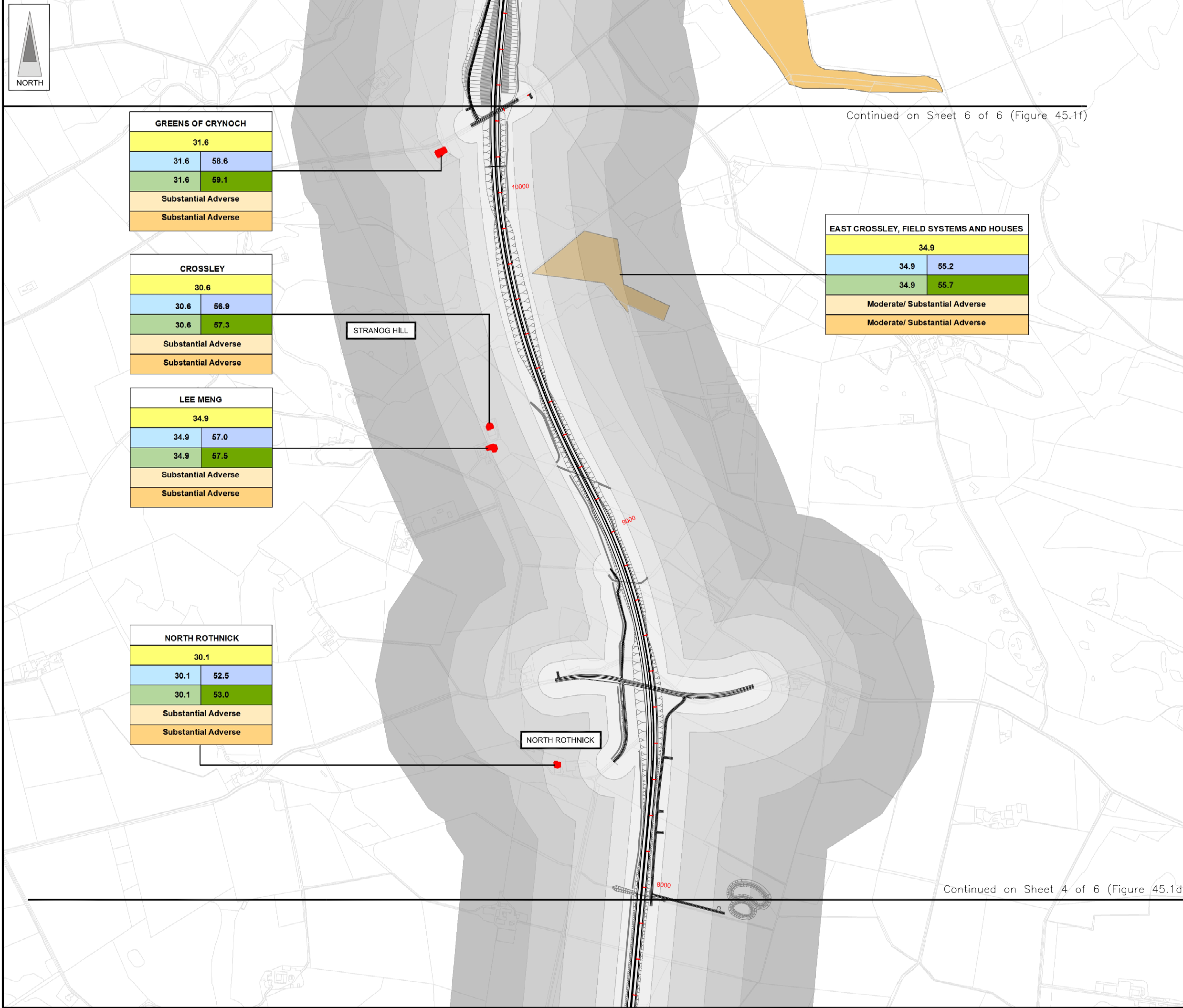
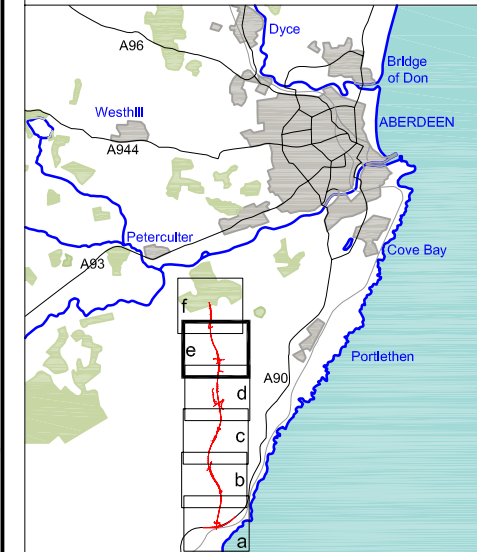

Continued on Sheet 6 of 6 (Figure 45.1f)

Continued on Sheet 4 of 6 (Figure 45.1d)

GREENS OF CRYNOCH	
31.6	
31.6	58.6
31.6	59.1
Substantial Adverse	
Substantial Adverse	

CROSSLEY	
30.6	
30.6	56.9
30.6	57.3
Substantial Adverse	
Substantial Adverse	

LEE MENG	
34.9	
34.9	57.0
34.9	57.5
Substantial Adverse	
Substantial Adverse	

NORTH ROTHNICK	
30.1	
30.1	52.5
30.1	53.0
Substantial Adverse	
Substantial Adverse	

EAST CROSSLEY, FIELD SYSTEMS AND HOUSES	
34.9	
34.9	55.2
34.9	55.7
Moderate/ Substantial Adverse	
Moderate/ Substantial Adverse	

LEGEND

- Proposed Route (Engineering Profile 04/05/07)
- 0-50m
- >50-100m
- >100-200m
- >200-300m
- >300-500m
- Sample Properties
- Non Residential Receptors

Location Name	
BASE 2005	
Do Minimum Year of Opening	Do Something Year of Opening
Do Minimum Design Year	Do Something Design Year
SIGNIFICANCE OF IMPACT Year of Opening	
SIGNIFICANCE OF IMPACT Design Year	

JE JACOBS
 95 Bothwell Street, Glasgow, G2 7HX, UK
 Tel: 0141 204 2511 Fax: 0141 226 3109
 www.jacobsbabtie.com

Hamilton & McGregor
 ACOUSTICS DIVISION

Client	Aberdeen Western Peripheral Route		
Project	Aberdeen Western Peripheral Route Environmental Statement, Part D - Fastlink		
Title	Predicted LA10(18hours) dB without Mitigation (Receiver Height = 1.5m) Sheet 5 of 6		
Drawing Status	FINAL	Revisions	
JB No.	0010332	Date July 2007	
Figure No.	FIGURE 45.1e	Checked	Approved
Scale	1:10,000	Drawn	SH
		RB	BMCK

FIGURE 45.1f

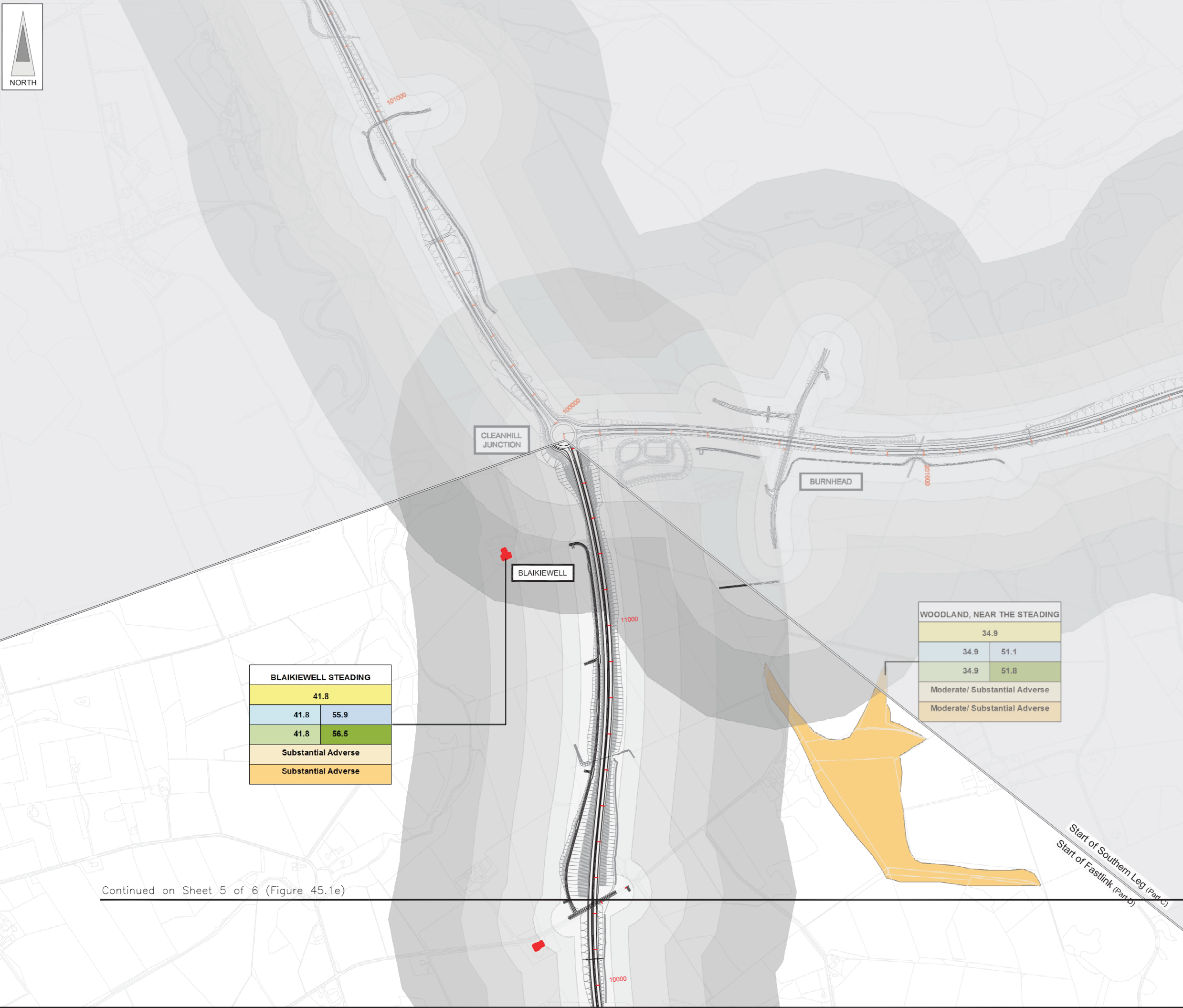
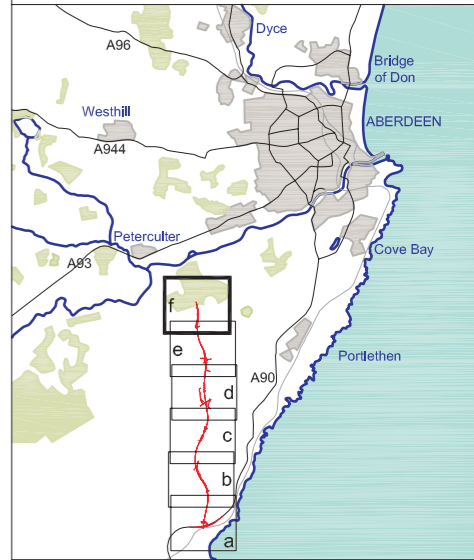

LEGEND

- Proposed Route (Engineering Profile 04/05/07)
- 0-50m
- >50-100m contour symbol"/> >50-100m
- >100-200m contour symbol"/> >100-200m
- >200-300m contour symbol"/> >200-300m
- >300-500m contour symbol"/> >300-500m
- Sample Properties
- Non Residential Receptors

Location Name	
BASE 2005	
Do Minimum Year of Opening	Do Something Year of Opening
Do Minimum Design Year	Do Something Design Year
SIGNIFICANCE OF IMPACT Year of Opening	
SIGNIFICANCE OF IMPACT Design Year	

BLAIKIEWELL STEADING	
41.8	
41.8	55.9
41.8	56.5
Substantial Adverse	
Substantial Adverse	

WOODLAND, NEAR THE STEADING	
34.9	
34.9	51.1
34.9	51.8
Moderate/ Substantial Adverse	
Moderate/ Substantial Adverse	

Continued on Sheet 5 of 6 (Figure 45.1e)

Start of Southern Leg (Part B)
Start of Fastlink (Part B)

JE JACOBS
95 Bothwell Street, Glasgow, G2 7HX, UK
Tel: 0141 204 2511 Fax: 0141 226 3109
www.jacobsbabtie.com

Hamilton & McGregor
ACOUSTICS DIVISION

Client	Aberdeen Western Peripheral Route	
Project	Aberdeen Western Peripheral Route Environmental Statement, Part D - Fastlink	
Title	Predicted LA10(18hours) dB without Mitigation (Receiver Height = 1.5m) Sheet 6 of 6	

Drawing Status	FINAL	Revisions	
JB No.	0010332	Date	July 2007
Figure No.	FIGURE 45.1f	Approved	SH
Scale	1:10,000	Checked	BMCK
Drawn	RB	Approved	SH



This map is based on Ordnance Survey material with the permission of Ordnance Survey on behalf of the controller of Her Majesty's Stationery Office. Crown copyright. Unauthorised reproduction infringes Crown copyright and may lead to prosecution or civil proceedings. Scottish Executive Licence Number, 100020540 (2007).

This drawing is not to be used in whole or part other than for the intended purpose and project as defined on this drawing. Refer to the contract for full terms and conditions. Maps produced by Jacobs UK Ltd. This map should NOT be rescaled. Copyright reserved.