

- Legend**
- Proposed Scheme (as per Draft Orders)
  - SUDS (e.g. Basin or Pond)\*
  - Calculation Area
  - Sample Receptor
  - Noise Mitigation Barrier

Location Name**	
Do Minimum Baseline Year	Do Minimum Future Year
Do Minimum Baseline Year	Do Something Baseline Year
Do Minimum Baseline Year	Do Something Future Year
Significance of Impact (DMB vs DMF)	
Significance of Impact (DMB vs DSB)	
Significance of Impact (DMB vs DSF)	

DMB = Do Minimum Baseline Year  
 DMF = Do Minimum Future Year  
 DSB = Do Something Baseline Year  
 DSF = Do Something Future Year

\* Actual shape of pond/basin will be subject to detailed design  
 \*\* Predicted noise levels at the least beneficial façade for each scenario comparison

Rev.	Rev. Date	Purpose of revision	Orig/Dwnl	Check'd	Rev'd	Apprv'd
0	NOV 2016	ES Publication	KA	SG	GK	DP

**JACOBS**  
 36 Belford Street, Glasgow, G2 7HX, UK  
 Tel: +44(0)141 243 8000 Fax: +44(0)141 226 3109  
 www.jacobs.com

Client  
  
 TRANSPORT SCOTLAND  
 COMHDAIL ALBA

Project  
  
**A95**  
 DUALLING  
 INVERNESS TO NAIRN  
 (Incl. Nairn Bypass)

Drawing title  
**Figure 8.21g**  
**Environmental Statement**  
**Sample Receptor Predicted Night-time Noise Levels**  
**(First Floor) (With Mitigation)**

Drawing Status	FINAL	
Scale	1:10,000 @ A3	DO NOT SCALE
Jacobs No.	B2103500	
BIM No.		
Drawing number	B2103500/EN/EIA/DR/821g	Rev 0

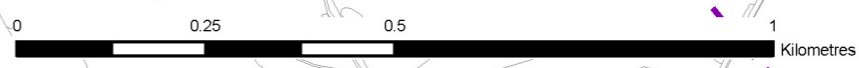



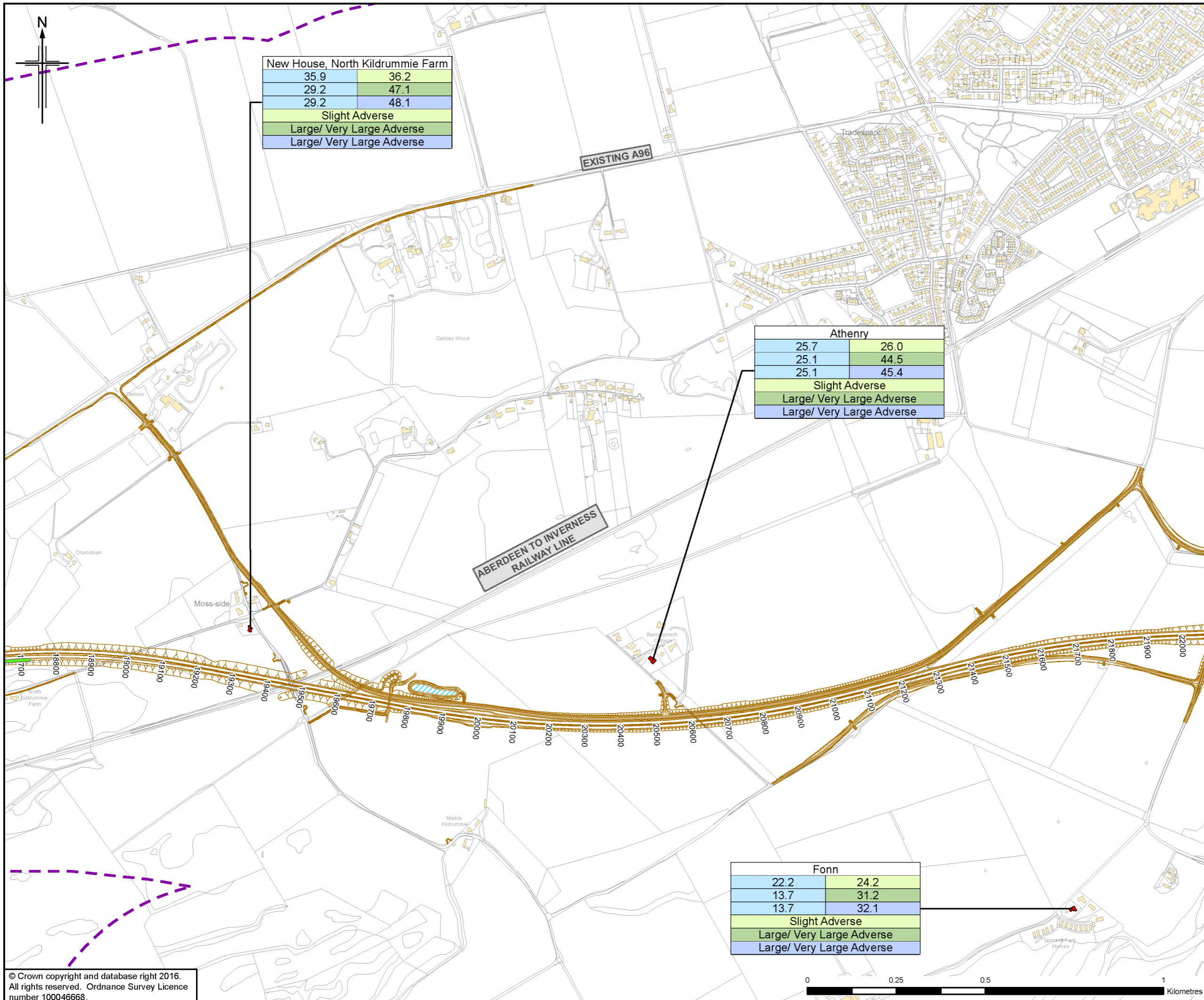

New House, North Kildrummie Farm	
35.9	36.2
29.2	47.1
29.2	48.1
Slight Adverse	
Large/ Very Large Adverse	
Large/ Very Large Adverse	

Athenry	
25.7	26.0
25.1	44.5
25.1	45.4
Slight Adverse	
Large/ Very Large Adverse	
Large/ Very Large Adverse	

Fonn	
22.2	24.2
13.7	31.2
13.7	32.1
Slight Adverse	
Large/ Very Large Adverse	
Large/ Very Large Adverse	

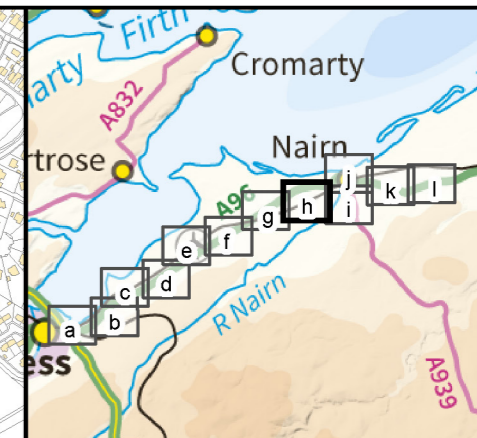

- Legend**
- Proposed Scheme (as per Draft Orders)
  - SUDS (e.g. Basin or Pond)\*
  - Calculation Area
  - Sample Receptor
  - Noise Mitigation Barrier

Location Name**	
Do Minimum Baseline Year	Do Minimum Future Year
Do Minimum Baseline Year	Do Something Baseline Year
Do Minimum Baseline Year	Do Something Future Year
Significance of Impact (DMB vs DMF)	
Significance of Impact (DMB vs DSB)	
Significance of Impact (DMB vs DSF)	

DMB = Do Minimum Baseline Year  
 DMF = Do Minimum Future Year  
 DSB = Do Something Baseline Year  
 DSF = Do Something Future Year

\* Actual shape of pond/basin will be subject to detailed design  
 \*\* Predicted noise levels at the least beneficial façade for each scenario comparison

0	NOV 2016	ES Preparation	KA	SG	GK	DP
Rev.	Rev. Date	Purpose of revision	OrigDwnl	Checkd	Rev'd	Apprv'd

**JACOBS**  
 36 Belford Street, Glasgow, G2 7HF, UK  
 Tel: +44(0)141 243 8000 Fax: +44(0)141 226 3109  
 www.jacobs.com

Client  
  
 TRANSPORT SCOTLAND  
 COMHDAH ALBA

Project  
  
**A96**  
 DUALLING  
 INVERNESS TO NAIRN  
 (Incl. Nairn Bypass)

Drawing title  
**Figure 8.21h**  
 Environmental Statement  
 Sample Receptor Predicted Night-time Noise Levels  
 (First Floor) (With Mitigation)

Drawing Status	FINAL	
Scale	1:10,000 @ A3	DO NOT SCALE
Jacobs No.	B2103500	
BIM No.		
Drawing number	B2103500/EN/EIA/DR/821h	Rev 0

This drawing is not to be used in whole or part other than for the intended purpose and project as defined on this drawing. Refer to the contract for full terms and conditions.



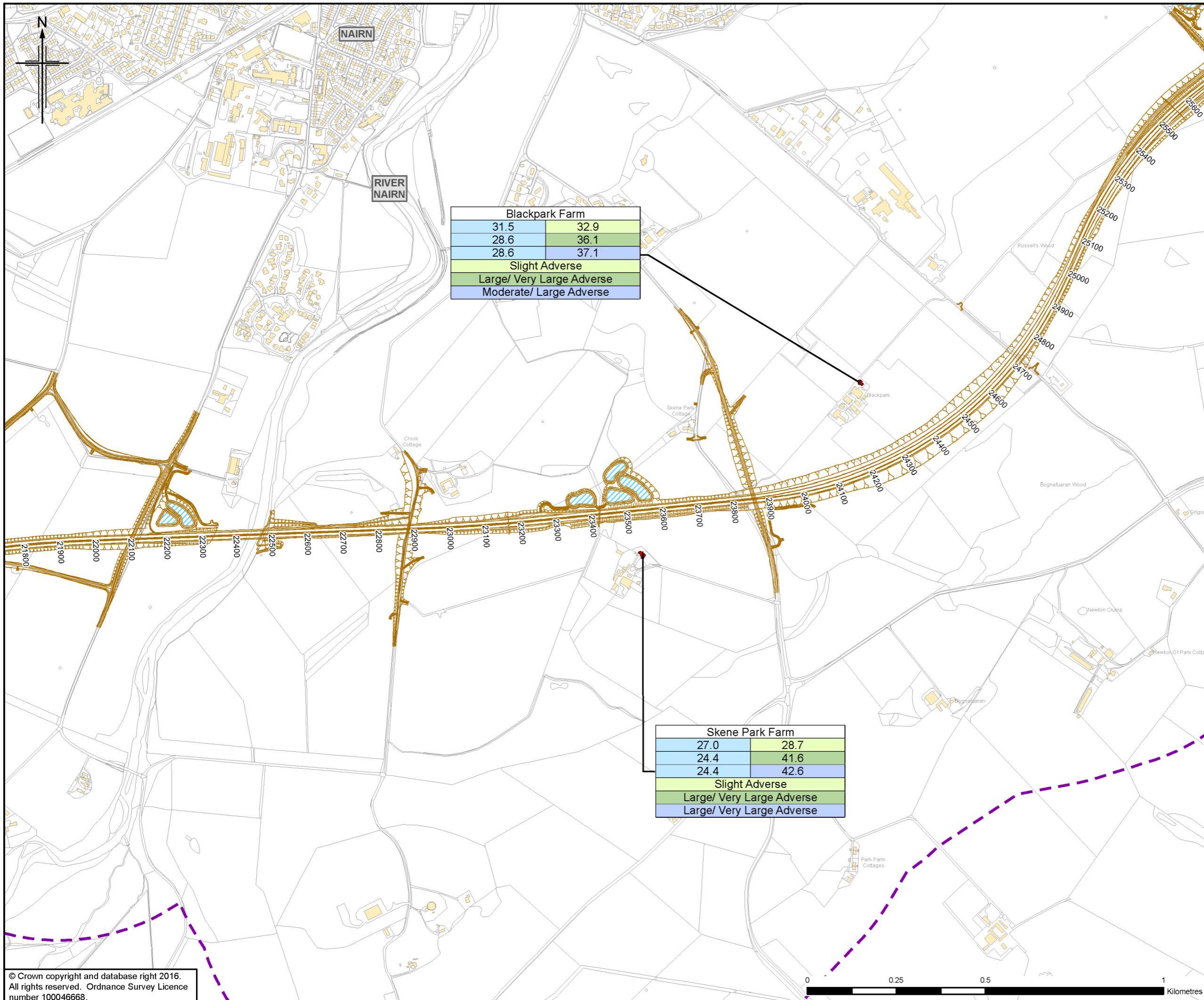

Blackpark Farm	
31.5	32.9
28.6	36.1
28.6	37.1
Slight Adverse	
Large/ Very Large Adverse	
Moderate/ Large Adverse	

Skene Park Farm	
27.0	28.7
24.4	41.6
24.4	42.6
Slight Adverse	
Large/ Very Large Adverse	
Large/ Very Large Adverse	

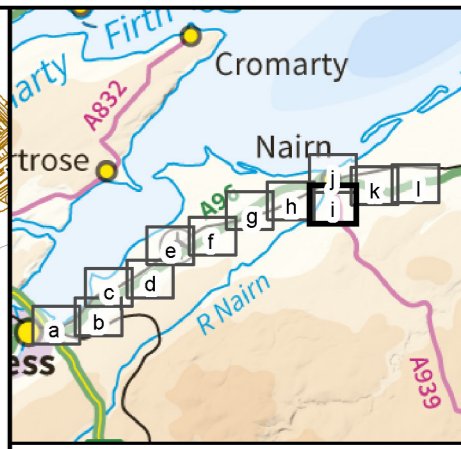

- Legend**
- Proposed Scheme (as per Draft Orders)
  - SUDS (e.g. Basin or Pond)\*
  - Calculation Area
  - Sample Receptor
  - Noise Mitigation Barrier

Location Name**	
Do Minimum Baseline Year	Do Minimum Future Year
Do Minimum Baseline Year	Do Something Baseline Year
Do Minimum Baseline Year	Do Something Future Year
Significance of Impact (DMB vs DMF)	
Significance of Impact (DMB vs DSB)	
Significance of Impact (DMB vs DSF)	

DMB = Do Minimum Baseline Year  
 DMF = Do Minimum Future Year  
 DSB = Do Something Baseline Year  
 DSF = Do Something Future Year

\* Actual shape of pond/basin will be subject to detailed design  
 \*\* Predicted noise levels at the least beneficial façade for each scenario comparison

Rev.	Rev. Date	Purpose of revision	Orig/Dwnl	Checkd	Rev'd	Apprv'd
0	NOV 2016	ES Preparation	KA	SG	GK	DP

**JACOBS**  
 36 Belford Street, Glasgow, G2 7HX, UK  
 Tel: +44(0)141 243 8000 Fax: +44(0)141 226 3109  
 www.jacobs.com

Client

Project  
  
 INVERNESS TO NAIRN  
 (Incl. Nairn Bypass)

Drawing title  
**Figure 8.21i**  
**Environmental Statement**  
**Sample Receptor Predicted Night-time Noise Levels**  
**(First Floor) (With Mitigation)**

Drawing Status	FINAL	
Scale	1:10,000 @ A3	DO NOT SCALE
Jacobs No.	B2103500	
BIM No.		
Drawing number	B2103500/EN/EIA/DR/821i	Rev 0

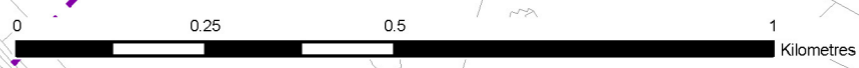

This drawing is not to be used in whole or part other than for the intended purpose and project as defined on this drawing. Refer to the contract for full terms and conditions.



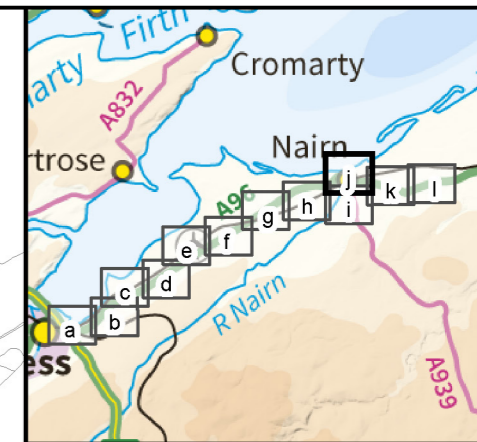
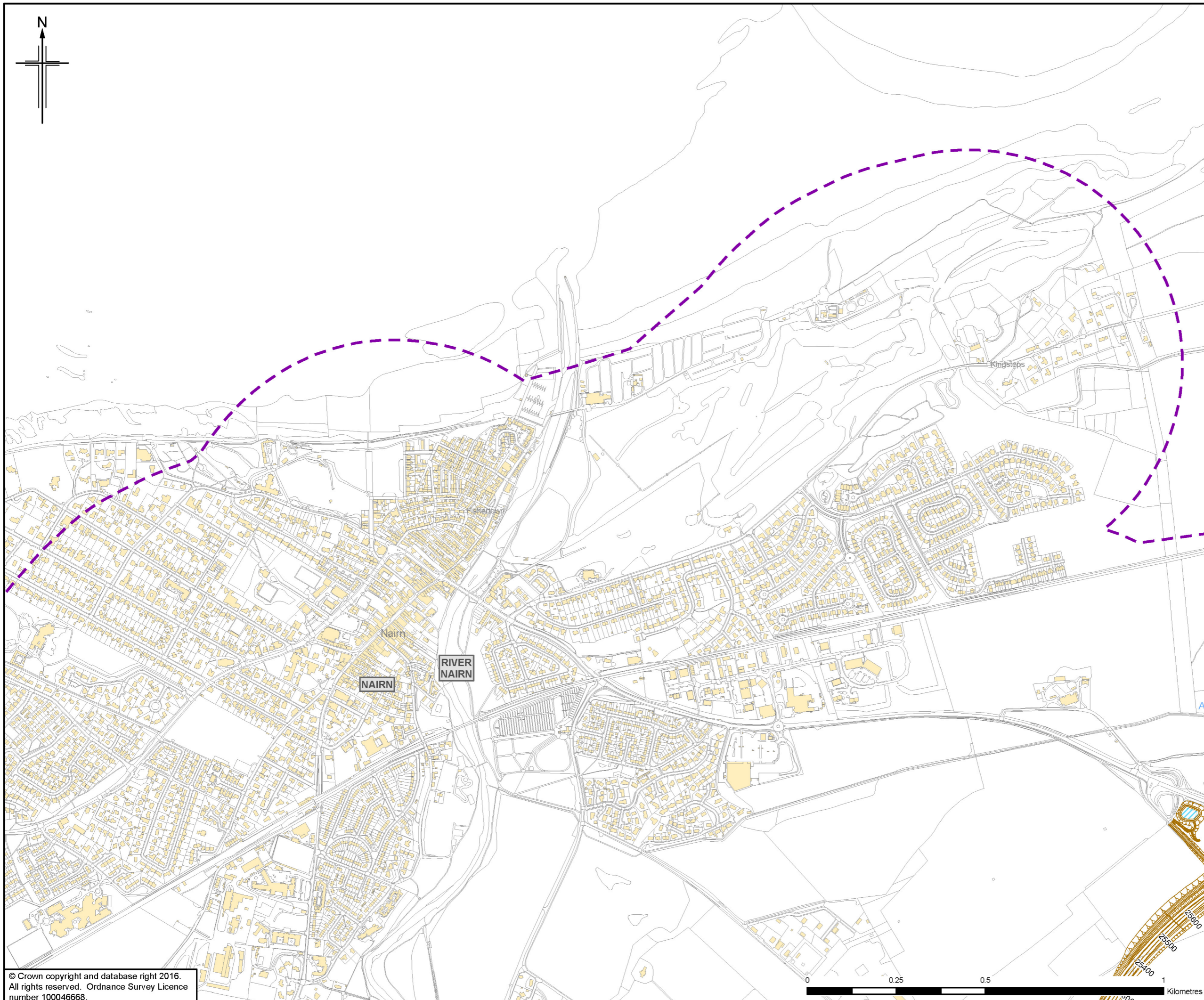

- Legend**
- Proposed Scheme (as per Draft Orders)
  - SUDS (e.g. Basin or Pond)\*
  - Calculation Area
  - Sample Receptor
  - Noise Mitigation Barrier

Location Name**	
Do Minimum Baseline Year	Do Minimum Future Year
Do Minimum Baseline Year	Do Something Baseline Year
Do Minimum Baseline Year	Do Something Future Year
Significance of Impact (DMB vs DMF)	
Significance of Impact (DMB vs DSB)	
Significance of Impact (DMB vs DSF)	

DMB = Do Minimum Baseline Year  
 DMF = Do Minimum Future Year  
 DSB = Do Something Baseline Year  
 DSF = Do Something Future Year

\* Actual shape of pond/basin will be subject to detailed design  
 \*\* Predicted noise levels at the least beneficial façade for each scenario comparison

Rev.	Rev. Date	Purpose of revision	Orig/Dwnl	Checkd	Rev'd	Apprv'd
0	NOV 2016	SB Publication	KA	SG	GK	DP

**JACOBS**  
 56 Bellfield Street, Glasgow, G2 7HX, UK  
 Tel: +44(0)141 243 8000 Fax: +44(0)141 226 3109  
 www.jacobs.com



Drawing title  
**Figure 8.21j**  
**Environmental Statement**  
**Sample Receptor Predicted Night-time Noise Levels**  
**(First Floor) (With Mitigation)**

Drawing Status	FINAL		Sheet 10 of 12
Scale	1:10,000	@ A3	DO NOT SCALE
Jacobs No.	B2103500		
BIM No.			
Drawing number	B2103500/EN/EIA/DR/821j	Rev	0

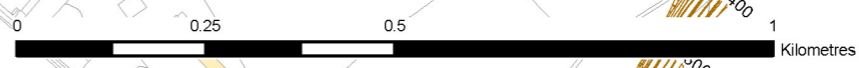



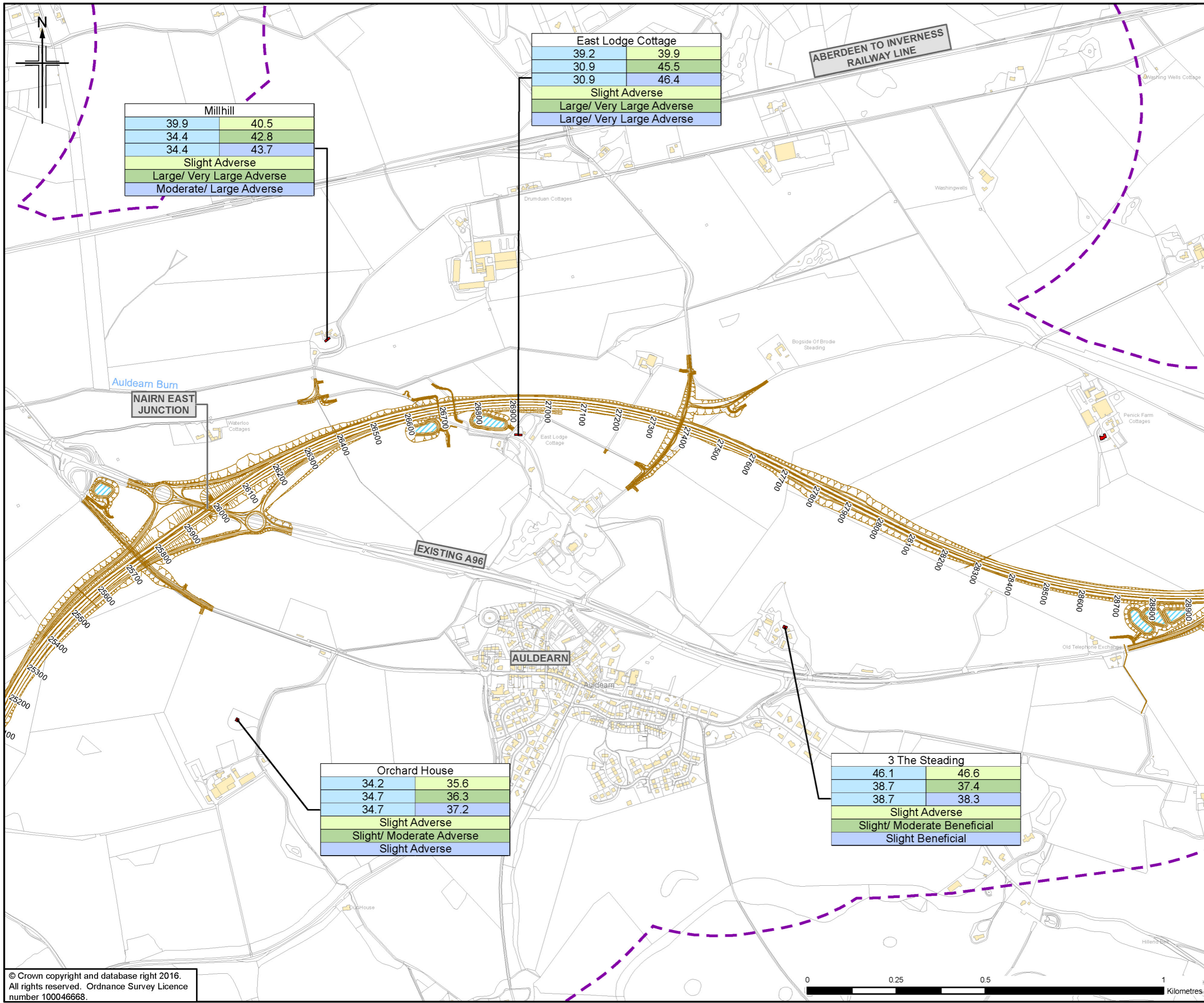

Millhill	
39.9	40.5
34.4	42.8
34.4	43.7
Slight Adverse	
Large/ Very Large Adverse	
Moderate/ Large Adverse	

East Lodge Cottage	
39.2	39.9
30.9	45.5
30.9	46.4
Slight Adverse	
Large/ Very Large Adverse	
Large/ Very Large Adverse	

Orchard House	
34.2	35.6
34.7	36.3
34.7	37.2
Slight Adverse	
Slight/ Moderate Adverse	
Slight Adverse	

3 The Steading	
46.1	46.6
38.7	37.4
38.7	38.3
Slight Adverse	
Slight/ Moderate Beneficial	
Slight Beneficial	

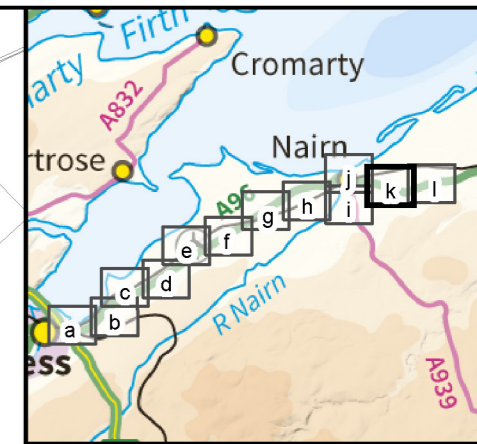

- Legend**
- Proposed Scheme (as per Draft Orders)
  - SUDS (e.g. Basin or Pond)\*
  - Calculation Area
  - Sample Receptor
  - Noise Mitigation Barrier

Location Name**	
Do Minimum Baseline Year	Do Minimum Future Year
Do Minimum Baseline Year	Do Something Baseline Year
Do Minimum Baseline Year	Do Something Future Year
Significance of Impact (DMB vs DMF)	
Significance of Impact (DMB vs DSB)	
Significance of Impact (DMB vs DSF)	

DMB = Do Minimum Baseline Year  
 DMF = Do Minimum Future Year  
 DSB = Do Something Baseline Year  
 DSF = Do Something Future Year

\* Actual shape of pond/basin will be subject to detailed design  
 \*\* Predicted noise levels at the least beneficial façade for each scenario comparison

Rev.	Rev. Date	Purpose of revision	OrigDwnl	Checkd	Rev'd	Apprv'd
0	NOV 2016	ES Preparation	KA	SG	GK	DP

**JACOBS**  
 36 Belford Street, Glasgow, G2 7HF, UK  
 Tel: +44(0)141 243 8000 Fax: +44(0)141 226 3109  
 www.jacobs.com

Client  
  
 TRANSPORT SCOTLAND  
 COMHDAHL ALBA

Project  
  
**A96**  
 DUALLING  
 INVERNESS TO NAIRN  
 (Incl. Nairn Bypass)

Drawing title  
**Figure 8.21k**  
**Environmental Statement**  
**Sample Receptor Predicted Night-time Noise Levels**  
**(First Floor) (With Mitigation)**

Drawing Status	FINAL		Sheet 11 of 12
Scale	1:10,000 @ A3	DO NOT SCALE	
Jacobs No.	B2103500		
BIM No.			
Drawing number	B2103500/EN/EIA/DR/821k	Rev	0





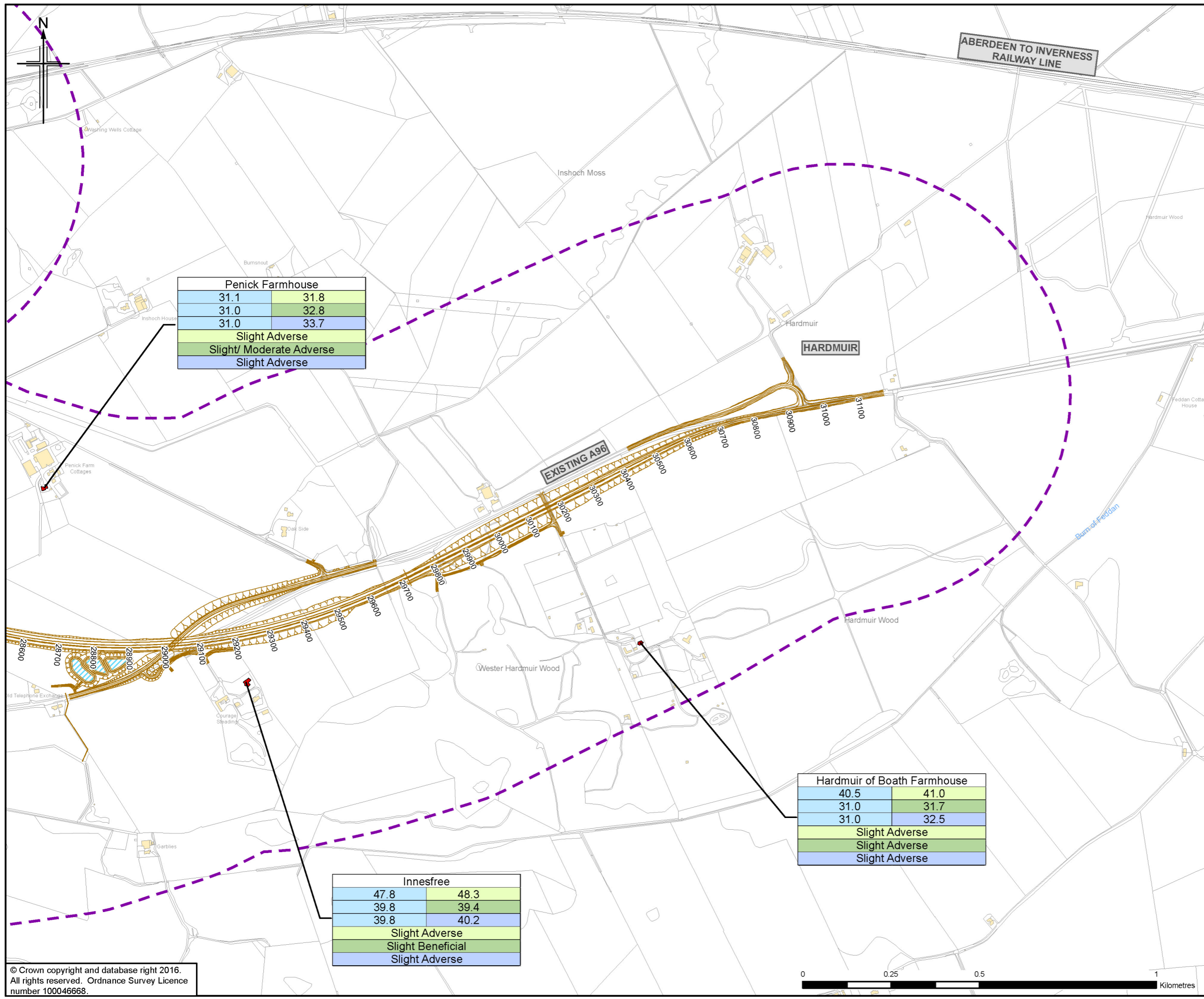

Penick Farmhouse	
31.1	31.8
31.0	32.8
31.0	33.7
Slight Adverse	
Slight/ Moderate Adverse	
Slight Adverse	

Hardmuir of Boath Farmhouse	
40.5	41.0
31.0	31.7
31.0	32.5
Slight Adverse	
Slight Adverse	
Slight Adverse	

Innesfree	
47.8	48.3
39.8	39.4
39.8	40.2
Slight Adverse	
Slight Beneficial	
Slight Adverse	

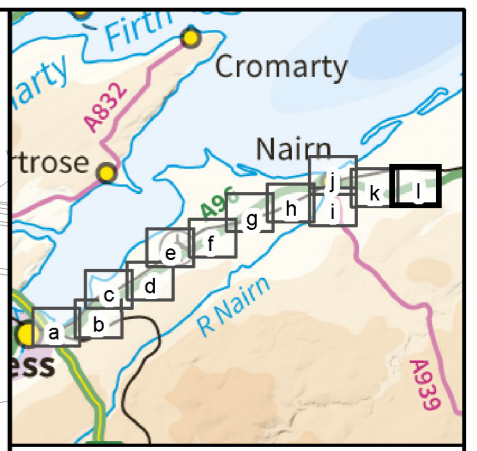

- Legend**
- Proposed Scheme (as per Draft Orders)
  - SUDS (e.g. Basin or Pond)\*
  - Calculation Area
  - Sample Receptor
  - Noise Mitigation Barrier

Location Name**	
Do Minimum Baseline Year	Do Minimum Future Year
Do Minimum Baseline Year	Do Something Baseline Year
Do Minimum Baseline Year	Do Something Future Year
Significance of Impact (DMB vs DMF)	
Significance of Impact (DMB vs DSB)	
Significance of Impact (DMB vs DSF)	

DMB = Do Minimum Baseline Year  
 DMF = Do Minimum Future Year  
 DSB = Do Something Baseline Year  
 DSF = Do Something Future Year

\* Actual shape of pond/basin will be subject to detailed design  
 \*\* Predicted noise levels at the least beneficial façade for each scenario comparison

Rev.	Rev. Date	Purpose of revision	Orig'Dwnl	Check'd	Rev'd	Apprv'd
0	NOV 2016	ES Publication	KA	SG	GK	DP

**JACOBS**  
 36 Belford Street, Glasgow, G2 7HF, UK  
 Tel: +44(0)141 243 8000 Fax: +44(0)141 226 3109  
 www.jacobs.com

Client  
  
 TRANSPORT SCOTLAND  
 COMHDAI ALBA

Project  
  
**A96**  
 DUALLING  
 INVERNESS TO NAIRN  
 (Incl. Nairn Bypass)

Drawing title  
**Figure 8.211**  
**Environmental Statement**  
**Sample Receptor Predicted Night-time Noise Levels**  
**(First Floor) (With Mitigation)**

Drawing Status	FINAL		Sheet 12 of 12
Scale	1:10,000	@ A3	DO NOT SCALE
Jacobs No.	B2103500		
BIM No.			
Drawing number	B2103500/EN/EIA/DR/8211	Rev	0

