

**This is Document “Schedule 7 Part 5 referred to in this Contract**

**SCOTTISH MINISTERS’ REQUIREMENTS**

**SCHEDULE 7 PART 5**

**LANDSCAPE DEVELOPMENT PLAN AND REPORT**

**CONTENTS**

	<b>Page No</b>
<b>1 LANDSCAPE DEVELOPMENT PLAN AND REPORT</b>	<b>1</b>
1.1 General	1
1.2 5-year Landscape Management and Maintenance Strategy	2
1.3 Landscape Development Plan	3
1.4 Landscape Maintenance Review	3
1.5 3-year Landscape Improvement Plan	4
1.6 Pesticide Reduction Plan	5
1.7 Annual Landscaping Report	5
<b>ANNEX 7.5/A – LANDSCAPE INVENTORY DRAWINGS</b>	<b>7</b>

***This page is blank***

## **SCOTTISH MINISTERS' REQUIREMENTS**

### **SCHEDULE 7 PART 5**

#### **LANDSCAPE DEVELOPMENT PLAN AND REPORT**

#### **1 LANDSCAPE DEVELOPMENT PLAN AND REPORT**

##### **1.1 General**

- 1.1.1 This Part 5 of this Schedule 7 shall apply to Landscape Areas within and outwith the Trunk Road boundary
- 1.1.2 The overall management requirements for the Landscape Areas shall be to
- (i) maintain a safe and reliable Trunk Road network
  - (ii) promote and sustain healthy growth
  - (iii) maximise planting objectives
  - (iv) minimise problems
  - (v) encourage biodiversity and
  - (vi) ensure all planting becomes as self reliant as possible.
- 1.1.3 Within 30 days of the commencement of the Mobilisation Period the Director shall provide the Operating Company with the landscape action plan prepared by the previous operating company containing the following interrelated parts
- (i) 5-year landscape strategy
  - (ii) landscape inventory
  - (iii) landscape maintenance plan
  - (iv) landscape development plan and
  - (v) annual report.
- 1.1.4 Annex 7.5/A of this Part 5 of this Schedule 7 contains details of Landscape Inventory Drawings.
- 1.1.5 Not later than the end of the First Annual Period the Operating Company shall populate the Routine Maintenance and Management System with the landscape inventory including Detailed Inspections and Cyclic Maintenance requirements as referred to in Part 3 of Schedule 4.
- 1.1.6 The Operating Company's shall appoint a Chartered Landscape Architect who shall be a Chartered member of the Landscape Institute and shall be responsible for the preparation and delivery of
- (i) the 5-year landscape management and maintenance strategy
  - (ii) the Landscape Development Plan and
  - (iii) the annual report as referred to in paragraphs 1.7.1 to 1.7.4 inclusive of this Part 5 of this Schedule 7.
- 1.1.7 The Operating Company shall submit to the Director
- (i) two hard copies and

- (ii) three Electronic Copies on compact disk read only memory format with drawings in PDF format of the
  - (a) 5-year landscape management and maintenance strategy
  - (b) Landscape Development Plan and
  - (c) annual landscape report.

Each document shall clearly state the periods covered by the document.

- 1.1.8 The Landscape Architect shall attend meetings with the Director and outside bodies as required by the Director.

## **1.2 5-year Landscape Management and Maintenance Strategy**

- 1.2.1 Not later than the 1 July in the First Annual Period the Operating Company shall prepare in consultation with the Director an outline 5-year landscape management and maintenance strategy for the five years commencing the following April.

- 1.2.2 Not later than the 1 July in each Annual Period after the First Annual Period the Operating Company shall review revise and update in consultation with the Director the previous outline 5-year landscape management and maintenance strategy for the five years commencing the following April.

- 1.2.3 The 5-year landscape management and maintenance strategy shall be produced on a route by route basis.

Areas of specific and varied character on the same route shall be in more detail.

- 1.2.4 The strategy shall include but not be limited to the following
- (i) clear cross-referencing with the Routine Maintenance and Management System landscape inventory
  - (ii) location plans showing the routes and areas under review
  - (iii) brief descriptions of the routes and areas under review highlighting
    - (a) the general character of the location
    - (b) the appearance and value
    - (c) comments on the quality of the landscape and
    - (d) any ecological elements which may impact on or be affected by the maintenance and management of the Landscape Areas
  - (iv) a range of photographs typical of the various character zones
  - (v) perceived main issues relating to the continued management of the Landscape Areas in this location taking into account topics such as
    - (a) safety
    - (b) visual aspects
    - (c) general amenity
    - (d) biodiversity
  - (vi) consideration of any relevant related studies plans or strategies for the location including but not limited to
    - (a) route action plans

(b) route accident reduction plans

(vii) general proposals for the future development of the environment related to the Trunk Road.

1.2.5 The Operating Company shall take account of the proposals in the agreed 5-year landscape management and maintenance strategy in preparing the Landscape Development Plan.

### **1.3 Landscape Development Plan**

1.3.1 Not later than 1 October in the First Annual Period the Operating Company shall prepare and submit to the Director a Landscape Development Plan for the relevant periods commencing the following April.

1.3.2 Not later than the 1 October in each Annual Period after the First Annual Period the Operating Company shall review revise and update the previous Landscape Development Plan for the relevant periods commencing the following April.

1.3.3 The Landscape Development Plan shall include

- (i) a 5-year landscape maintenance review
- (ii) a 3-year landscape improvement plan and
- (iii) a pesticide reduction plan.

1.3.4 The Operating Company shall develop the Landscape Development Plan to enable the Director to achieve the overall management requirements for Scotland's Landscape Areas.

1.3.5 The Landscape Development Plan shall be developed in accordance with

- (i) the Scottish Executive's landscape design and maintenance policy contained in Cost Effective Landscape Learning From Nature (CEL:LFN) published by The Stationery Office February 1998 (or any revisions of the policy thereafter)
- (ii) the Scottish Executive's commitment to the protection and enhancement of biodiversity through documents including but not limited to
  - (a) the Trunk Roads Biodiversity Action Plan published as a consultation document in January 2000 or any revisions of the document thereafter and
  - (b) Scotland's Biodiversity the Scottish Executive's biodiversity strategy published in 2004
- (iii) the Inventory of Wildlife Mitigation Measures produced by the Scottish Executive in February 2000.

### **1.4 Landscape Maintenance Review**

1.4.1 The Operating Company shall prepare a landscape maintenance review identifying Landscape Areas which could be improved by alternative Cyclic Maintenance requirements to those referred to in Part 1 of this Schedule 7 to meet the overall management requirements for Scotland's Landscape Areas in terms of

- (i) general amenity
- (ii) more efficient maintenance

- (iii) improved biodiversity and
- (iv) any other issues identified as significant by the Operating Company's Chartered Landscape Architect.

Where the Director shall consider that alternative Cyclic Maintenance shall be required then this shall be the subject of an Order.

## **1.5 3-year Landscape Improvement Plan**

1.5.1 The Operating Company shall prepare a 3-year landscape improvement plan with potential plant or planting Schemes to improve the Trunk Road landscape in terms of

- (i) general amenity
- (ii) more efficient maintenance
- (iii) improved biodiversity and
- (iv) any other issues identified as significant by the Operating Company's Chartered Landscape Architect.

1.5.2 Potential plant or planting Schemes shall be proposed with the following information

- (i) route
- (ii) Scheme name
- (iii) location reference
- (iv) brief synopsis of Operations proposed
- (v) reason for selection
- (vi) cost estimate and
- (vii) priority rating (high medium low) plus reasons.

This information shall be submitted to enable the Director to determine which of the potential plant or planting Schemes could be developed in more detail by the Operating Company depending on the merits of the proposal and the available budget.

1.5.3 Subject to an Order the Operating Company shall prepare a statement of intent for potential plant or planting Schemes selected by the Director.

1.5.4 The statement of intent shall include the following information

- (i) large scale plan showing the general context of the area
- (ii) more detailed plans/drawings identifying the specific proposal
- (iii) written description of the objective(s)
- (iv) reasons for the proposed action and relation to the 5-year landscape management and maintenance strategy for the respective route
- (v) description of the proposed Scheme
- (vi) detailed cost estimate
- (vii) priority rating (high medium low) and reason for rating
- (viii) proposed programme and

(ix) supporting sketches and photographs.

1.5.5 For Schemes the subject of an Order by the Director the Operating Company shall prepare a combined detailed programme for those Schemes.

1.5.6 The detailed programme shall include but not be limited to the

(i) the period of construction and

(ii) the estimated completion dates.

1.5.7 The detailed programme shall be kept up to date throughout each Annual Period and submitted with the monthly reports as referred to in Part 3 of Schedule 5.

## **1.6 Pesticide Reduction Plan**

1.6.1 The Operating Company shall prepare a pesticide reduction plan with targets for the potential reduction of herbicides in use through alternative but equally effective proposals.

## **1.7 Annual Landscaping Report**

1.7.1 During the Second and subsequent Annual Periods the Operating Company shall deliver to the Director prior to 31 May a written annual landscaping report detailing the landscaping Operations undertaken within the Unit during the preceding Annual Period.

1.7.2 During the Final Annual Period the Operating Company shall deliver to the Director prior to 31 March a written annual report detailing the landscaping Operations undertaken within the Unit during the Final Annual Period.

1.7.3 The annual landscaping report shall be sub-divided to correspond with the various routes within the Unit as described in the landscape inventory or Routine Maintenance and Management System.

1.7.4 The annual report shall record

(i) the general condition of the Landscape Areas on the Unit

(ii) the general effectiveness of Cyclic Maintenance and alternative Cyclic Maintenance activities over the year

(iii) a summary of any Operations undertaken as part of the Landscape Development Plan

(iv) the following information for all recently created planting areas within the Unit subject to establishment maintenance

<b>Planting Area</b>	<b>Location</b>	<b>Contractor</b>	<b>Date Created</b>	<b>Establishment Period</b>	<b>Condition</b>

(v) the performance of the contractor(s) responsible for the establishment and maintenance for planting areas within the Unit

(vi) the effectiveness of recently created planted areas within the Unit in meeting the requirements of the Landscape Development Plan

- (vii) a general statement advising on progress to meet the requirements of the Landscape Development Plan
- (viii) progress of the pesticide reduction plan specifying the general level of herbicide use throughout the Unit noting locations subjected to significant applications and identifying
  - (a) Pesticide record forms produced by the Operating Company in accordance with Clause 3001 of the Specification shall be included as an annex to the annual report
  - (b) details of any Operations undertaken in support of enhancing biodiversity and nature conservation including works associated with creating repairing or improving any wildlife mitigation measures within the Unit
  - (c) a general statement of any problems or specific unforeseen issues which may have arisen during the period covered by the annual report and recommendations for action required thereafter
  - (d) observations resulting from the Detailed Inspections of the Landscape Areas and
  - (e) details of any significant amendments to the landscape inventory in the Routine Maintenance and Management System.



**SCOTTISH MINISTERS' REQUIREMENTS**

**SCHEDULE 7 PART 5**

**LANDSCAPE DEVELOPMENT PLAN AND REPORT**

**ANNEX 7.5/A – LANDSCAPE INVENTORY DRAWINGS (TWO BINDERS)**

***This page is blank***

## SCOTTISH MINISTERS' REQUIREMENTS

### SCHEDULE 7 PART 5

### LANDSCAPE DEVELOPMENT PLAN AND REPORT

#### ANNEX 7.5/A – LANDSCAPE INVENTORY DRAWINGS

A701 Sheets 01 to 12	<b>Binder 1</b>
A725 Sheets 01 to 07	
A726 Sheets 01 to 02	
A737 Sheets 01 to 15	
A75 Sheets 01 to 65	
A751 Sheets 01 to 02	
A76 Sheets 01 to 37	
A77 Sheets 01 to 50	<b>Binder 2</b>
A78 Sheets 01 to 28	
A8 Sheets 01 to 06	
A82 Sheets 01 to 07	
A898 Sheets 01 to 02	
M73 Sheets 01 to 05	
M74 Sheets 01 to 17	
M77 Sheets 01 to 06	
M8 Sheets 01 to 18	
M80 Sheets 01 to 03A	

***This page is blank***















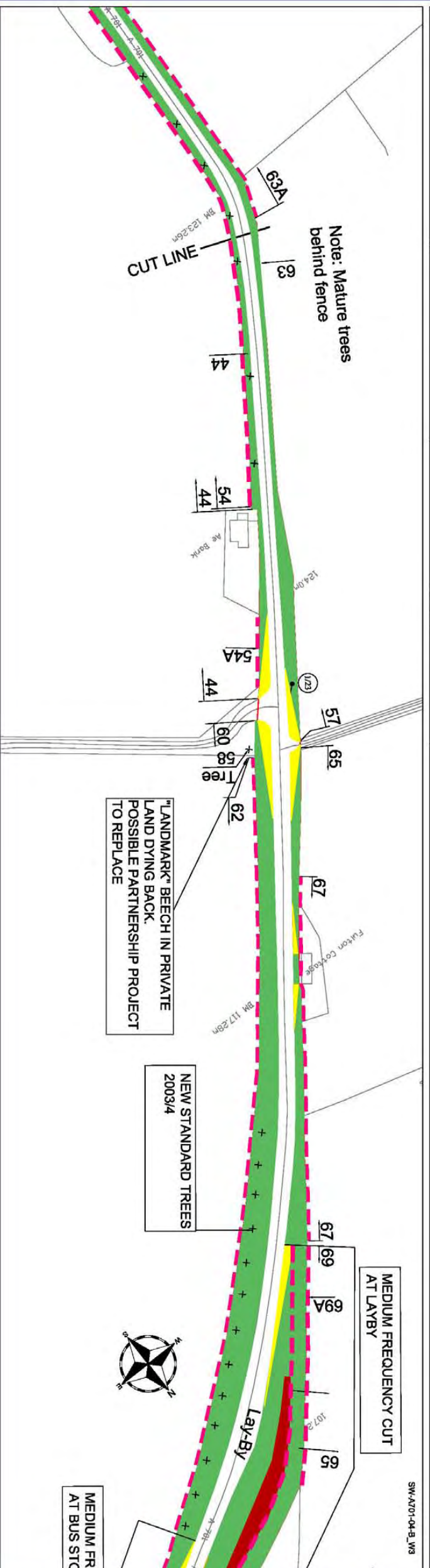
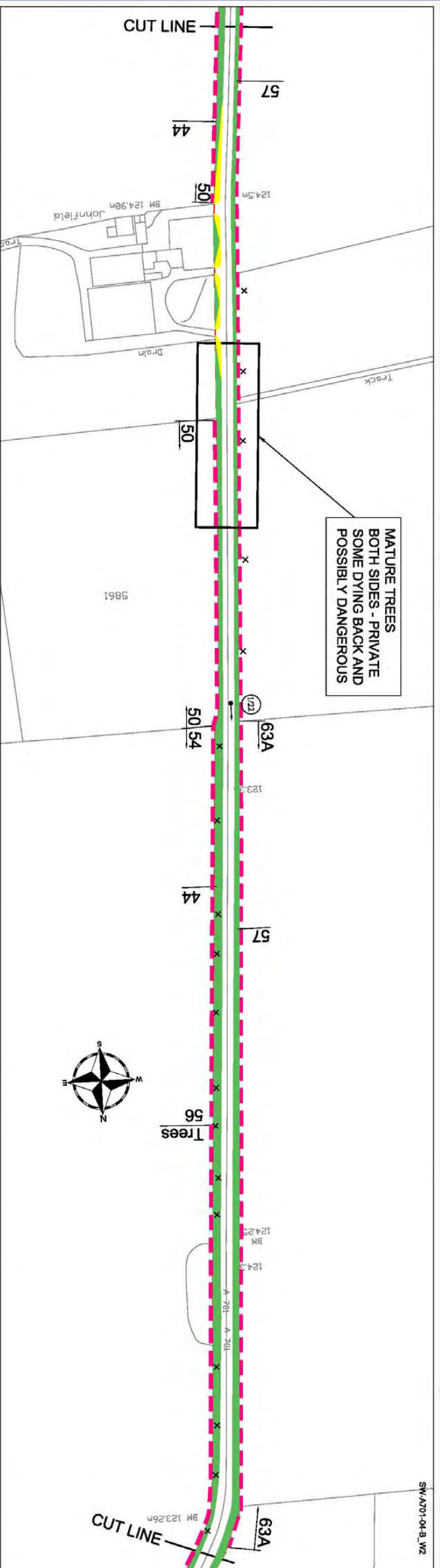
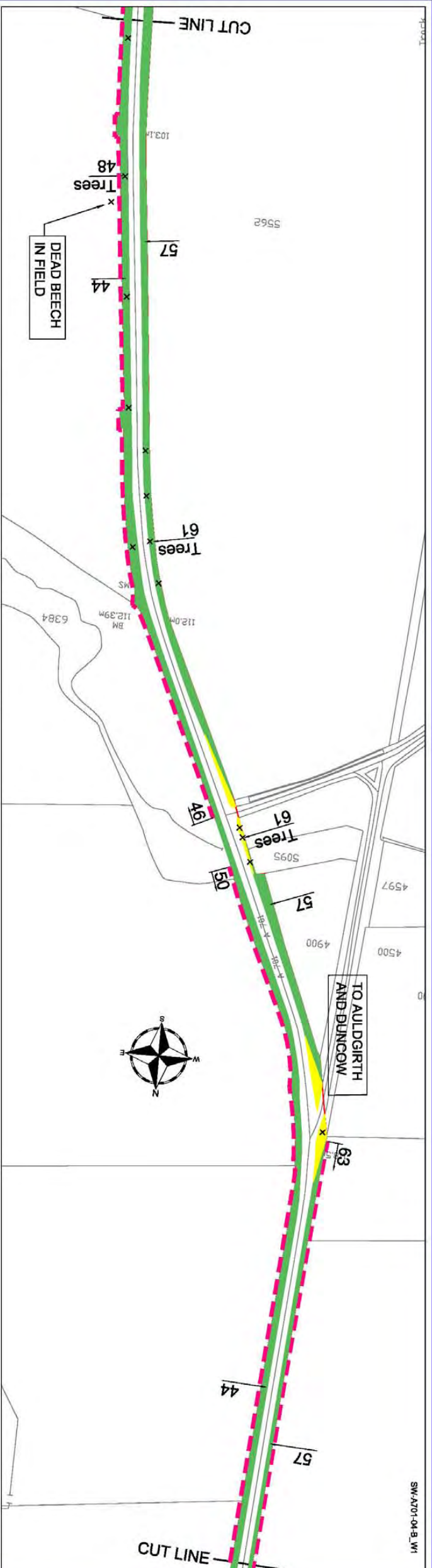











This Drawing is copyright and may not be reproduced in any form or used for construction without permission from Arney Highways.

This map is reproduced from the OS map by the Scottish Executive with the permission of Ordnance Survey on behalf of The Controller of Her Majesty's Stationary Office. (c) Crown Copyright. All rights reserved. Unauthorised reproduction infringes Crown Copyright and may lead to prosecution or civil proceedings.  
Licence Number: GB31355G001

### LEGEND

- |                                                                                       |                                                                         |
|---------------------------------------------------------------------------------------|-------------------------------------------------------------------------|
|  | <b>Grass</b><br>(a minimum of 14 cuts per annum)                        |
|  | <b>Grass</b><br>Medium Frequency cut<br>(a minimum of 7 cuts per annum) |
|  | <b>Grass</b><br>Low Frequency cut<br>(a minimum of 3 cuts per annum)    |
|  | <b>Visibility Splay</b> (Cutting Regime as above)                       |
|  | <b>Grass</b><br>Minimal Frequency cut<br>(1 Cut every 3 Years)          |
|  | <b>Hedges</b>                                                           |
|  | <b>Shrub Areas</b>                                                      |
|  | <b>Wetland Areas</b>                                                    |
|  | <b>Wildflower Areas</b>                                                 |
|  | <b>Woodland Areas</b>                                                   |

$x/y$  → Photo

⊗ **Specific Tree**

	Tree	Gradient
x		
!		

Scale
1:1250 @ A1
1:2500 @ A3

[illegible]

SCOTTISH EXECUTIVE

Unit Monomers

Arney Infrastructure Services



Glasgow tel.: 0141 781 6900  
 G69 7RW fax.: 0141 771 0893

**FAIRHURST**

Project Title

**3<sup>RD</sup> GENERATION TERM CONTRACT FOR  
MANAGEMENT AND MAINTENANCE OF  
THE SCOTTISH TRUNK ROAD NETWORK  
SOUTH WEST TRUNK ROAD UNIT**

Drawing Title

A701 TRUNK ROAD

## LANDSCAPE INVENTORY

Drawn	Date	Status
W.A.	April 2005	
Discarded	Date	

Doc Reference	3G-SW-A701-04-B
Approved	Date

Drawing No.:

A701 - SHEET 04 OF 12

## Revision

[illegible]



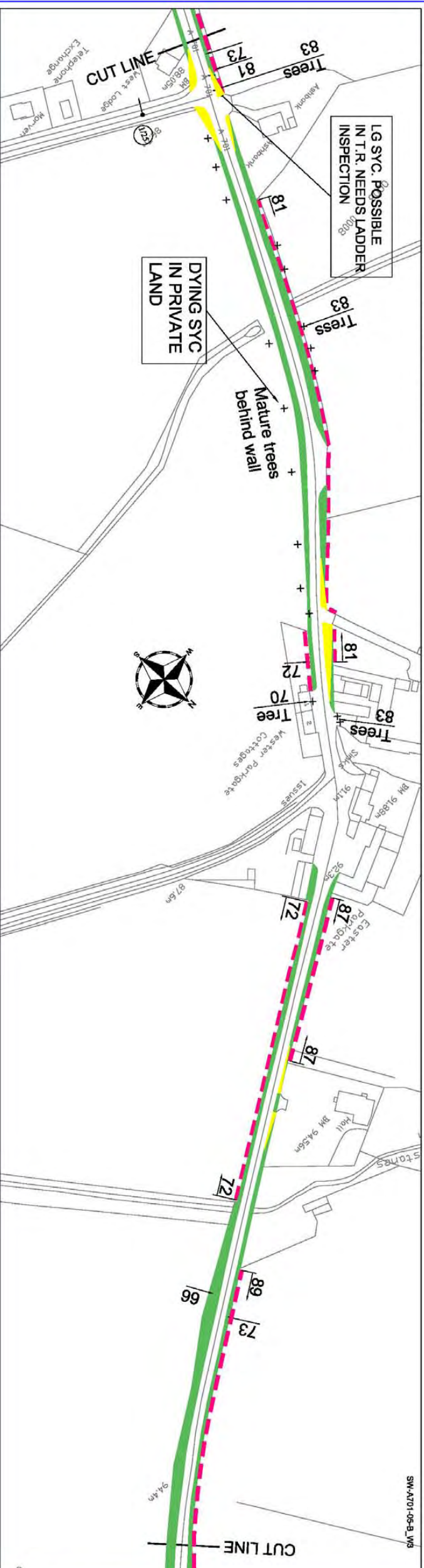
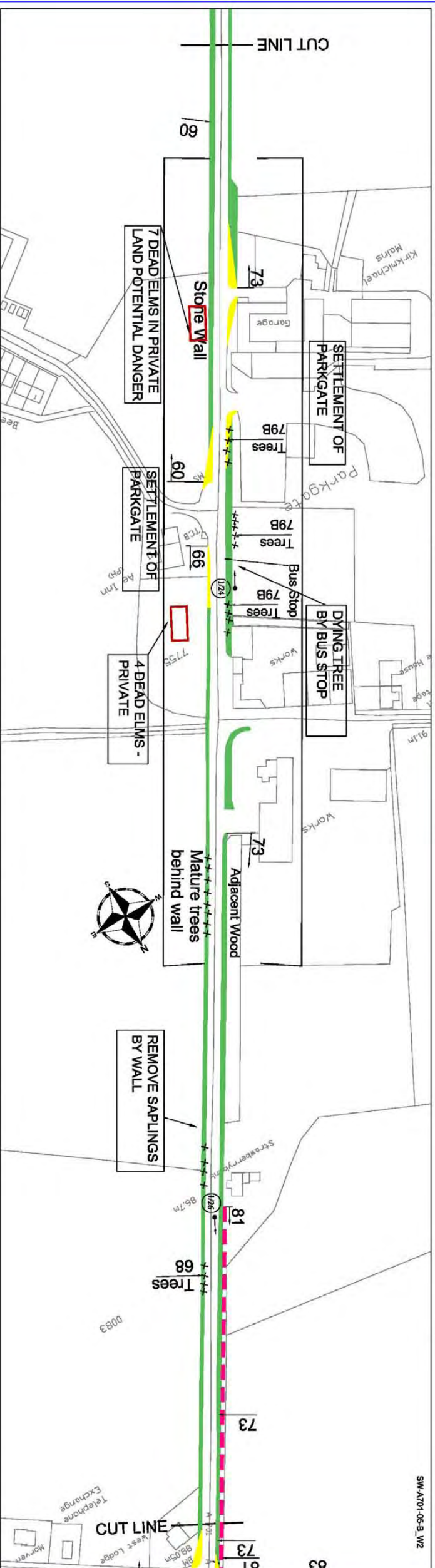
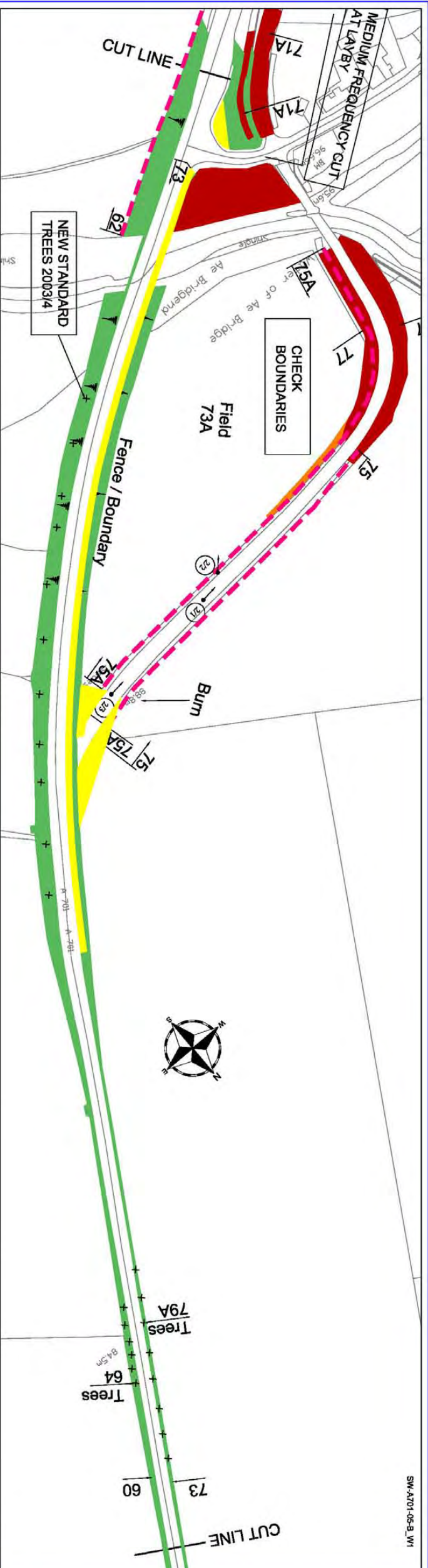















This Drawing is copyright and may not be reproduced in any form or used for construction without permission from Arney Highways.

This map is reproduced from the OS map by the Scottish Executive with the permission of Ordnance Survey on behalf of The Controller of Her Majesty's Stationary Office. (c) Crown Copyright. All rights reserved. Unauthorised reproduction infringes Crown Copyright and may lead to prosecution or civil proceedings.

Licence Number: GD31356001

LEGEND	
	Grass High Frequency cut (a minimum of 14 cuts per annum)
	Grass Medium Frequency cut (a minimum of 7 cuts per annum)
	Grass Low Frequency cut (a minimum of 3 cuts per annum)
	Visibility Spray (Cutting Regime as above)
	Grass Minimal Frequency cut (1 Cut every 3 years)
	Hedges
	Scrub Areas
	Shrub Areas
	Wetland Areas
	Wildflower Areas
	Woodland Areas
	Photo
	Specific Tree
	Tree
	Gradient

Scale

1:1250 @ A1

1:2500 @ A2

[illegible]

SCOTTISH EXECUTIVE

Unit Managers	Arney Infrastructure Services

**FAIRHURST**

**Project Title**  
**3<sup>RD</sup> GENERATION TERM CONTRACT FOR  
MANAGEMENT AND MAINTENANCE OF  
THE SCOTTISH TRUNK ROAD NETWORK  
SOUTH WEST TRUNK ROAD UNIT**

Drawing Title

A701 TRUNK ROAD  
LANDSCAPE INVENTORY

Drawn	Date	Status
W.A.	April 2005	
Checked	Date	
Approved	Date	Out Balance
		3G-SW-A701-06-B
Drawing No.		

A701 - SHEET 05 OF 12

A701 - SHEET 05 OF 12



This map is reproduced from the OS map by the Scottish Executive with the permission of Ordnance Survey on behalf of The Controller of Her Majesty's Stationary Office. (c) Crown Copyright. All rights reserved. Unauthorised reproduction infringes Crown Copyright and may lead to prosecution or civil proceedings.  
Licence Number: GDJ31356001



Grass	High Frequency cut (a minimum of 14 cuts per annum)
Grass	Medium Frequency cut (a minimum of 7 cuts per annum)
Grass	Low Frequency cut (a minimum of 3 cuts per annum)
Visibility Safety (Cutting Regime as above)	

**Grass**  
Minimal Frequency cut  
(1 Cut every 3 years)

## Hedges



**Scrub Areas**

Shrub Areas

Wetland Areas

**Wildflower Areas**

**Woodland Areas**

 Photo

⊗ Specific Tree

Gradient

Scale  
1:1250 @ A1  
1:2500 @ A3

[illegible]

SCOTTISH EXECUTIVE

Unit Managers

**Amey Infrastructure Services**



**FAIRHURST**

Drawing Title
---------------

A701 TRUNK ROAD

LANDSCAPE INVENTORY

Drawn	Date	Status
W.A.	April 2005	
Decided	Date	
Approved	Date	
Out Reference		3G-SW-A701-06-B

Drawing No.: A701 - SHEET 06 OF 12

### Revisions



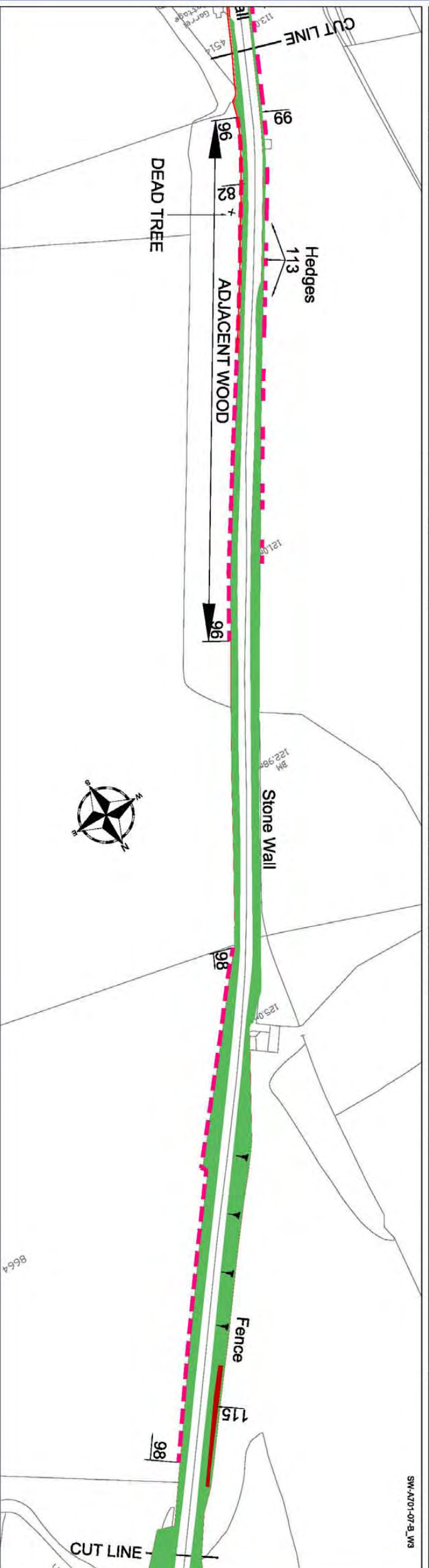
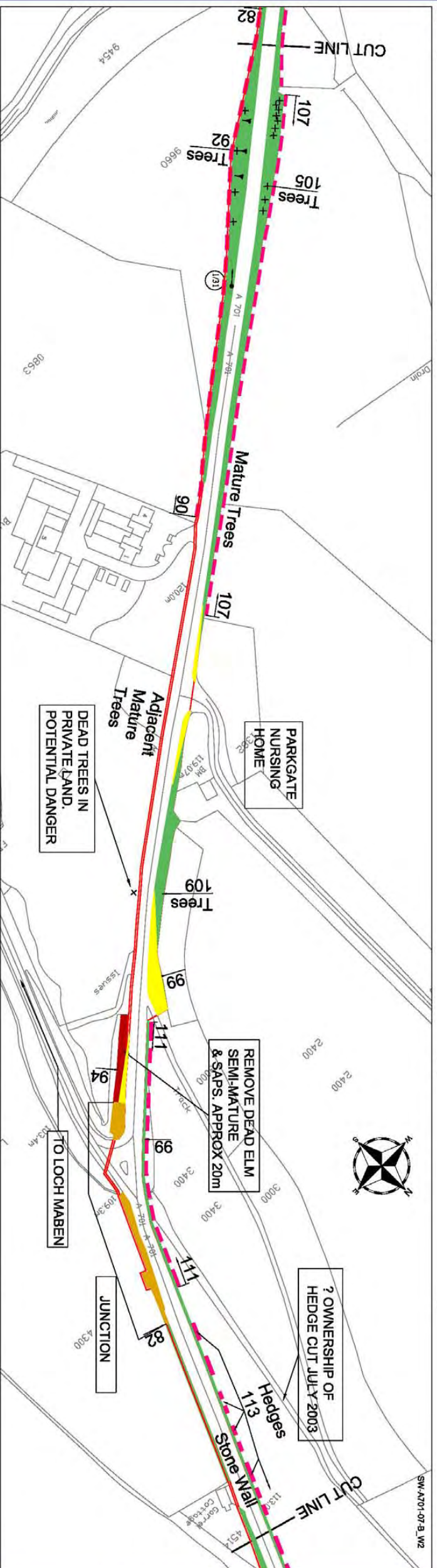
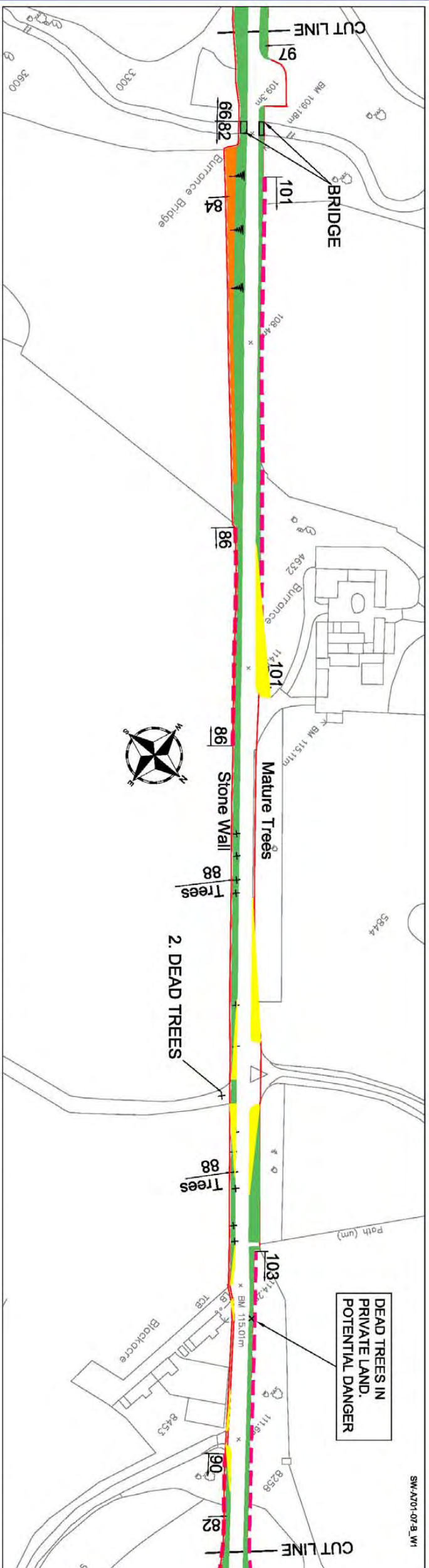

This Drawing is copyright and may not be reproduced in any form or used for construction without permission from Arney Highways.

This map is reproduced from the OS map by the Scottish Executive with the permission of Ordnance Survey on behalf of The Controller of Her Majesty's Stationary Office, (c) Crown Copyright. All rights reserved. Unauthorised reproduction infringes Crown Copyright and may lead to prosecution or civil proceedings.

Licence Number: GD3135G001

**LEGEND**

	Grass	High Frequency cut (a minimum of 14 cuts per annum)
	Grass	Medium Frequency cut (a minimum of 7 cuts per annum)
	Grass	Low Frequency cut (a minimum of 3 cuts per annum)
	<b>Visibility Splay</b> (Cutting Regime as above)	
	Grass	Minimal Frequency cut (1 Cut every 3 years)

Legend:

- Scrub Areas (Orange)
- Shrub Areas (Light Blue)
- Wetland Areas (Dark Blue)
- Wildflower Areas (Pink)
- Woodland Areas (Red)
- Photo (Circle with 'xy' and an arrow pointing to a dot)
- Specific Tree (Circle with an 'X')
- Tree (Circle with a cross)
- Gradient (Arrow pointing right)

Scale

1:1250 @ A1  
1:2500 @ A2

[illegible]

## SCOTTISH EXECUTIVE



**Arney Infrastructure Services**  
Langmuir Way  
Bargeddie  
Glasgow tel.: 0141 781 6900  
G69 7RW fax.: 0141 771 0993

**FAIRHURST**

**Project Title**  
3<sup>RD</sup> GENERATION TERM CONTRACT FOR  
MANAGEMENT AND MAINTENANCE OF  
THE SCOTTISH TRUNK ROAD NETWORK  
SOUTH WEST TRUNK ROAD UNIT

Drawing Title

A701 TRUNK ROAD

LANDSCAPE INVENTORY

Drawn	Date	Status
W.A.	April 2005	
Checked	Date	
Approved	Date	
Out Reference		3G-SW-A701-07-B

Drawing No.:

A701 - SHEET 07 OF 12



This map is reproduced from the OS map by the Scottish Executive with the permission of Ordnance Survey on behalf of The Controller of Her Majesty's Stationary Office. (c) Crown Copyright. All rights reserved. Unauthorised reproduction infringes Crown Copyright and may lead to prosecution or civil proceedings.

Licence Number: GD3356001



Scale  
1:1250 @ A1  
1:2500 @ A3



Arney Infrastructure Services  
Langmuir Way  
Bargedie  
Glasgow tel.: 0141 781 6900  
G69 7RW fax.: 0141 771 0893

SOUTH WEST TRUNK ROAD UNIT

LANDSCAPE INVENTORY











This map is reproduced from the OS map by the Scottish Executive with the permission of Ordnance Survey on behalf of The Controller of Her Majesty's Stationary Office. (c) Crown Copyright. All rights reserved. Unauthorised reproduction infringes Crown Copyright and may lead to prosecution or civil proceedings.

Licence Number: GB313556001



**LEGEND**

- Grass** (a minimum of 14 cuts per annum)
- Grass** (a minimum of 7 cuts per annum)
- Grass** (a minimum of 3 cuts per annum)
- Visibility Spray** (Cutting Regime as above)
- Grass** (Minimal Frequency cut (1 Cut every 3 years))

	Scrub Areas
	Shrub Areas
	Wetland Areas
	Wildflower Areas
	Woodland Areas
	Photo
	Specific Tree
x	Tree
	Gradient

100

[illegible]

SCOTTISH EXECUTIVE



**Arney Infrastructure Services**  
Langmuir Way  
Bargedie  
Glasgow tel.: 0141 781 6900  
G69 7RW fax.: 0141 771 0893

**Project Title**  
**3<sup>RD</sup> GENERATION TERM CONTRACT FOR  
MANAGEMENT AND MAINTENANCE OF  
THE SCOTTISH TRUNK ROAD NETWORK  
SOUTH WEST TRUNK ROAD UNIT**

A701 TRUNK ROAD  
LANDSCAPE INVENTORY

Drawn	Date	Status
W.A.	April 2005	
Checked	Date	Old Reference 3G-SW-A701-09-B
Approved	Date	



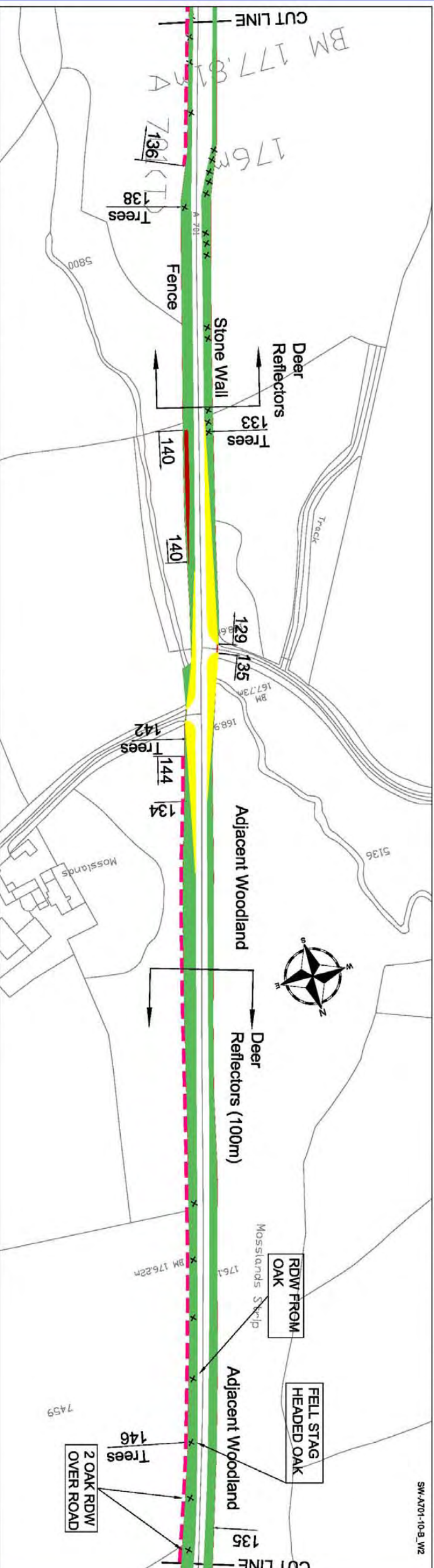
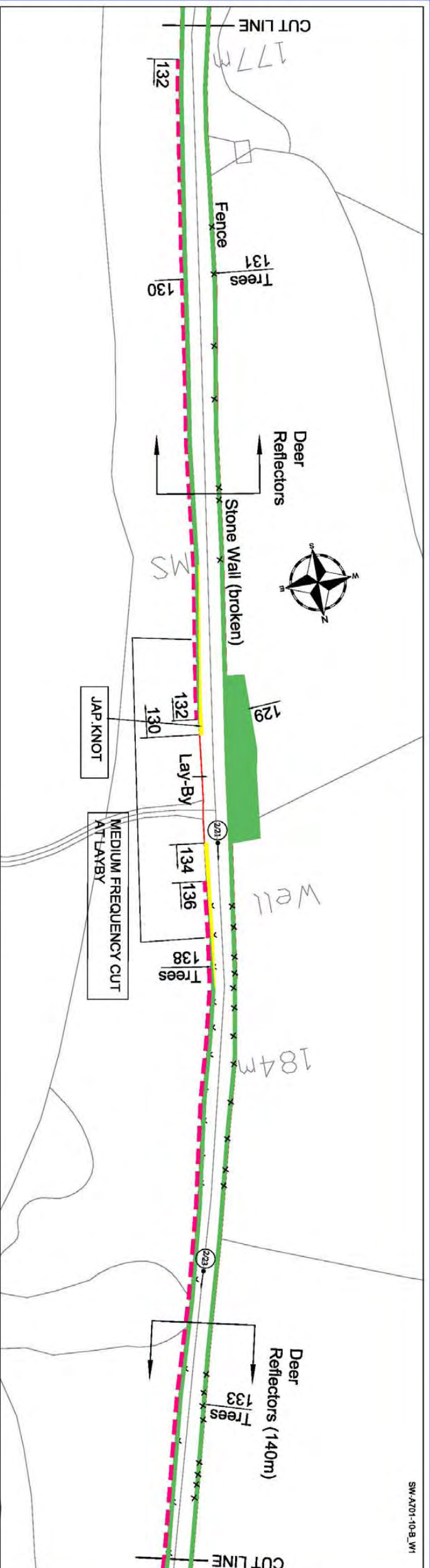

This Drawing is copyright and may not be reproduced in any form or used for construction without permission from Arney Highways.

This map is reproduced from the OS map by the Scottish Executive with the permission of Ordnance Survey on behalf of The Controller of Her Majesty's Stationary Office (c) Crown Copyright. All rights reserved. Unauthorised reproduction infringes Crown Copyright and may lead to prosecution or civil proceedings.

Licence Number: G03135/G001

LEGEND	
	Grass High Frequency cut (a minimum of 14 cuts per annum)
	Grass Medium Frequency cut (a minimum of 7 cuts per annum)
	Grass Low Frequency cut (a minimum of 3 cuts per annum)
	Visibility Spray (Cutting Regime as above)
	Grass Minimal Frequency cut (1 Cut every 3 years)
	Hedges

Legend:

- Scrub Areas (Orange rectangle)
- Shrub Areas (Light blue rectangle)
- Wetland Areas (Dark blue rectangle)
- Wildflower Areas (Pink rectangle)
- Woodland Areas (Red rectangle)
- Photo (Circle with 'x/y' and an arrow pointing down)
- Specific Tree (Circle with an 'X')
- Tree (Circle with a cross)
- Gradient (Circle with a triangle)

[illegible]

Unit Monograms Arney Infrastructure Services



Glasgow tel.: 0141 781 6900  
G69 7RW fax.: 0141 771 0893

**FAIRHURST**

**Project Title**  
3<sup>RD</sup> GENERATION TERM CONTRACT FOR  
MANAGEMENT AND MAINTENANCE OF  
THE SCOTTISH TRUNK ROAD NETWORK  
SOUTH WEST TRUNK ROAD UNIT

Drawing Title

A701 TRUNK ROAD  
LANDSCAPE INVENTORY

Drawn	Date	Status
W.A.	April 2005	
Ordered	Date	
Approved	Date	

3G-SW-A701-10-B

Drawing No.:  
Revision:  
A701 - SHEET 10 OF 12



This map is reproduced from the OS map by the Scottish Executive with the permission of Ordnance Survey on behalf of The Controller of Her Majesty's Stationery Office. (c) Crown Copyright. All rights reserved. Unauthorised reproduction infringes Crown Copyright and may lead to prosecution or civil proceedings.

Licence Number: GDB135/G001

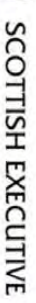

	Scale
x Tree	1:1250 @ A1
Gradient	1:2500 @ A3

**FAIRHURST**

Drawing Title

Issue	Date	Student
W.A.	April 2005	
Checked	Date	
Approved	Date	

3G-SW-A701-11-B

Revision:



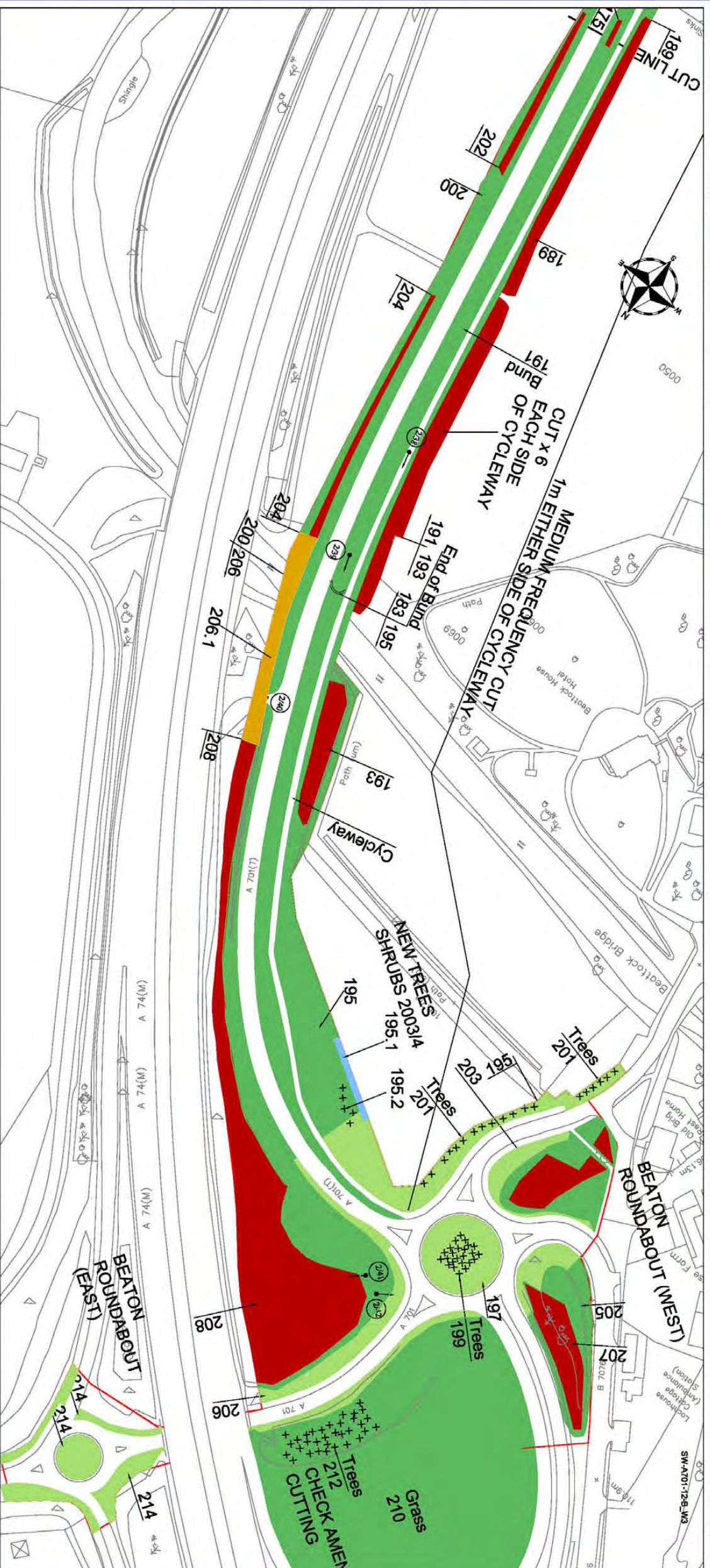
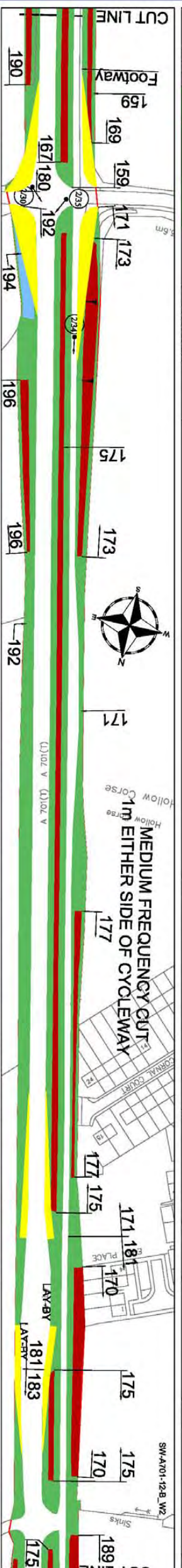
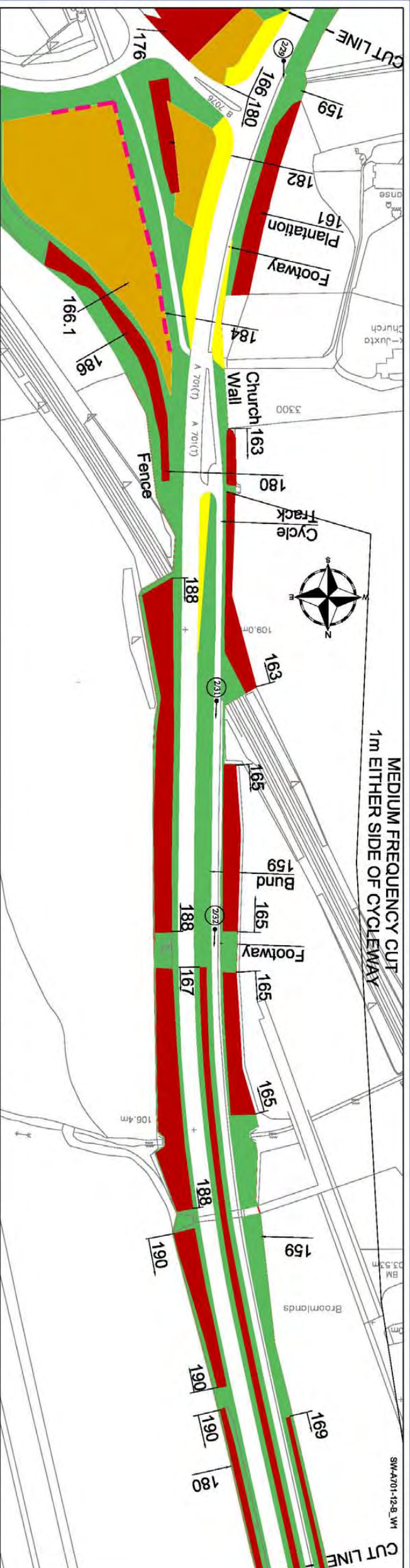





This Drawing is copyright and may not be reproduced in any form or used for construction without permission from Arney Highways.

This map is reproduced from the OS map by the Scottish Executive with the permission of Ordnance Survey on behalf of The Controller of Her Majesty's Stationary Office. (c) Crown Copyright. All rights reserved. Unauthorised reproduction infringes Crown Copyright and may lead to prosecution or civil proceedings.

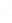
Licence Number: 50313560001

LEGEND	
	Grass High Frequency, cut (a minimum of 14 cuts per annum)
	Grass Medium Frequency, cut (a minimum of 7 cuts per annum)
	Grass Low Frequency, cut (a minimum of 3 cuts per annum)
	Visibility Spray (Cutting Regime as above)
	Grass Minimal Frequency, cut (1 Cut every 3 years)
	Hedges

Photo

$x/y$

⊗ Specific Tree

x Tree

✓ Gradient

Scale

1:1250 @ A1

4:2500 @ A2

[illegible]

SCOTTISH EXECUTIVE



**Arney Infrastructure Services**  
Langmuir Way  
Bangeddie  
Glasgow tel.: 0141 781 6900  
G69 7RW fax.: 0141 771 0893

**Project Title**  
3<sup>RD</sup> GENERATION TERM CONTRACT FOR  
MANAGEMENT AND MAINTENANCE OF  
THE SCOTTISH TRUNK ROAD NETWORK  
SOUTH WEST TRUNK ROAD UNIT

A701 TRUNK ROAD  
LANDSCAPE INVENTORY

Drawn By:	Date:	Notes:
Approved:	Date:	
		Out Balance
		3G-SW-A701-12-B