

- Figure 13.1a**
- Legend**
- Proposed scheme (DMRB Stage 3)
 - SuDS
 - Boundaries of the Site
 - 250m Study Area
 - 850m Study Area
- Land Capability for Agriculture**
- Land capable of supporting arable agriculture
- Class 1
 - Class 2
 - Class 3.1
- Land capable of supporting mixed agriculture
- Class 3.2
 - Class 4.1
 - Class 4.2
- Land capable of supporting improved grassland
- Class 5.2
- Land capable of supporting only rough grazing
- Class 6.2
 - Class 6.3
- Land of very limited agricultural value
- Class 7

* Where land has not been classed or is defined as "Urban" the underlying OS Map has been left uncovered

Rev.	Rev. Date	Purpose of revision	Orig/Dwn	Checkd	Rev'd	Apprv'd
P03	MAY 2025	For Stage Approval				

Jacobs
95 Bothwell Street, Glasgow G2 7HX, UK.
Tel: +44(0)141 243 8000
www.jacobs.com

Client

TRANSPORT SCOTLAND
CÒRMDHAIL ALBA

Project

A9 DUALLING
PASS OF BIRNAM TO TAY CROSSING

Drawing title

Environmental Impact Assessment Report
Land Capability for Agriculture
Classifications

Sheet 1 of 5

Drawing Status	S4 – For Stage Approval	
Scale	1:10,000 @ A3	DO NOT SCALE
Jacobs No.	B2140002	
BIM No.	A9P02-JAC-EGT-D_ZZZZZ_ZZ-FG-EN-0001	
Drawing number	Figure 13.1a	Rev P03

© Crown copyright 2025. You may re-use this information (excluding logos) free of charge in any format or medium, under the terms of the Open Government Licence. To view this licence, visit <http://www.nationalarchives.gov.uk/doc/open-government-licence/> or e-mail psi@nationalarchives.gsi.gov.uk. Where we have identified any third party copyright information you will need to obtain permission from the copyright holders concerned. Limitation: This drawing has been prepared on behalf of, and for the exclusive use of Jacobs' Client, and is subject to, and issued in accordance with, the provisions of the contract between Jacobs and the Client. Jacobs accepts no liability or responsibility whatsoever for, or in respect of, any use of, or reliance upon, this drawing by any third party.



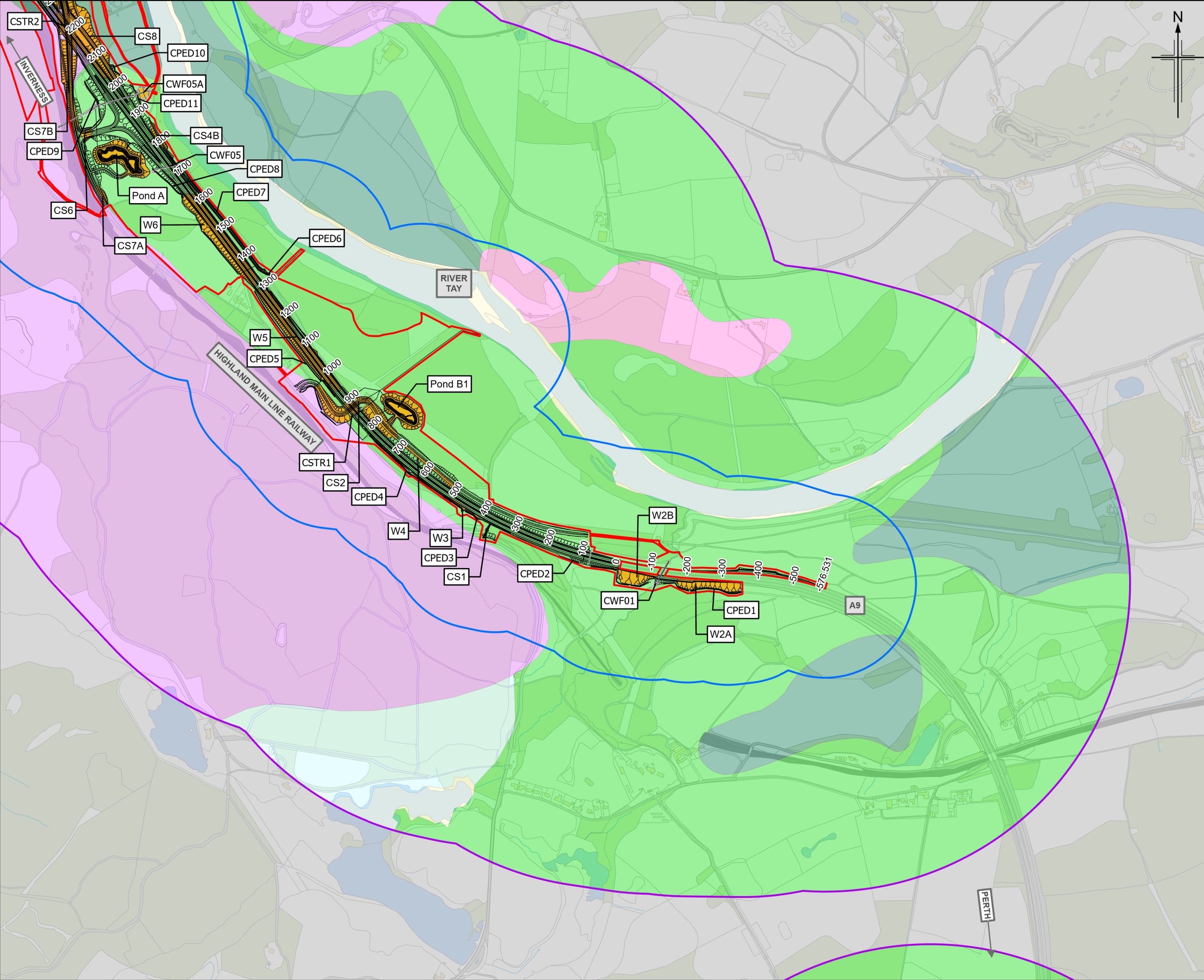

Figure 13.1b

Legend

- Proposed scheme (DMRB Stage 3)
- SuDS
- Boundaries of the Site
- 250m Study Area
- 850m Study Area
- Land Capability for Agriculture**
- Land capable of supporting arable agriculture
 - Class 1
 - Class 2
 - Class 3.1
- Land capable of supporting mixed agriculture
 - Class 3.2
 - Class 4.1
 - Class 4.2
- Land capable of supporting improved grassland
 - Class 5.2
- Land capable of supporting only rough grazing
 - Class 6.2
 - Class 6.3
- Land of very limited agricultural value
 - Class 7

* Where land has not been classed or is defined as "Urban" the underlying OS Map has been left uncovered

P03	MAY 2025	For Stage Approval	PM	LR	GK	EM
Rev.	Rev. Date	Purpose of revision	Orig/Dwn	Checked	Rev'd	Appr'd

Jacobs

95 Bothwell Street, Glasgow, G2 7HX, UK.
Tel: +44(0)141 243 8000
www.jacobs.com

Client

TRANSPORT SCOTLAND
CORRIDOR ALBA

Project

A9 DUALING
PASS OF BIRNAM TO TAY CROSSING

Drawing title

Environmental Impact Assessment Report
Land Capability for Agriculture
Classifications

Sheet 2 of 5

Drawing Status	S4 – For Stage Approval	DO NOT SCALE
Scale	1:10,000 @ A3	
Jacobs No.	B2140002	
BIM No.	A9P02-JAC-EGT-D_ZZZZZ_ZZ-FG-EN-0001	
Drawing number	Figure 13.1b	Rev P03

© Crown copyright 2025. You may re-use this information (excluding logos) free of charge in any format or medium, under the terms of the Open Government Licence. To view this licence, visit <http://www.nationalarchives.gov.uk/open-government-licence/> or e-mail psi@nationalarchives.gsi.gov.uk. Where we have identified any third party copyright information you will need to obtain permission from the copyright holders concerned. Limitation: This drawing has been prepared on behalf of, and for the exclusive use of Jacobs' Client, and is subject to, and issued in accordance with, the provisions of the contract between Jacobs and the Client. Jacobs accepts no liability or responsibility whatsoever for, or in respect of, any use of, or reliance upon, this drawing by any third party.

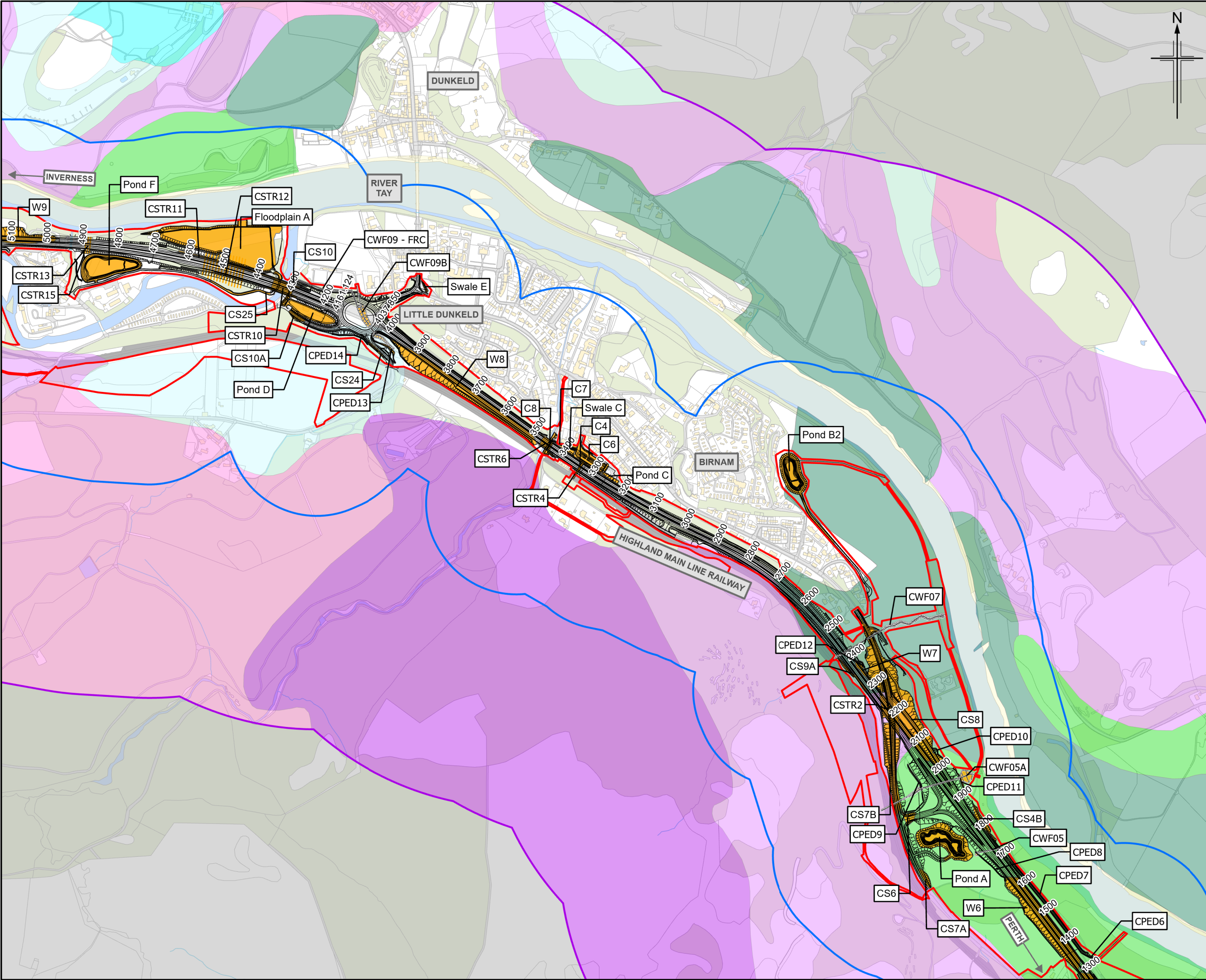

Figure 13.1c

Legend

Proposed scheme (DMRB Stage 3)

SuDS

Boundaries of the Site

250m Study Area

850m Study Area

Land Capability for Agriculture

Land capable of supporting arable agriculture

- Class 1
- Class 2
- Class 3.1

Land capable of supporting mixed agriculture

- Class 3.2
- Class 4.1
- Class 4.2

Land capable of supporting improved grassland

- Class 5.2

Land capable of supporting only rough grazing

- Class 6.2
- Class 6.3

Land of very limited agricultural value

- Class 7

* Where land has not been classed or is defined as "Urban" the underlying OS Map has been left uncovered

P03	MAY 2025	For Stage Approval	PM	LR	GK	EM
Rev.	Rev. Date	Purpose of revision	Orig/Dwn	Checked	Rev'd	Apprv'd

Jacobs

95 Bothwell Street, Glasgow G2 7HX, UK.
Tel: +44(0)141 243 8000
www.jacobs.com

Client

TRANSPORT SCOTLAND
COMHDAHL ALBA

Project

A9 DUALLING
PASS OF BIRNAM TO TAY CROSSING

Drawing title

Environmental Impact Assessment Report
Land Capability for Agriculture
Classifications

Sheet 3 of 5

Drawing Status	S4 – For Stage Approval
Scale	1:10,000 @ A3 DO NOT SCALE
Jacobs No.	B2140002
BIM No.	A9P02-JAC-EGT-D_ZZZZZ_ZZ-FG-EN-0001
Drawing number	Figure 13.1c
Rev	P03

© Crown copyright and database right 2025. You may re-use this information (excluding logos) free of charge in any format or medium, under the terms of the Open Government Licence. To view this licence, visit <http://www.nationalarchives.gov.uk/open-government-licence/> or e-mail psi@nationalarchives.gsi.gov.uk. Where we have identified any third party copyright information you will need to obtain permission from the copyright holders concerned.

Limitation: This drawing has been prepared on behalf of, and for the exclusive use of Jacobs' Client, and is subject to, and issued in accordance with, the provisions of the contract between Jacobs and the Client. Jacobs accepts no liability or responsibility whatsoever for, or in respect of, any use of, or reliance upon, this drawing by any third party.

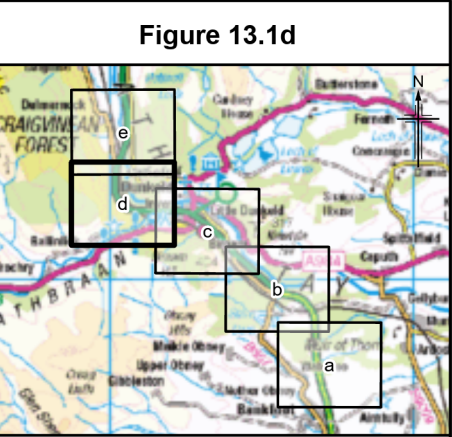
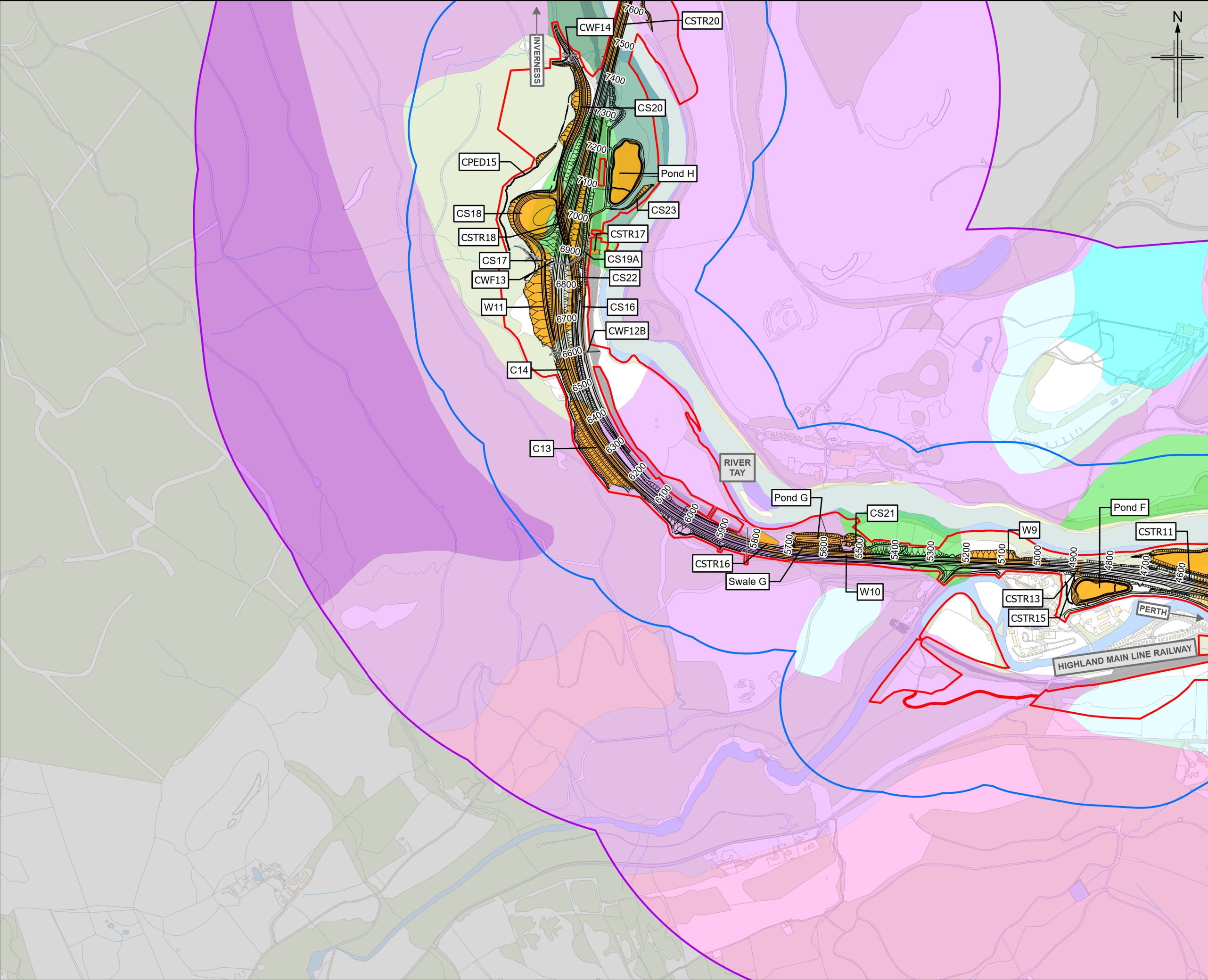

- Figure 13.1d**
- Legend**
- Proposed scheme (DMRB Stage 3)
 - SuDS
 - Boundaries of the Site
 - 250m Study Area
 - 850m Study Area
 - Land Capability for Agriculture**
 - Land capable of supporting arable agriculture
 - Class 1
 - Class 2
 - Class 3.1
 - Land capable of supporting mixed agriculture
 - Class 3.2
 - Class 4.1
 - Class 4.2
 - Land capable of supporting improved grassland
 - Class 5.2
 - Land capable of supporting only rough grazing
 - Class 6.2
 - Class 6.3
 - Land of very limited agricultural value
 - Class 7

* Where land has not been classed or is defined as "Urban" the underlying OS Map has been left uncovered

Rev.	Rev. Date	Purpose of revision	Orig/Dwn	Checked	Rev'd	Apprv'd
P03	MAY 2025	For Stage Approval				

Jacobs
95 Bothwell Street, Glasgow G2 7HX, UK.
Tel: +44(0)141 243 8000
www.jacobs.com

Client
Transport Scotland
COMHAIL ALBA

Project
A9 DUALLING
PASS OF BIRNAM TO TAY CROSSING

Drawing title
Environmental Impact Assessment Report
Land Capability for Agriculture
Classifications

Sheet 4 of 5

Drawing Status	S4 – For Stage Approval
Scale	1:10,000 @ A3 DO NOT SCALE
Jacobs No.	B2140002
BIM No.	A9P02-JAC-EGT-D_ZZZZZ_ZZ-FG-EN-0001
Drawing number	Figure 13.1d
Rev	P03

© Crown copyright 2025. You may re-use this information (excluding logos) free of charge in any format or medium, under the terms of the Open Government Licence. To view this licence, visit <http://www.nationalarchives.gov.uk/doc/open-government-licence/> or e-mail psi@nationalarchives.gsi.gov.uk. Where we have identified any third party copyright information you will need to obtain permission from the copyright holders concerned. Limitation: This drawing has been prepared on behalf of, and for the exclusive use of Jacobs' Client, and is subject to, and issued in accordance with, the provisions of the contract between Jacobs and the Client. Jacobs accepts no liability or responsibility whatsoever for, or in respect of, any use of, or reliance upon, this drawing by any third party.



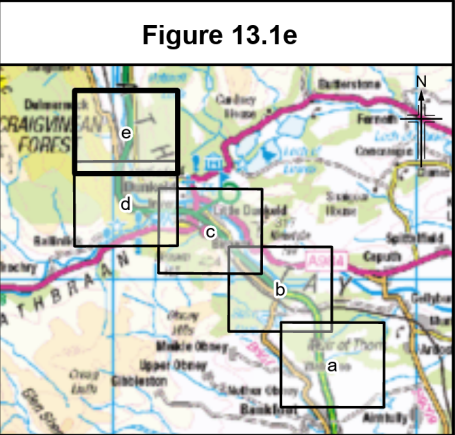
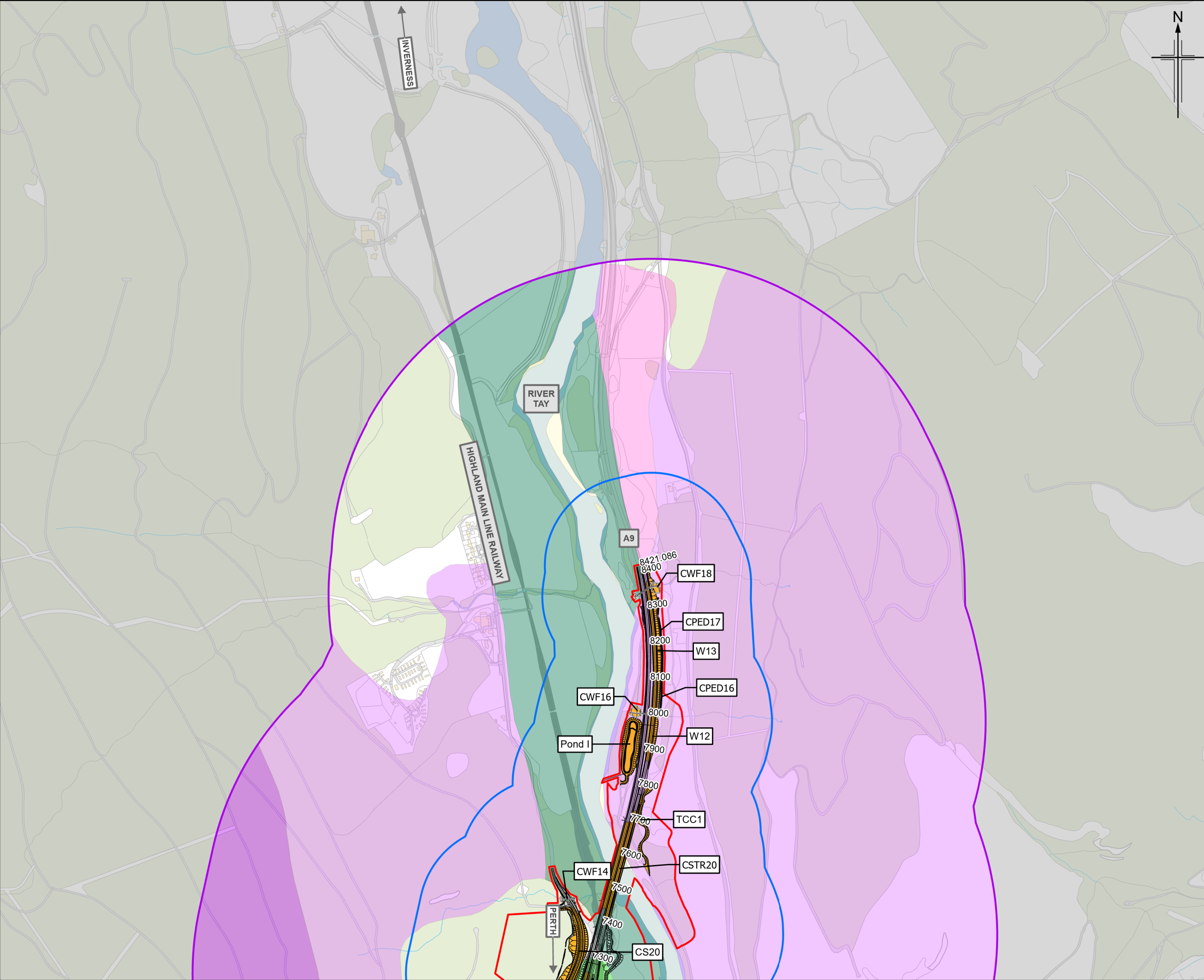

- Figure 13.1e**
- Legend**
- Proposed scheme (DMRB Stage 3)
 - SuDS
 - Boundaries of the Site
 - 250m Study Area
 - 850m Study Area
 - Land Capability for Agriculture**
 - Land capable of supporting arable agriculture
 - Class 1
 - Class 2
 - Class 3.1
 - Land capable of supporting mixed agriculture
 - Class 3.2
 - Class 4.1
 - Class 4.2
 - Land capable of supporting improved grassland
 - Class 5.2
 - Land capable of supporting only rough grazing
 - Class 6.2
 - Class 6.3
 - Land of very limited agricultural value
 - Class 7

* Where land has not been classed or is defined as "Urban" the underlying OS Map has been left uncovered

P03	MAY 2025	For Stage Approval	PM	LR	GK	EM
Rev.	Rev. Date	Purpose of revision	Orig/Dwn	Checkd	Rev'd	Apprv'd

Jacobs

95 Bothwell Street, Glasgow, G2 7HX, UK.
Tel: +44(0)141 243 8000
www.jacobs.com



Drawing title

**Environmental Impact Assessment Report
Land Capability for Agriculture
Classifications**

Sheet 5 of 5

Drawing Status	S4 – For Stage Approval	DO NOT SCALE
Scale	1:10,000 @ A3	
Jacobs No.	B2140002	
BIM No.	A9P02-JAC-EGT-D_ZZZZZ_ZZ-FG-EN-0001	
Drawing number	Figure 13.1e	Rev P03

© Crown copyright 2025. You may re-use this information (excluding logos) free of charge in any format or medium, under the terms of the Open Government Licence. To view this licence, visit <http://www.nationalarchives.gov.uk/doc/open-government-licence/> or e-mail psi@nationalarchives.gsi.gov.uk. Where we have identified any third party copyright information you will need to obtain permission from the copyright holders concerned. Limitation: This drawing has been prepared on behalf of, and for the exclusive use of Jacobs' Client, and is subject to, and issued in accordance with, the provisions of the contract between Jacobs and the Client. Jacobs accepts no liability or responsibility whatsoever for, or in respect of, any use of, or reliance upon, this drawing by any third party.

