

Figure 13.3a

Legend

- Proposed scheme (DMRB Stage 3)
- SuDS
- 250m Study Area
- 850m Study Area
- Cuttings

Potential Land Contamination Information

- Potential contaminative source

P03	MAY 2025	For Stage Approval	PM	LR	GK	EM
Rev.	Rev. Date	Purpose of revision	Orig/Dwn	Checked	Rev'd	Apprv'd
<div>Jacobs</div> <div>95 Bothwell Street, Glasgow, G2 7HX, UK. Tel: +44(0)141 243 8000 www.jacobs.com</div>						
Client <div><div></div><div>TRANSPORT SCOTLAND</div><div>COPIHDAHL ALBA</div></div>						
Project <div><div></div><div>A9</div><div>DUALING</div><div>PASS OF BIRNAM TO TAY CROSSING</div></div>						
Drawing title						
Environmental Impact Assessment Report Potential Land Contamination Sources						
Sheet 1 of 4						
Drawing Status	S4 – For Stage Approval					
Scale	1:10,000	@ A3	DO NOT SCALE			
Jacobs No.	B2140002					
BIM No.	A9P02-JAC-EGT-D_ZZZZZ_ZZ-FG-EN-0003					
Drawing number	Figure 13.3a					Rev P03

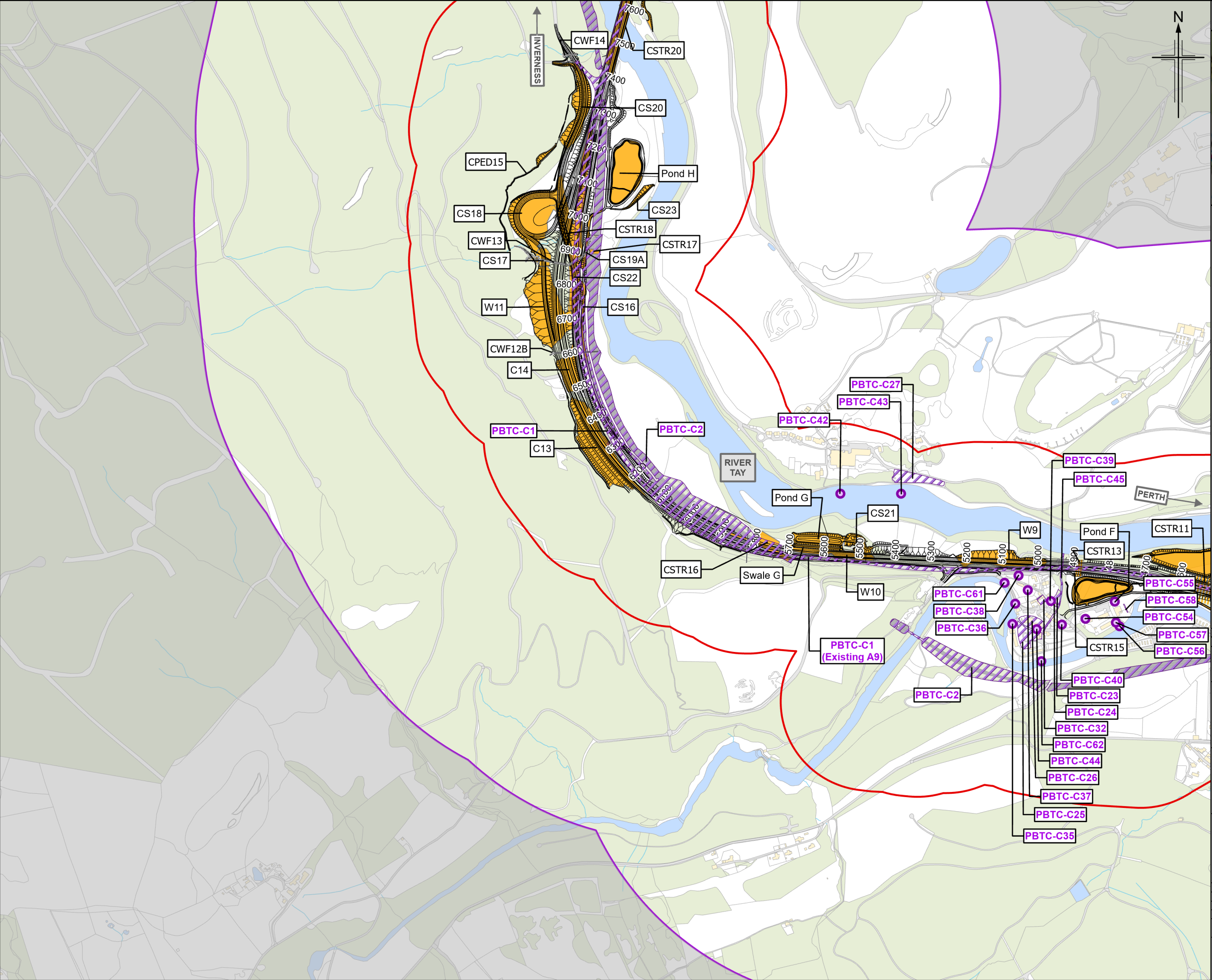

Figure 13.3c

Legend

- Proposed scheme (DMRB Stage 3)
- SuDS
- 250m Study Area
- 850m Study Area
- Cuttings
- Potential Land Contamination Information
 - Potential contaminative source

P03	MAY 2025	For Stage Approval	PM	LR	GK	EM
Rev.	Rev. Date	Purpose of revision	Orig/Dwn	Checkd	Rev'd	Apprv'd

Jacobs
95 Bothwell Street, Glasgow, G2 7HX, UK.
Tel: +44(0)141 243 8000
www.jacobs.com

Client
Transport Scotland
COMHAIL ALBA

Project
A9 DUALLING
PASS OF BIRNAM TO TAY CROSSING

Drawing title
Environmental Impact Assessment Report
Potential Land Contamination Sources

Sheet 3 of 4

Drawing Status	S4 – For Stage Approval	
Scale	1:10,000 @ A3	DO NOT SCALE
Jacobs No.	B2140002	
BIM No.	A9P02-JAC-EGT-D_ZZZZZ_ZZ-FG-EN-0003	
Drawing number	Figure 13.3c	Rev P03

© Crown copyright 2025. You may re-use this information (excluding logos) free of charge in any format or medium, under the terms of the Open Government Licence. To view this licence, visit <http://www.nationalarchives.gov.uk/doc/open-government-licence/> or e-mail psi@nationalarchives.gsi.gov.uk. Where we have identified any third party copyright information you will need to obtain permission from the copyright holders concerned. Limitation: This drawing has been prepared on behalf of, and for the exclusive use of Jacobs' Client, and is subject to, and issued in accordance with, the provisions of the contract between Jacobs and the Client. Jacobs accepts no liability or responsibility whatsoever for, or in respect of, any use of, or reliance upon, this drawing by any third party.

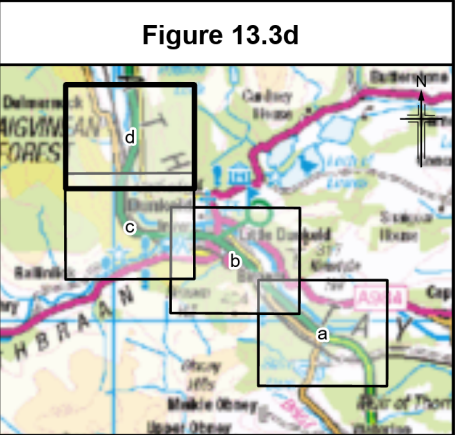
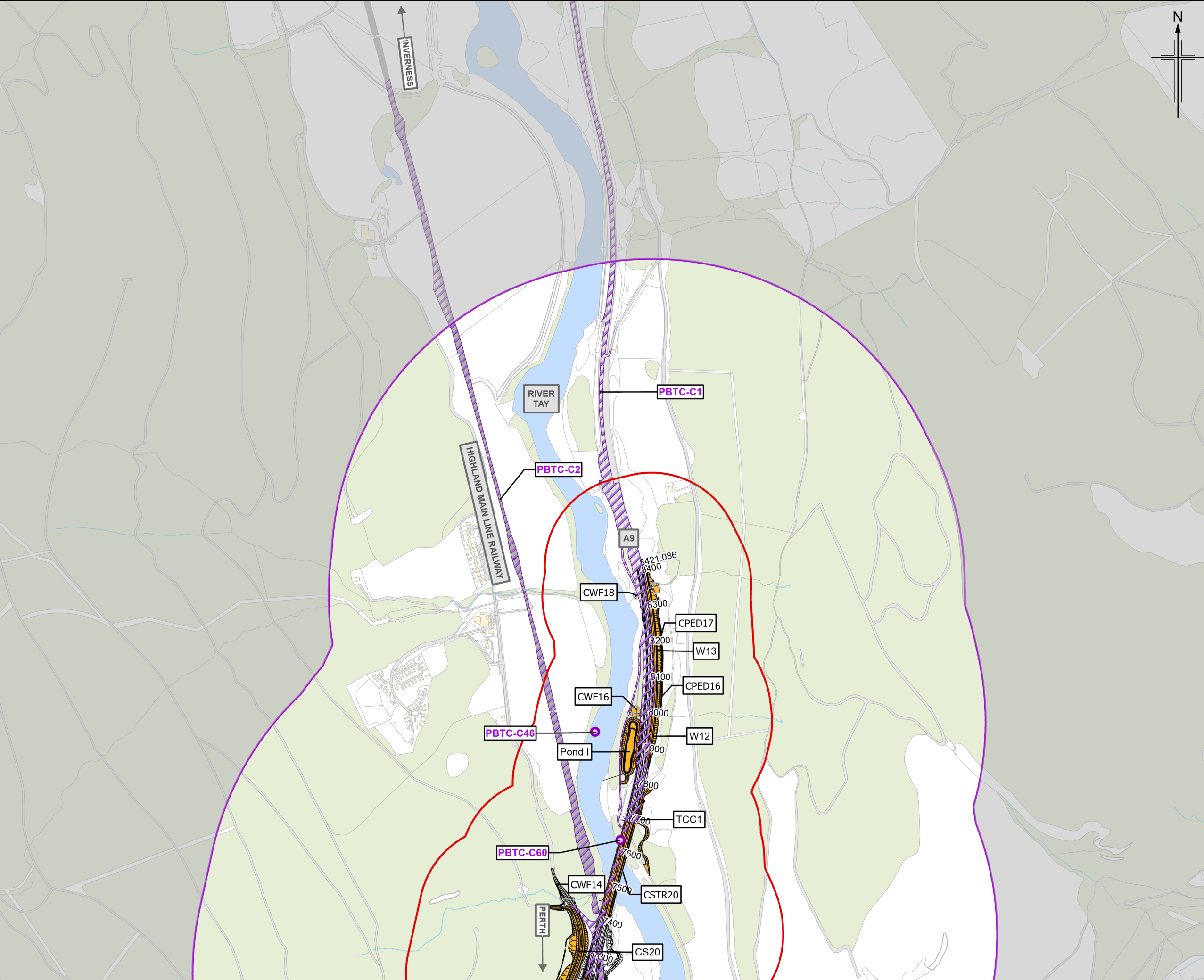

- Legend**
- Proposed scheme (DMRB Stage 3)
 - SuDS
 - 250m Study Area
 - 850m Study Area
 - Cuttings
 - Potential Land Contamination Information
 - Potential contaminative source

Rev.	Rev. Date	Purpose of revision	Orig/Dwn	Checkd	Rev'd	Apprv'd
P03	MAY 2025	For Stage Approval	PM	LR	GK	EM

Jacobs
95 Bothwell Street, Glasgow, G2 7HX, UK.
Tel: +44(0)141 243 8000
www.jacobs.com



**Environmental Impact Assessment Report
Potential Land Contamination Sources**

Sheet 4 of 4

Drawing Status	S4 – For Stage Approval	Rev
Scale	1:10,000 @ A3	DO NOT SCALE
Jacobs No.	B2140002	
BIM No.	A9P02-JAC-EGT-D_ZZZZZ_ZZ-FG-EN-0003	
Drawing number	Figure 13.3d	Rev P03

© Crown copyright 2025. You may re-use this information (excluding logos) free of charge in any format or medium, under the terms of the Open Government Licence. To view this licence, visit <http://www.nationalarchives.gov.uk/doc/open-government-licence/> or e-mail: psi@nationalarchives.gsi.gov.uk. Where we have identified any third party copyright information you will need to obtain permission from the copyright holders concerned. Limitation: This drawing has been prepared on behalf of, and for the exclusive use of Jacobs' Client, and is subject to, and issued in accordance with, the provisions of the contract between Jacobs and the Client. Jacobs accepts no liability or responsibility whatsoever for, or in respect of, any use of, or reliance upon, this drawing by any third party.