

- Legend**
- Proposed scheme (DMRB Stage 3)
 - SuDS
 - Boundaries of the Site
 - 200m Study Area
 - Category A Listed Building
 - Category B Listed Building
 - Category C Listed Building
 - Conservation Area
 - Scheduled Monument
 - Undesignated archaeological remains and historic buildings

P03	MAY 2025	For Stage Approval	MM	JD	GK	EM
Rev.	Rev. Date	Purpose of revision	Orig/Dwn	Checkd	Rev'd	Apprv'd

Jacobs
95 Bothwell Street, Glasgow G2 7HX, UK.
Tel: +44(0)141 243 8000
www.jacobs.com



Drawing title

Archaeological Remains and Historic Buildings

Sheet 1 of 10		
Drawing Status	S4 – For Stage Approval	
Scale	1:5,000 @ A3	DO NOT SCALE
Jacobs No.	B2140002	
BIM No.	A9P02-JAC-EHR-D_ZZZZZ_ZZ-FG-EN-0001	
Drawing number	Figure 9.1a	Rev P03

© Crown copyright 2025. You may re-use this information (excluding logos) free of charge in any format or medium, under the terms of the Open Government Licence. To view this licence, visit <http://www.nationalarchives.gov.uk/doc/open-government-licence/> or e-mail: psi@nationalarchives.gsi.gov.uk. Where we have identified any third party copyright information you will need to obtain permission from the copyright holders concerned. Limitation: This drawing has been prepared on behalf of, and for the exclusive use of Jacobs' Client, and is subject to, and issued in accordance with, the provisions of the contract between Jacobs and the Client. Jacobs accepts no liability or responsibility whatsoever for, or in respect of, any use of, or reliance upon, this drawing by any third party.

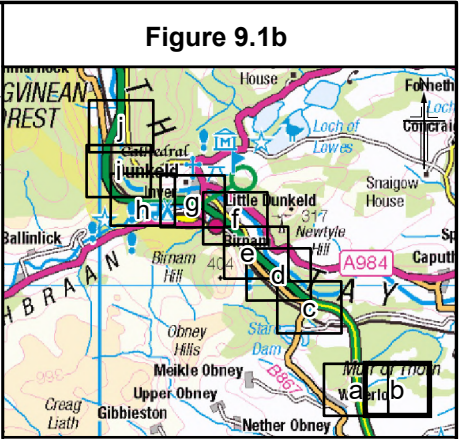
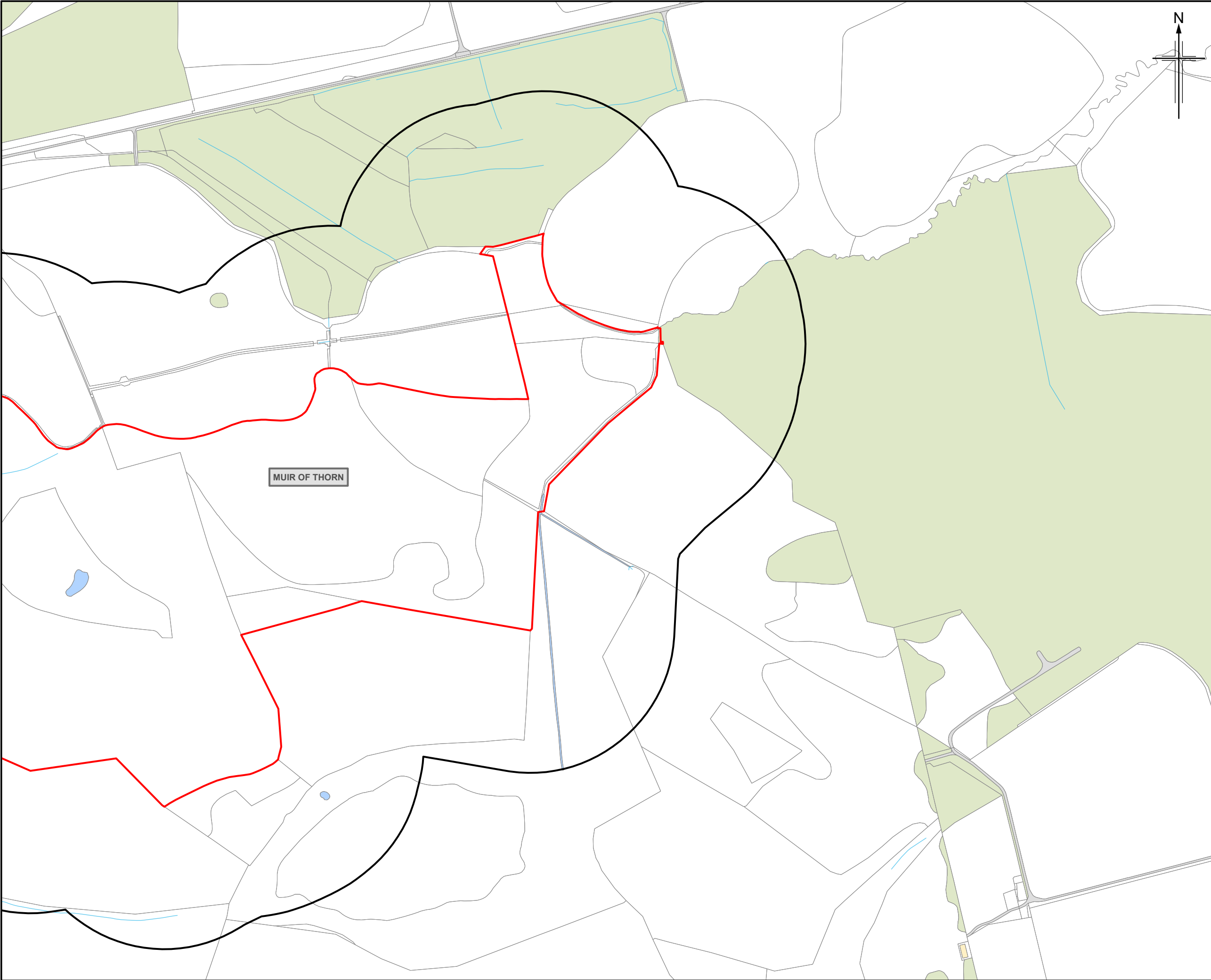

- Legend**
- Proposed scheme (DMRB Stage 3)
 - SuDS
 - Boundaries of the Site
 - 200m Study Area
 - Category A Listed Building
 - Category B Listed Building
 - Category C Listed Building
 - Conservation Area
 - Scheduled Monument
 - Undesignated archaeological remains and historic buildings

P03	MAY 2025	For Stage Approval	MM	JD	GK	EM
Rev.	Rev. Date	Purpose of revision	Orig/Dwn	Checked	Rev'd	Apprv'd

Jacobs
95 Bothwell Street, Glasgow, G2 7HX, UK.
Tel: +44(0)141 243 8000
www.jacobs.com

Client

TRANSPORT SCOTLAND
CÒRMDHAIL ALBA

Project

A9 DUALLING
TAY CROSSING TO BALLINLUIG

Drawing title

Archaeological Remains and Historic Buildings

Sheet 2 of 10

Drawing Status	S4 – For Stage Approval
Scale	1:5,000 @ A3 DO NOT SCALE
Jacobs No.	B2140002
BIM No.	A9P02-JAC-EHR-D_ZZZZZ_ZZ-FG-EN-0001
Drawing number	Figure 9.1b
Rev	P03

© Crown copyright 2025. You may re-use this information (excluding logos) free of charge in any format or medium, under the terms of the Open Government Licence. To view this licence, visit <http://www.nationalarchives.gov.uk/doc/open-government-licence/> or e-mail: psi@nationalarchives.gsi.gov.uk. Where we have identified any third party copyright information you will need to obtain permission from the copyright holders concerned. Limitation: This drawing has been prepared on behalf of, and for the exclusive use of Jacobs' Client, and is subject to, and issued in accordance with, the provisions of the contract between Jacobs and the Client. Jacobs accepts no liability or responsibility whatsoever for, or in respect of, any use of, or reliance upon, this drawing by any third party.



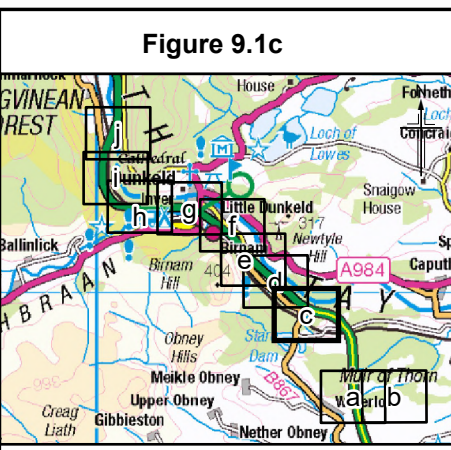
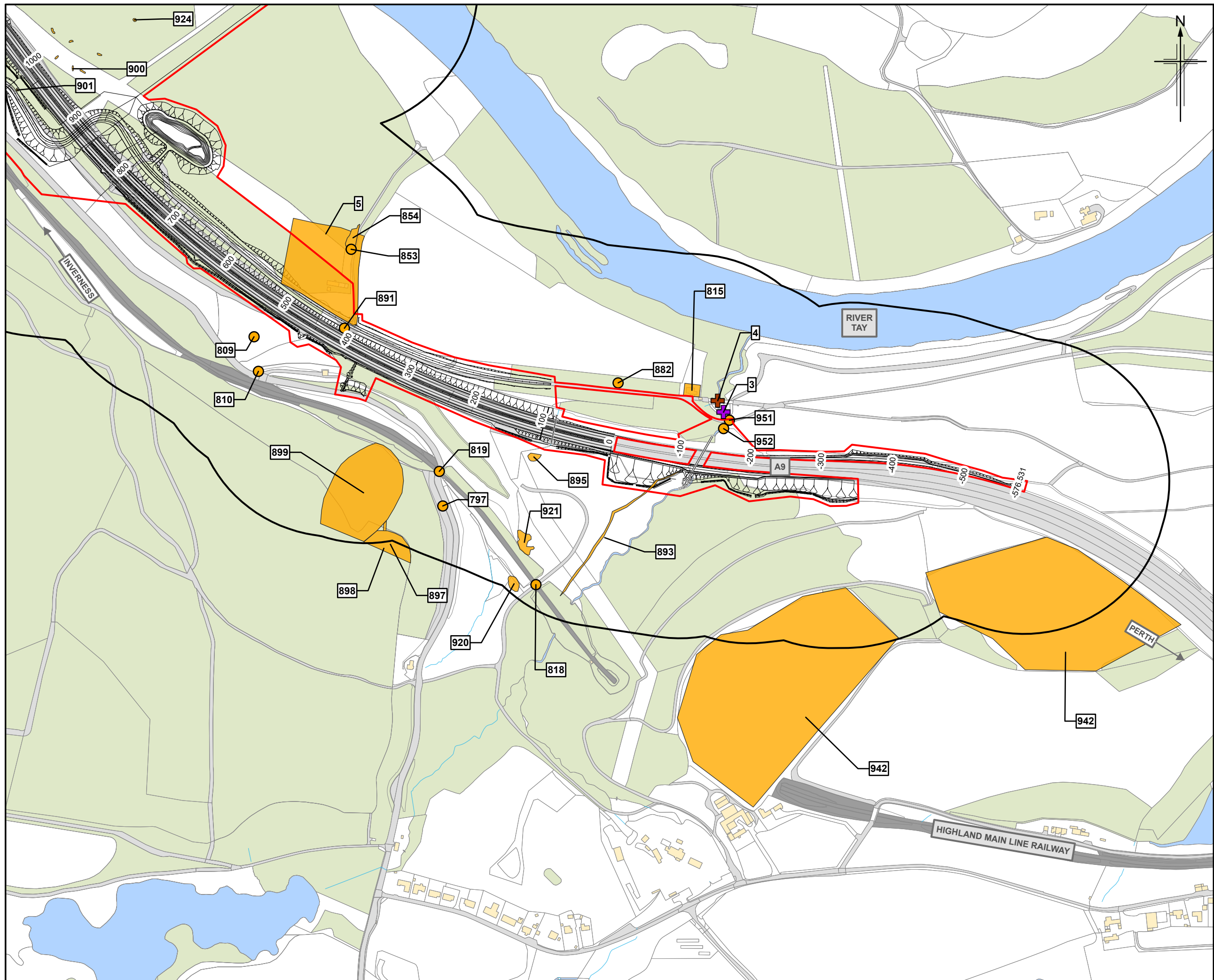

- Legend**
- Proposed scheme (DMRB Stage 3)
 - SuDS
 - Boundaries of the Site
 - 200m Study Area
 - Category A Listed Building
 - Category B Listed Building
 - Category C Listed Building
 - Conservation Area
 - Scheduled Monument
 - Undesignated archaeological remains and historic buildings

P03	MAY 2025	For Stage Approval	MM	JD	GK	EM
Rev.	Rev. Date	Purpose of revision	Orig/Dwn	Checkd	Rev'd	Apprv'd

Jacobs
95 Botolph Claydon, Gt. Thox, UK.
Tel: +44(0)1473 243 8000
www.jacobs.com

Client
TRANSPORT SCOTLAND
Còmhaid Alba

Project
A9 DUALLING
TAY CROSSING TO BALLINLUIG

Drawing title
Archaeological Remains and Historic Buildings

Sheet 3 of 10			
Drawing Status	S4 – For Stage Approval		
Scale	1:5,000	@ A3	DO NOT SCALE
Jacobs No.	B2140002		
BIM No.	A9P02-JAC-EHR-D_ZZZZZ_ZZ-FG-EN-0001		
Drawing number	Figure 9.1c		Rev P03

© Crown copyright 2025. You may re-use this information (excluding logos) free of charge in any format or medium, under the terms of the Open Government Licence. To view this licence, visit <http://www.nationalarchives.gov.uk/doc/open-government-licence/> or e-mail: psi@nationalarchives.gsi.gov.uk. Where we have identified any third party copyright information you will need to obtain permission from the copyright holders concerned. Limitation: This drawing has been prepared on behalf of, and for the exclusive use of Jacobs' Client, and is subject to, and issued in accordance with, the provisions of the contract between Jacobs and the Client. Jacobs accepts no liability or responsibility whatsoever for, or in respect of, any use of, or reliance upon, this drawing by any third party.

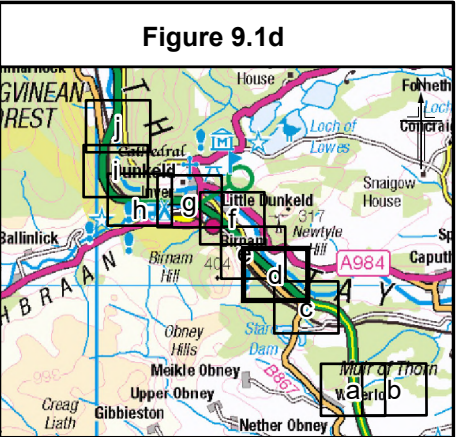
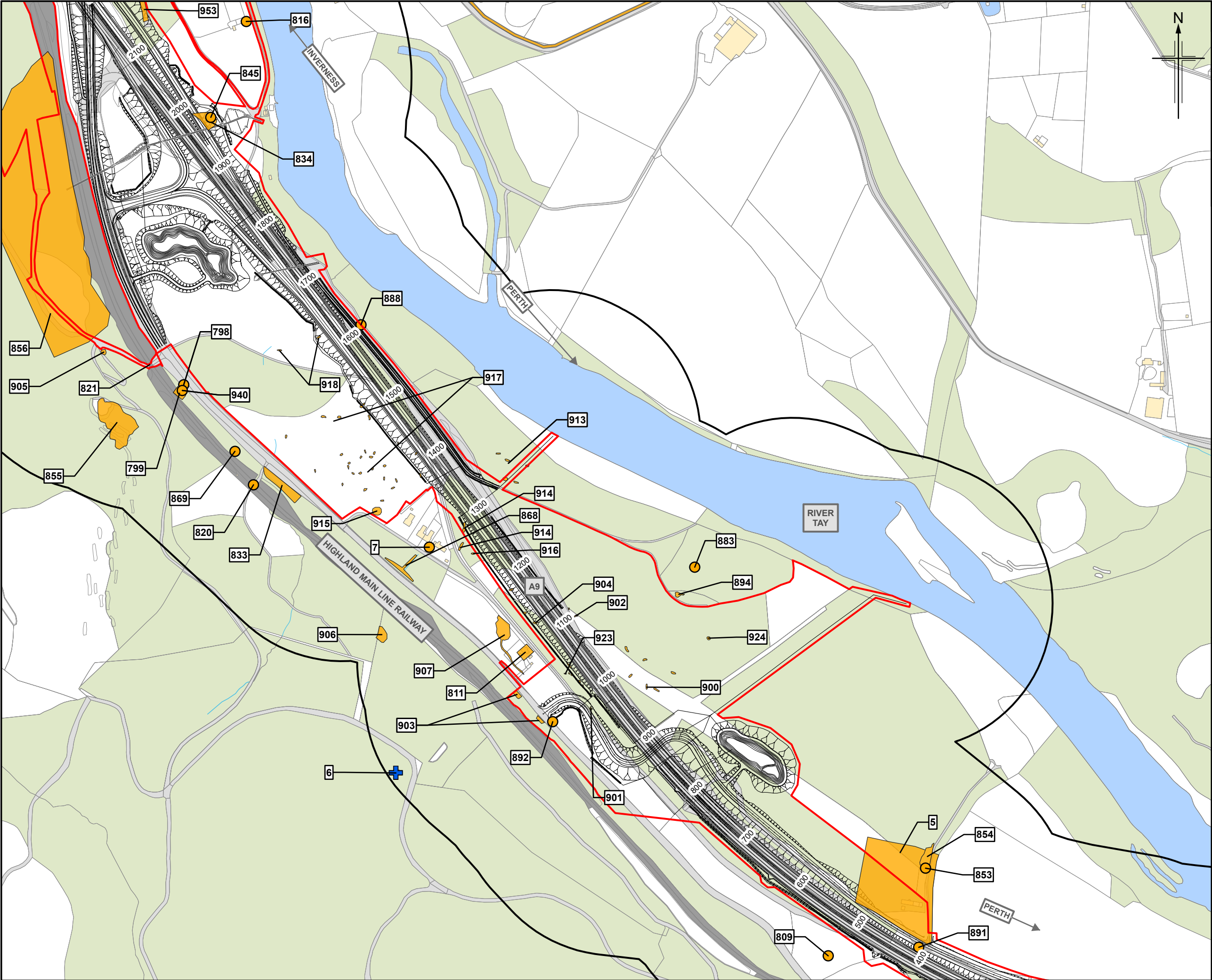

- Legend**
- Proposed scheme (DMRB Stage 3)
 - SuDS
 - Boundaries of the Site
 - 200m Study Area
 - Category A Listed Building
 - Category B Listed Building
 - Category C Listed Building
 - Conservation Area
 - Scheduled Monument
 - Undesignated archaeological remains and historic buildings

P03	MAY 2025	For Stage Approval	MM	JD	GK	EM
Rev.	Rev. Date	Purpose of revision	Orig/Dwn	Checked	Rev'd	Apprv'd

Jacobs
95 Bothwell Street, Glasgow G2 7HX, UK.
Tel: +44(0)141 243 8000
www.jacobs.com



Archaeological Remains and Historic Buildings

Sheet 4 of 10

Drawing Status	S4 – For Stage Approval
Scale	1:5,000 @ A3 DO NOT SCALE
Jacobs No.	B2140002
BIM No.	A9P02-JAC-EHR-D_ZZZZZ_ZZ-FG-EN-0001
Drawing number	Figure 9.1d
Rev	P03

© Crown copyright 2025. You may re-use this information (excluding logos) free of charge in any format or medium, under the terms of the Open Government Licence. To view this licence, visit <http://www.nationalarchives.gov.uk/doc/open-government-licence/> or e-mail: psi@nationalarchives.gsi.gov.uk. Where we have identified any third party copyright information you will need to obtain permission from the copyright holders concerned. Limitation: This drawing has been prepared on behalf of, and for the exclusive use of Jacobs' Client, and is subject to, and issued in accordance with, the provisions of the contract between Jacobs and the Client. Jacobs accepts no liability or responsibility whatsoever for, or in respect of, any use of, or reliance upon, this drawing by any third party.

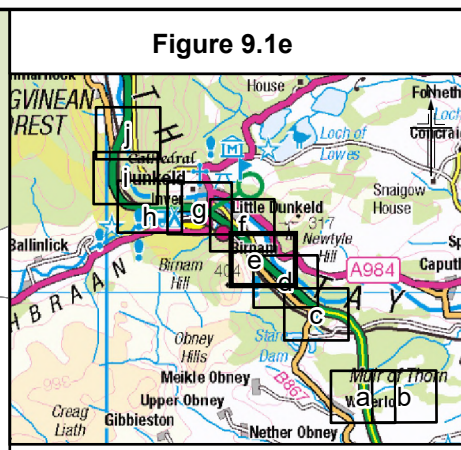
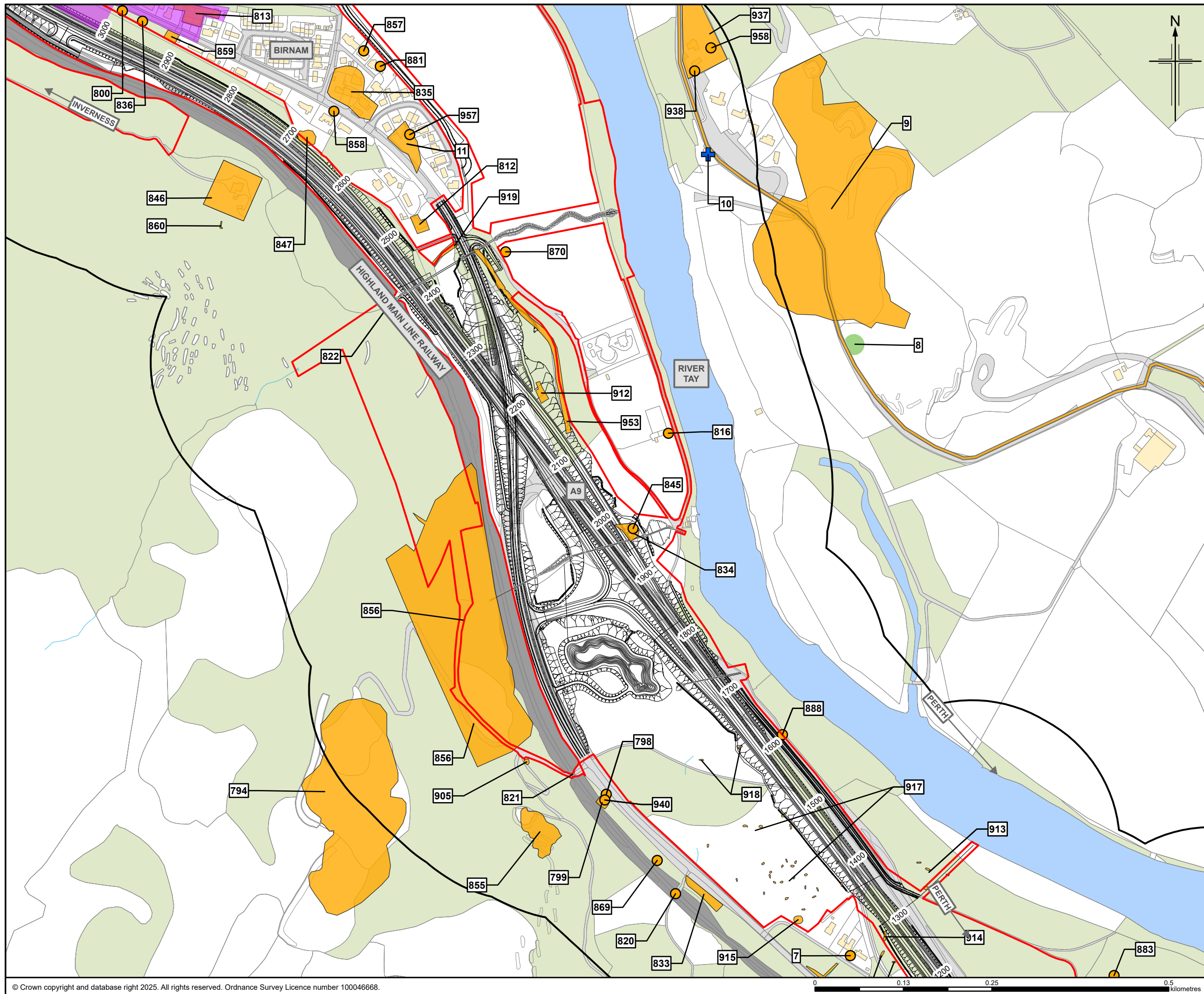

- Legend**
- Proposed scheme (DMRB Stage 3)
 - SuDS
 - Boundaries of the Site
 - 200m Study Area
 - Category A Listed Building
 - Category B Listed Building
 - Category C Listed Building
 - Conservation Area
 - Scheduled Monument
 - Undesignated archaeological remains and historic buildings

P03	MAY 2025	For Stage Approval	MM	JD	GK	EM
Rev.	Rev. Date	Purpose of revision	Orig/Dwn	Checkd	Rev'd	Apprv'd

Jacobs
95 Bothwell Street, Glasgow, G2 7HX, UK.
Tel: +44(0)141 243 8000
www.jacobs.com

Client

TRANSPORT SCOTLAND
CÒRRAIDHAIL ALBA

Project

A9 DUALLING
TAY CROSSING TO BALLINLUIG

Drawing title
Archaeological Remains and Historic Buildings

Sheet 5 of 10			
Drawing Status	S4 – For Stage Approval		
Scale	1:5,000	@ A3	DO NOT SCALE
Jacobs No.	B2140002		
BIM No.	A9P02-JAC-EHR-D_ZZZZZ_ZZ-FG-EN-0001		
Drawing number	Figure 9.1e		Rev P03

© Crown copyright 2025. You may re-use this information (excluding logos) free of charge in any format or medium, under the terms of the Open Government Licence. To view this licence, visit <http://www.nationalarchives.gov.uk/doc/open-government-licence/> or e-mail: psi@nationalarchives.gsi.gov.uk. Where we have identified any third party copyright information you will need to obtain permission from the copyright holders concerned. Limitation: This drawing has been prepared on behalf of, and for the exclusive use of Jacobs' Client, and is subject to, and issued in accordance with, the provisions of the contract between Jacobs and the Client. Jacobs accepts no liability or responsibility whatsoever for, or in respect of, any use of, or reliance upon, this drawing by any third party.

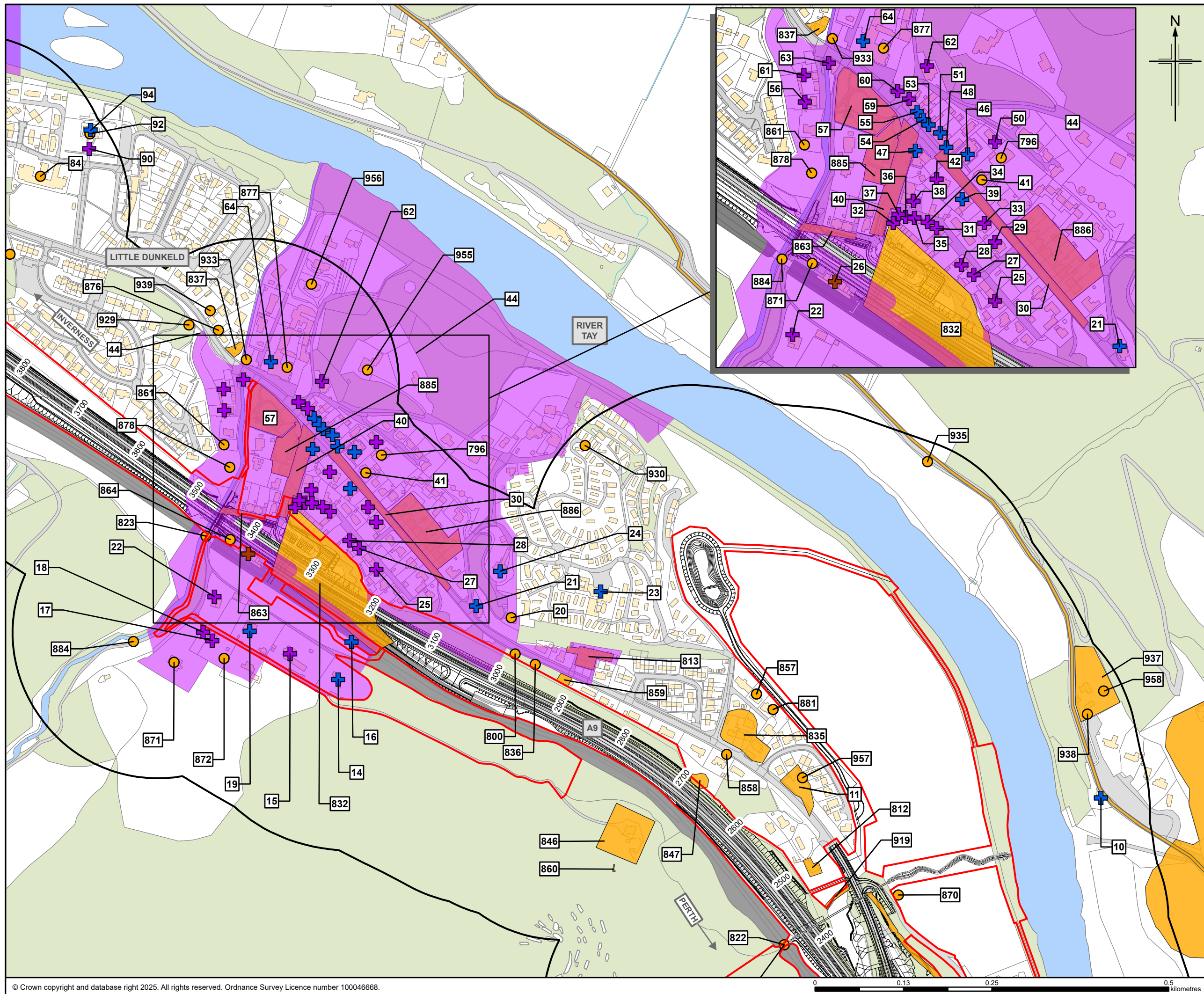

Figure 9.1f

Legend
Proposed scheme (DMRB Stage 3)
SuDS
Boundaries of the Site
200m Study Area
Category A Listed Building
Category B Listed Building
Category C Listed Building
Conservation Area
Scheduled Monument
Undesignated archaeological remains and historic buildings

P03	MAY 2025	For Stage Approval	MM	JD	GK	EM
Rev.	Rev. Date	Purpose of revision	Orig/Dwn	Checked	Rev'd	Apprv'd

Jacobs
95 Botolph Claydon, Norfolk, UK
Tel: +44(0)1473 243 8000
www.jacobs.com

TRANSPORT SCOTLAND
COMHAIL ALBA

A9 DUALLING
TAY CROSSING TO BALLINLUIG

Archaeological Remains and Historic Buildings

Sheet 6 of 10

Drawing Status	S4 – For Stage Approval
Scale	1:5,000 @ A3 DO NOT SCALE
Jacobs No.	B2140002
BIM No.	A9P02-JAC-EHR-D_ZZZZZ_ZZ-FG-EN-0001
Drawing number	Figure 9.1f
Rev	P03

© Crown copyright 2025. You may re-use this information (excluding logos) free of charge in any format or medium, under the terms of the Open Government Licence. To view this licence, visit <http://www.nationalarchives.gov.uk/doc/open-government-licence/> or e-mail: psi@nationalarchives.gsi.gov.uk. Where we have identified any third party copyright information you will need to obtain permission from the copyright holders concerned. Limitation: This drawing has been prepared on behalf of, and for the exclusive use of Jacobs' Client, and is subject to, and issued in accordance with, the provisions of the contract between Jacobs and the Client. Jacobs accepts no liability or responsibility whatsoever for, or in respect of, any use of, or reliance upon, this drawing by any third party.

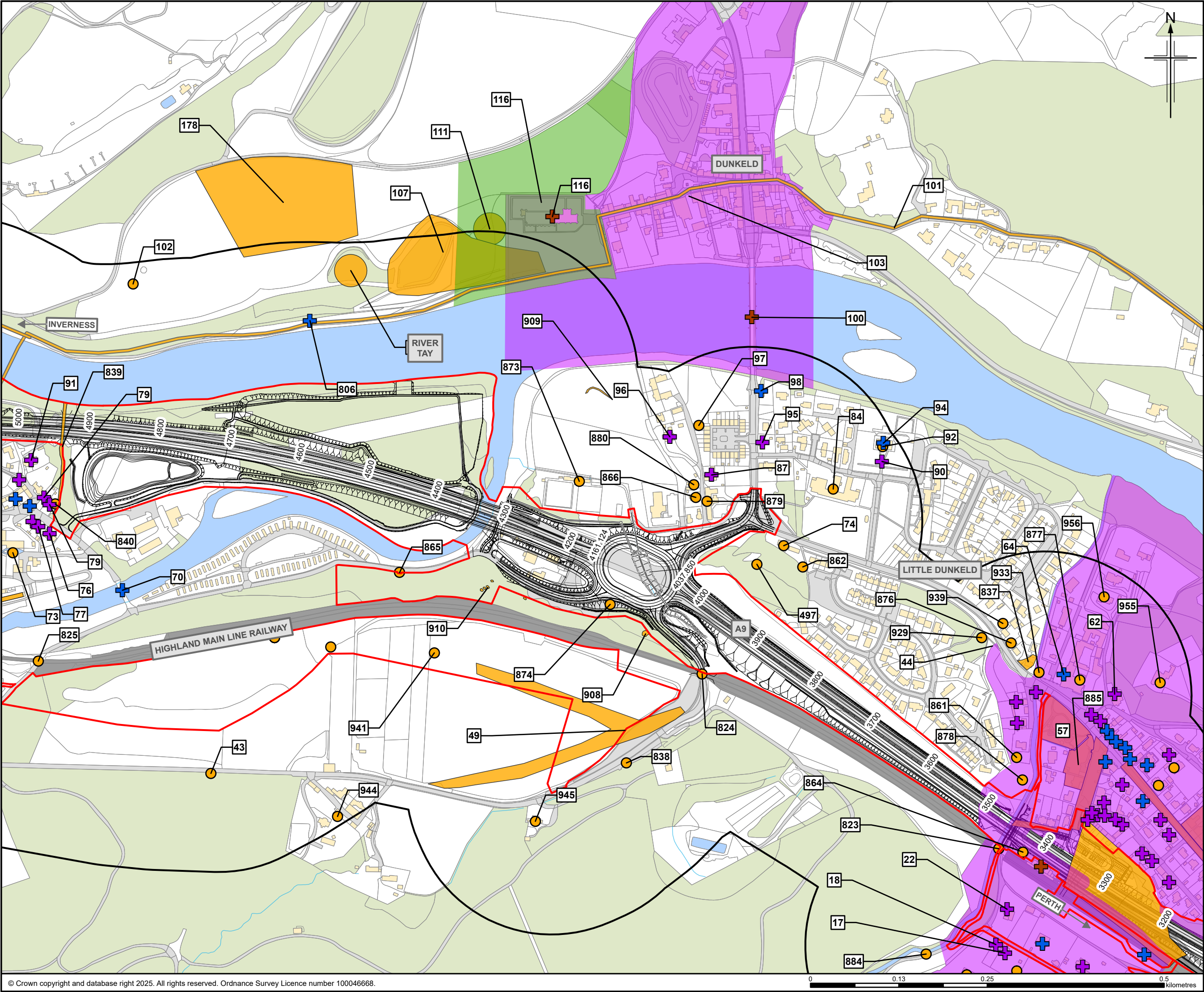

Figure 9.1g

Legend

- Proposed scheme (DMRB Stage 3)
- SuDS
- Boundaries of the Site
- 200m Study Area
- Category A Listed Building
- Category B Listed Building
- Category C Listed Building
- Conservation Area
- Scheduled Monument
- Undesignated archaeological remains and historic buildings

P03	MAY 2025	For Stage Approval	MM	JD	GK	EM
Rev.	Rev. Date	Purpose of revision	Orig/Dwn	Checked	Rev'd	Appr'd

Jacobs
95 Botwell Street, Glasgow G2 7HX, UK.
Tel: +44(0)141 243 8000
www.jacobs.com

Client

Project

Drawing title
Archaeological Remains and Historic Buildings

Sheet 7 of 10

Drawing Status	S4 – For Stage Approval
Scale	1:5,000 @ A3 DO NOT SCALE
Jacobs No.	B2140002
BIM No.	A9P02-JAC-EHR-D_ZZZZZ_ZZ-FG-EN-0001
Drawing number	Figure 9.1g
Rev	P03

© Crown copyright 2025. You may re-use this information (excluding logos) free of charge in any format or medium, under the terms of the Open Government Licence. To view this licence, visit <http://www.nationalarchives.gov.uk/doc/open-government-licence/> or e-mail: psi@nationalarchives.gsi.gov.uk. Where we have identified any third party copyright information you will need to obtain permission from the copyright holders concerned. Limitation: This drawing has been prepared on behalf of, and for the exclusive use of Jacobs' Client, and is subject to, and issued in accordance with, the provisions of the contract between Jacobs and the Client. Jacobs accepts no liability or responsibility whatsoever for, or in respect of, any use of, or reliance upon, this drawing by any third party.

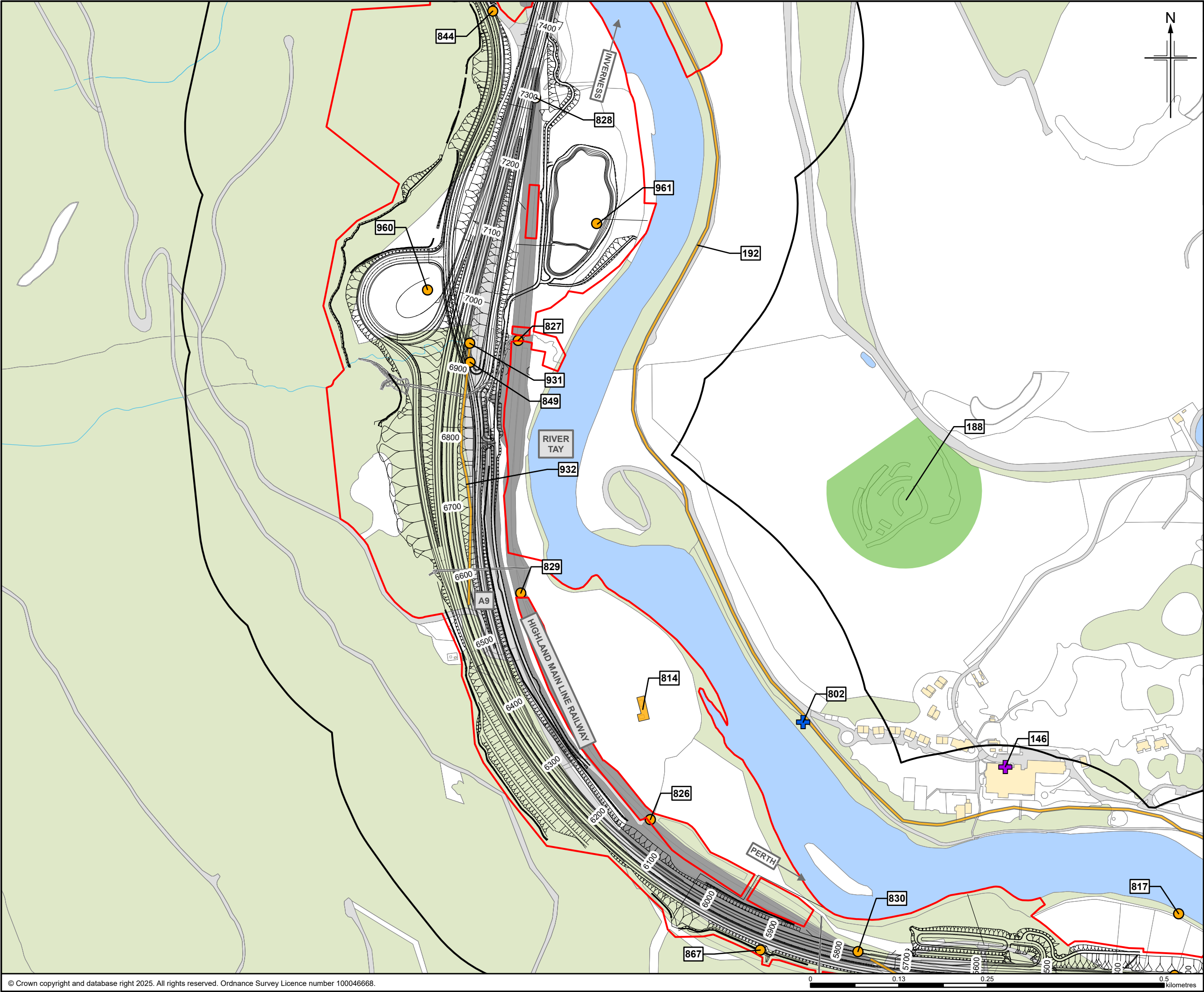

Figure 9.1i

Legend

- Proposed scheme (DMRB Stage 3)
- SuDS
- Boundaries of the Site
- 200m Study Area
- Category A Listed Building
- Category B Listed Building
- Category C Listed Building
- Conservation Area
- Scheduled Monument
- Undesignated archaeological remains and historic buildings

P03	MAY 2025	For Stage Approval	MM	JD	GK	EM
Rev.	Rev. Date	Purpose of revision	Orig/Dwn	Checkd	Rev'd	Apprv'd

Jacobs

95 Bothwell Street, Glasgow G2 7HX, UK.
Tel: +44(0)141 243 8000
www.jacobs.com

Client

TRANSPORT SCOTLAND
CÒRMDHAIL ALBA

Project

A9 DUALLING
TAY CROSSING TO BALLINLUIG

Drawing title

Archaeological Remains and Historic Buildings

Sheet 9 of 10

Drawing Status	S4 – For Stage Approval
Scale	1:5,000 @ A3 DO NOT SCALE
Jacobs No.	B2140002
BIM No.	A9P02-JAC-EHR-D_ZZZZZ_ZZ-FG-EN-0001
Drawing number	Figure 9.1i
Rev	P03

© Crown copyright 2025. You may re-use this information (excluding logos) free of charge in any format or medium, under the terms of the Open Government Licence. To view this licence, visit <http://www.nationalarchives.gov.uk/doc/open-government-licence/> or e-mail: psi@nationalarchives.gsi.gov.uk. Where we have identified any third party copyright information you will need to obtain permission from the copyright holders concerned. Limitation: This drawing has been prepared on behalf of, and for the exclusive use of Jacobs' Client, and is subject to, and issued in accordance with, the provisions of the contract between Jacobs and the Client. Jacobs accepts no liability or responsibility whatsoever for, or in respect of, any use of, or reliance upon, this drawing by any third party.

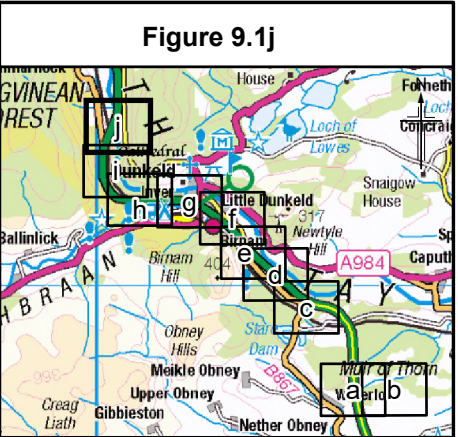
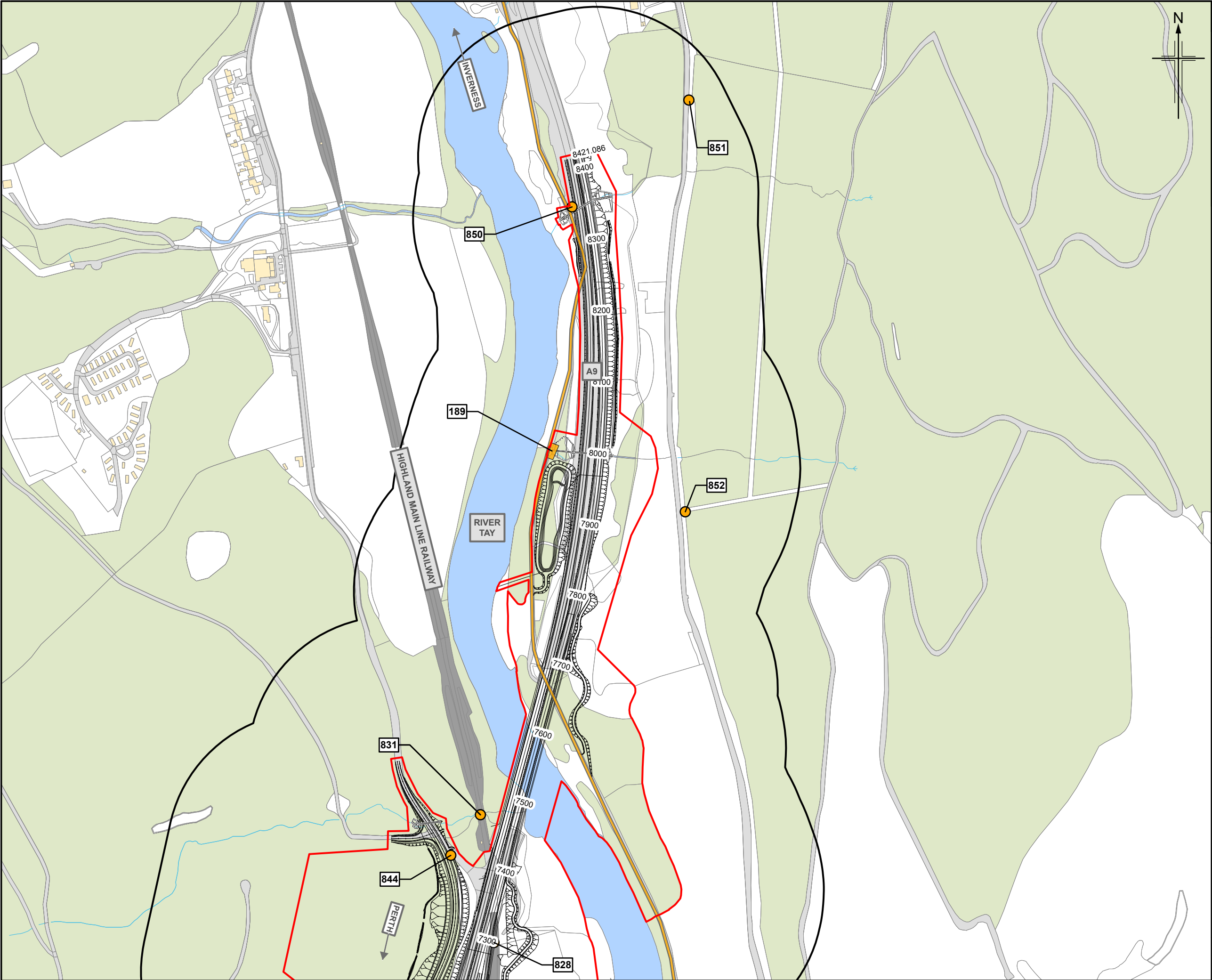

Legend

- Proposed scheme (DMRB Stage 3)
- SuDS
- Boundaries of the Site
- 200m Study Area
- Category A Listed Building
- Category B Listed Building
- Category C Listed Building
- Conservation Area
- Scheduled Monument
- Undesignated archaeological remains and historic buildings

P03	MAY 2025	For Stage Approval	MM	JD	GK	EM
Rev.	Rev. Date	Purpose of revision	Orig/Dwn	Checked	Rev'd	Apprv'd

Jacobs
95 Bothwell Street, Glasgow G2 7HX, UK.
Tel: +44(0)141 243 8000
www.jacobs.com

Client
TRANSPORT SCOTLAND
CÒRRAIDHAIL ALBA

Project
A9 DUALLING
TAY CROSSING TO BALLINLUIG

Drawing title
Archaeological Remains and Historic Buildings

Sheet 10 of 10

Drawing Status	S4 – For Stage Approval	
Scale	1:5,000 @ A3	DO NOT SCALE
Jacobs No.	B2140002	
BIM No.	A9P02-JAC-EHR-D_ZZZZZ_ZZ-FG-EN-0001	
Drawing number	Figure 9.1j	Rev P03