

Figure 19.1a

Legend

- Proposed scheme (DMRB Stage 3)
- SuDS
- 500m Study Area
- Watercourses

SEPA WFD 2023 Classification Status

- High
- Good
- Moderate
- Poor
- Bad
- Maximum ecological potential (heavily modified)
- Good ecological potential (heavily modified)
- Moderate ecological potential (heavily modified)
- Poor ecological potential (heavily modified)
- Bad ecological potential (heavily modified)

| | | | | | | |
|------|-----------|---------------------|----------|---------|-------|---------|
| P03 | MAY 2025 | For Stage Approval | PM | AP | GK | EM |
| Rev. | Rev. Date | Purpose of revision | Orig/Dwn | Checked | Rev'd | Apprv'd |

Jacobs

95 Bothwell Street, Glasgow, G2 7HX, UK.
Tel: +44(0)141 243 8000
www.jacobs.com

Client

TRANSPORT SCOTLAND
COMHAIL ALBA

Project

A9 DUALLING
PASS OF BIRNAM TO TAY CROSSING

Drawing title

Environmental Impact Assessment Report
Surface Water Features

Sheet 1 of 4

| | | |
|----------------|-------------------------------------|--------------|
| Drawing Status | S4 – For Stage Approval | |
| Scale | 1:10,000 @ A3 | DO NOT SCALE |
| Jacobs No. | B2140002 | |
| BIM No. | A9P02-JAC-EGT-D_ZZZZZ_ZZ-FG-EN-0001 | |
| Drawing number | Figure 19.1a | Rev P03 |

© Crown copyright 2025. You may re-use this information (excluding logos) free of charge in any format or medium, under the terms of the Open Government Licence. To view this licence, visit <http://www.nationalarchives.gov.uk/doc/open-government-licence/> or e-mail: psi@nationalarchives.gsi.gov.uk. Where we have identified any third party copyright information you will need to obtain permission from the copyright holders concerned.

Limitation: This drawing has been prepared on behalf of, and for the exclusive use of Jacobs' Client, and is subject to, and issued in accordance with, the provisions of the contract between Jacobs and the Client. Jacobs accepts no liability or responsibility whatsoever for, or in respect of, any use of, or reliance upon, this drawing by any third party.

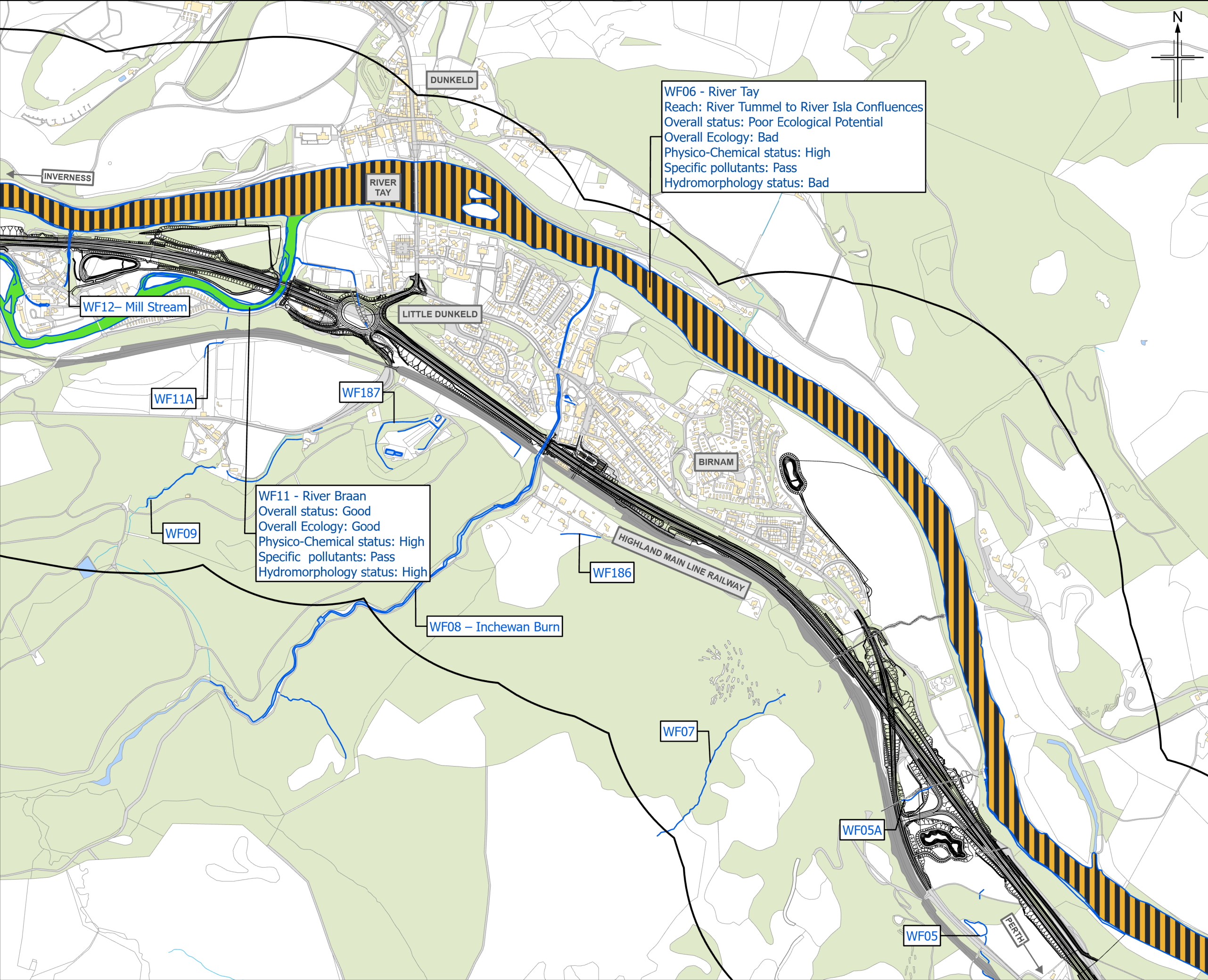

Figure 19.1b

Legend

- Proposed scheme (DMRB Stage 3)
- SuDS
- 500m Study Area
- Watercourses

SEPA WFD 2023 Classification Status

- High
- Good
- Moderate
- Poor
- Bad

Ecological Potential Status

- Maximum ecological potential (heavily modified)
- Good ecological potential (heavily modified)
- Moderate ecological potential (heavily modified)
- Poor ecological potential (heavily modified)
- Bad ecological potential (heavily modified)

| | | | | | | |
|------|-----------|---------------------|----------|--------|-------|---------|
| P03 | MAY 2025 | For Stage Approval | PM | AP | GK | EM |
| Rev. | Rev. Date | Purpose of revision | Orig/Dwn | Checkd | Rev'd | Apprv'd |

Jacobs
95 Bothwell Street, Glasgow G2 7HX, UK.
Tel: +44(0)141 243 8000
www.jacobs.com

Client
Transport Scotland
Còmhdaidh Alba

Project
A9 DUALING
PASS OF BIRNAM TO TAY CROSSING

Drawing title
Environmental Impact Assessment Report
Surface Water Features

Sheet 2 of 4

| | | |
|----------------|-------------------------------------|--------------|
| Drawing Status | S4 – For Stage Approval | |
| Scale | 1:10,000 @ A3 | DO NOT SCALE |
| Jacobs No. | B2140002 | |
| BIM No. | A9P02-JAC-EGT-D_ZZZZZ_ZZ-FG-EN-0001 | |
| Drawing number | Figure 19.1b | Rev P03 |

© Crown copyright 2025. You may re-use this information (excluding logos) free of charge in any format or medium, under the terms of the Open Government Licence. To view this licence, visit <http://www.nationalarchives.gov.uk/doc/open-government-licence/> or e-mail psi@nationalarchives.gsi.gov.uk. Where we have identified any third party copyright information you will need to obtain permission from the copyright holders concerned. Limitation: This drawing has been prepared on behalf of, and for the exclusive use of Jacobs' Client, and is subject to, and issued in accordance with, the provisions of the contract between Jacobs and the Client. Jacobs accepts no liability or responsibility whatsoever for, or in respect of, any use of, or reliance upon, this drawing by any third party.



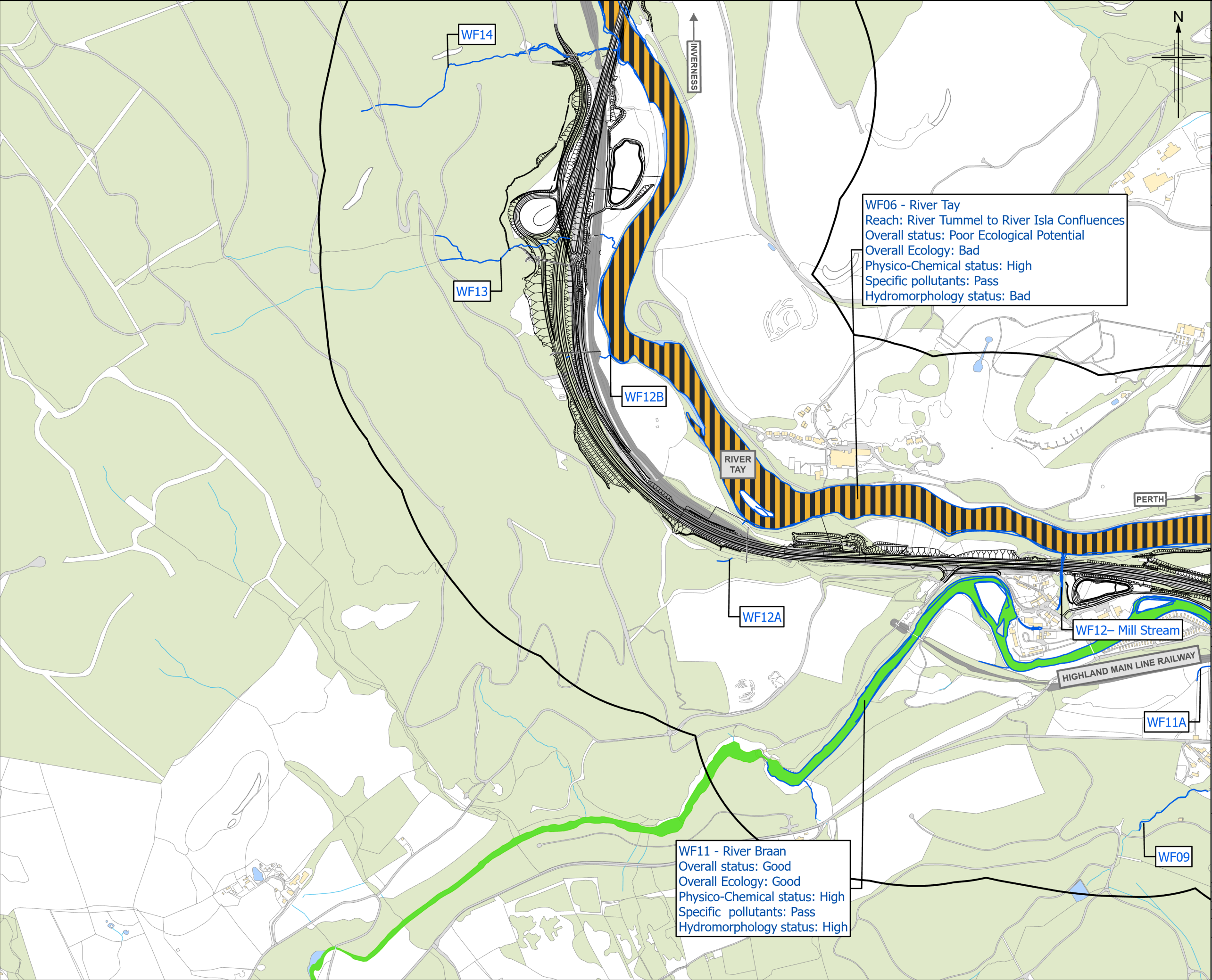

Figure 19.1c

Legend

- Proposed scheme (DMRB Stage 3)
- SuDS
- 500m Study Area
- Watercourses

SEPA WFD 2023 Classification Status

- High
- Good
- Moderate
- Poor
- Bad

Maximum ecological potential (heavily modified)

- Good ecological potential (heavily modified)
- Moderate ecological potential (heavily modified)
- Poor ecological potential (heavily modified)
- Bad ecological potential (heavily modified)

| | | | | | | |
|------|-----------|---------------------|----------|---------|-------|---------|
| P03 | MAY 2025 | For Stage Approval | PM | AP | GK | EM |
| Rev. | Rev. Date | Purpose of revision | Orig/Dwn | Checked | Rev'd | Apprv'd |

Jacobs
95 Bothwell Street, Glasgow G2 7HX, UK.
Tel: +44(0)141 243 8000
www.jacobs.com

Client

Transport Scotland
COIMHAIL ALBA

Project

A9 DUALING
PASS OF BIRNAM TO TAY CROSSING

Drawing title

Environmental Impact Assessment Report
Surface Water Features

Sheet 3 of 4

| | | |
|----------------|-------------------------------------|--------------|
| Drawing Status | S4 – For Stage Approval | |
| Scale | 1:10,000 @ A3 | DO NOT SCALE |
| Jacobs No. | B2140002 | |
| BIM No. | A9P02-JAC-EGT-D_ZZZZZ_ZZ-FG-EN-0001 | |
| Drawing number | Figure 19.1c | Rev P03 |

© Crown copyright 2025. You may re-use this information (excluding logos) free of charge in any format or medium, under the terms of the Open Government Licence. To view this licence, visit <http://www.nationalarchives.gov.uk/doc/open-government-licence/> or e-mail psi@nationalarchives.gsi.gov.uk. Where we have identified any third party copyright information you will need to obtain permission from the copyright holders concerned. Limitation: This drawing has been prepared on behalf of, and for the exclusive use of Jacobs' Client, and is subject to, and issued in accordance with, the provisions of the contract between Jacobs and the Client. Jacobs accepts no liability or responsibility whatsoever for, or in respect of, any use of, or reliance upon, this drawing by any third party.

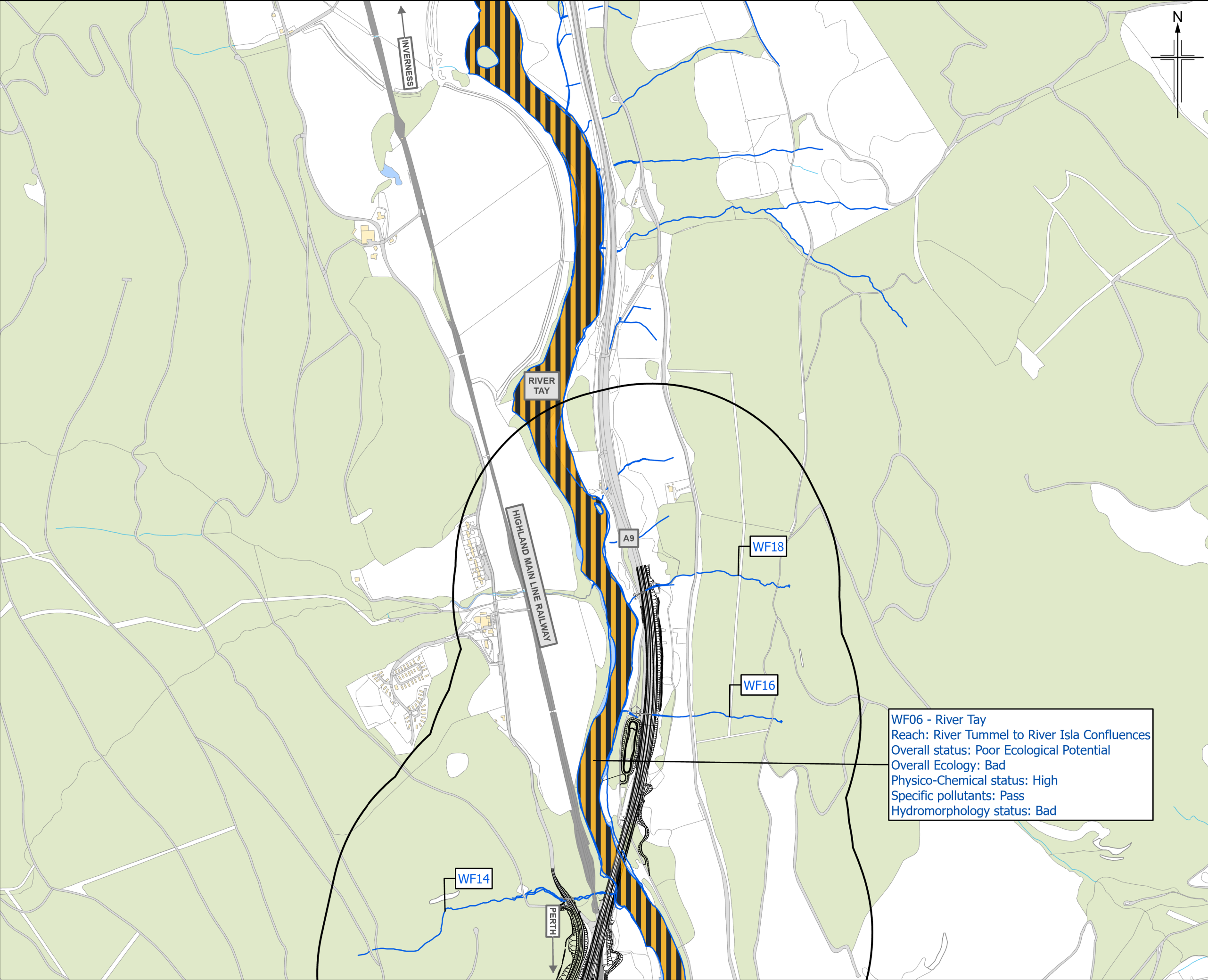

Figure 19.1d

Legend

- Proposed scheme (DMRB Stage 3)
- SuDS
- 500m Study Area
- Watercourses

SEPA WFD 2023 Classification Status

- High
- Good
- Moderate
- Poor
- Bad

Ecological Potential

- Maximum ecological potential (heavily modified)
- Good ecological potential (heavily modified)
- Moderate ecological potential (heavily modified)
- Poor ecological potential (heavily modified)
- Bad ecological potential (heavily modified)

| | | | | | | |
|------|-----------|---------------------|----------|---------|-------|---------|
| P03 | MAY 2025 | For Stage Approval | PM | AP | GK | EM |
| Rev. | Rev. Date | Purpose of revision | Orig/Dwn | Checked | Rev'd | Apprv'd |

Jacobs

95 Bothwell Street, Glasgow, G2 7HX, UK.
Tel: +44(0)141 243 8000
www.jacobs.com

Client

TRANSPORT SCOTLAND
COIMHDAIL ALBA

Project

A9 DUALING
PASS OF BIRNAM TO TAY CROSSING

Drawing title

Environmental Impact Assessment Report
Surface Water Features

Sheet 4 of 4

| | | |
|----------------|-------------------------------------|--------------|
| Drawing Status | S4 – For Stage Approval | |
| Scale | 1:10,000 @ A3 | DO NOT SCALE |
| Jacobs No. | B2140002 | |
| BIM No. | A9P02-JAC-EGT-D_ZZZZZ_ZZ-FG-EN-0001 | |
| Drawing number | Figure 19.1d | Rev P03 |

© Crown copyright and database right 2025. You may re-use this information (excluding logos) free of charge in any format or medium, under the terms of the Open Government Licence. To view this licence, visit <http://www.nationalarchives.gov.uk/doc/open-government-licence/> or e-mail: psi@nationalarchives.gov.uk. Where we have identified any third party copyright information you will need to obtain permission from the copyright holders concerned.

Limitation: This drawing has been prepared on behalf of, and for the exclusive use of Jacobs' Client, and is subject to, and issued in accordance with, the provisions of the contract between Jacobs and the Client. Jacobs accepts no liability or responsibility whatsoever for, or in respect of, any use of, or reliance upon, this drawing by any third party.

